



AMERICAN
BAR SYSTEM
PERLICK DISTRIBUTOR

PHONE 0049 (0)231 108 77 99 0
americanbarsystem@t-online.de
www.americanbarsystem.de

BAR & BEVERAGE PRODUCT BOOK

REFRIGERATION, UNDERBAR EQUIPMENT,
AND BEVERAGE DISPENSING SYSTEMS



2024
PRODUCTS CATALOG

PRICING EFFECTIVE 02/05/2024.
Prices subject to change without notice.



perlick.com

Perlick®

QUALITY AND CRAFTSMANSHIP SINCE 1917

For the past 100+ years, Perlick has been a leading pioneer in the design, engineering, and manufacture of high-performance commercial bar and beverage equipment and premium residential refrigeration. That's why you'll find the Perlick badge proudly displayed in the best bars and restaurants, at the biggest sports and entertainment venues, and in the finest homes.



COVER & INSIDE PHOTO: POTOWATOMI ROCK & BREW, MILWAUKEE, WI

American Barsystems EK · Phone 0049 (0)231 108 77 99 0 · Fax 0049 (0)231 108 77 99
americanbarsystem@t-online.de · www.americanbarsystem.de · www.perlick.com

TABLE OF CONTENTS

UNDERBAR EQUIPMENT

Top Shelf Story.....	4
Bar Design Options.....	6
Modular Bar Systems.....	7
Pass-thru Stations.....	8
Underbar Cocktail Stations.....	10
Tobin Ellis Signature Series Cocktail Station.....	11-16
Tobin Ellis Signature Series Refrigerated Drawers.....	12
Tobin Ellis Signature Series Ice Vault and Ice Chests.....	13
Tobin Ellis Drainboards, Insulated Bottle Wells, Utility Sinks & Slanted Speed Racks.....	14-15
Tobin Ellis Signature Draft Cocktail System.....	16
Tobin Ellis Signature Series Limited Edition Mobile Bar.....	17
Tobin Ellis Signature Series Mobile Bars, Perlick Mobile Bars & Mobile Products.....	18-19
Perlick Mobile Tap.....	20

ICE CHESTS

Standard Ice Chests.....	21
Full Depth Ice Chests.....	22
Extra Capacity Ice Chests.....	23
Service Station.....	24
Drop-in Ice Chest.....	25
Ice Chest Accessories.....	25
Insulated Storage Chest.....	26
Ice Cream Center.....	26

SINKS & DRAINBOARDS

Soda Gun & Filler Sections.....	27
Perlick Drainboards & Equipment Stands.....	28-29
Blender Stations (with accessories).....	30
TSS Deck Assembly (with accessories).....	31
Bartender Prep Sinks (with accessories).....	32
Hand Sinks, Dump Sinks (with accessories).....	33
Touchless Faucets.....	33
Multi-tank Sinks.....	34
Multi-tank & Extra Capacity Sinks.....	35

STORAGE BINS & CABINETS

Storage Bins for Glassware.....	36-37
Storage Cabinets with Full Drainboard Top.....	37
Storage Cabinets with Sink & Waste Chute.....	37
Doors for Storage Cabinets.....	37
Liquor Step Cabinets & Glass Storage (with accessories).....	38
POS, Glass & Chemical Storage Cabinets.....	39

ADDITIONAL UNDERBAR ACCESSORIES

Liquor Display Cabinet.....	40
Underbar Beer Drainer.....	40
Trash Receptacles.....	41
Corner Filler Sections.....	42
Speed Rails.....	43
Drink Rail Drainers & Rinsers.....	44
Service Station Drop-in Drainers.....	44
Plumbing Accessories.....	45
Towel Rings.....	45
Leg Kits & Foot Inserts.....	45
Connector Kits.....	45
Wet Waste Pans.....	45
Side Splash Guards.....	45
Access Cutouts.....	46
Blender Platforms.....	46
Bottle Opener/Cap Receiver & Waste Receptacle.....	46

BACK BAR/REFRIGERATION

SELF-CONTAINED REFRIGERATED CABINETS

Single-Temp Zone (with accessories).....	48
Dual-Temp Zone (with accessories).....	50
Low-height Single Zone Cabinets (with accessories).....	52
Narrow Door (with accessories).....	54
Sliding Door (with accessories).....	56
Sliding Door Pass-thru (with accessories).....	57
Pass-thru (with accessories).....	58

REMOTE REFRIGERATED CABINETS

Single-Temp Zone (with accessories).....	60
Low-height Single-Zone Cabinets.....	62
Narrow Door (with accessories).....	64
Sliding Door (with accessories).....	66
Sliding Door Pass-thru (with accessories).....	67
Pass-thru (with accessories).....	68
Dispensing Kits for Back Bar Series Cabinets.....	70
Nitro Dispensing Kits for Back Bar Series.....	71

DRY STORAGE CABINETS

Standard Door (with accessories).....	72
Lighted Merchandise Displays.....	73
Narrow Door (with accessories).....	74
Direct Draw Beer Dispensers.....	76
Direct Draw Beer Dispensing Kits (DDS Series).....	78
Concessionaires & Beer Dispensing Kits.....	79
Back Bar Series Accessories.....	80

WINE COLUMN REFRIGERATION

Single & Dual Zone.....	81
-------------------------	----

COMMERCIAL UNDERCOUNTER

FRONT VENTING REFRIGERATION

24" & 48" Refrigerator/Chiller/Wine Reserve With Tapping Options.....	82
24" Single Door, 18" Shallow-Depth Refrigerator/Wine Reserve.....	85
24" ADA Height-Compliant Refrigerator/Freezer/Beverage Center/Wine Reserve.....	86
Glass Chillers & Accessories.....	87
Flat Top Bottle Coolers (Standard & Low-temp).....	88
Bottle Cooler Accessories.....	90
Glasswashers.....	91

MISCELLANEOUS

Century Remote Beer Systems.....	92
Century Factory Engineered Performance Guarantee.....	93
Terms & Conditions.....	95
Warranty Information.....	95
Find a Perlick Rep.....	99

Perlick Top Shelf underbar equipment has been the preferred choice of many professional bartenders because they know properly designed bars and reliable equipment allow them to be creative, efficient, and most importantly, profitable. Top Shelf products reflect Perlick's true passion for design, craftsmanship, and innovation.

When you select any underbar equipment from the Perlick TS Series, you'll find it lives up to its "Top Shelf" name and offers exceptional value. No matter if the shape of your bar is straight, curved, round, or square, Perlick's underbar equipment is fabricated to match the contours of your bar and surpass your expectations.

TS SERIES

- The Top Shelf heritage starts with our modular line of TS equipment that allows designers to showcase their creativity by designing extremely efficient work stations
- TS Series equipment has an overall depth of 18-9/16" and comes with a 6" high backsplash (4" high-optional)
- Sinks in the **TS Series** utilize backsplash-mounted water faucets



TS SERIES

TSD SERIES

- Except for the "deck" style backsplash, the **TSD Series** of Top Shelf Underbar is identical to the TS Series
- The "D" style backsplash has a flat deck added to the back of the equipment, which adds 5-7/16" to the overall depth
- Sinks in the TSD Series utilize deck-mounted water faucets
- The deck serves multiple purposes: TS equipment with an optional speed rail has an overall depth of 24" which matches the overall depth of TSD equipment
- This creates a flush equipment front surface to eliminate those dreaded "knee knockers"
- The TSD series also moves the rear equipment legs away from the die wall, allowing clearance for beverage lines and plumbing



TSD SERIES



TSF SERIES

- The **Top Shelf Full Depth Series** of underbar uses the same 6" high straight backsplash as the TS series
- It creates a full 24" deep underbar by using larger depth work surfaces
- The TSF Series underbar increases the volume of ice chests and the useable work surface of drainboards by 34 percent
- The TSF Series has the rear equipment legs away from the die wall to allow ample room for routing plumbing and mechanicals

**TSS SERIES**

- An abundance of Top Shelf modules can be configured to create a multitude of unique service stations
- The **TSS Series** uses a 3" flat deck to connect back-to-back underbar modules
- These factory assembled sections create a highly efficient station so your bartenders and servers can work as a team
- TSS equipment depth can range from 38-3/16" to 49-1/16" depending on the equipment selected

**PTS SERIES**

- In addition to 38" deep TSS Service Station modules, the **PTS Series** offers pre-configured 32" deep pass-thru stations, which makes choosing the ultimate cocktail station a snap
- PTS Series stations are intended to be used in an open area of the bar and offer uninterrupted work surfaces for your bartenders and servers
- PTS service stations can range from 32" to 42-3/4" deep depending on the equipment selected



WHICH BAR DESIGN LAYOUT IS RIGHT FOR YOU?

MODULAR BAR

- If your project is new construction or a complete remodel and there is no existing bar or die wall, then a **Perlick Modular Bar** is your ultimate factory assembled solution to save both time and money.
- The Perlick Modular Bar structure includes a heavy gauge frame that creates the die wall and the equipment supports for your underbar lineup. The complete bar interior from top to bottom is furnished in stainless steel to create a smooth finished appearance. All plumbing and electrical chases are built into the structure and removable bar front panels (supplied by others) provide easy, lift-off access to service utilities and beverage lines.
- No matter if your bar is straight, round, or curved, every underbar module can be factory assembled in modular bar sections up to 8-1/2 ft. long. The Perlick Modular Bar gives you the assurance that every piece of the puzzle fits.

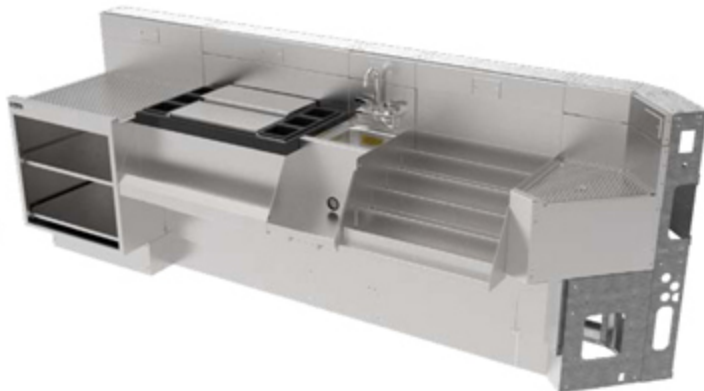

FACTORY ASSEMBLED UNDERBAR*

- When a bar die wall already exists or is being built by others, the Perlick factory can preassemble many of our underbar modules, per the bar drawing, into straight sections up to 8-1/2 ft. long.
- These straight sections eliminate field connections and save time. Pre-assembled sections that share a common front apron also share a common backsplash to give your bar a smooth, custom appearance.
- The factory determines the appropriate number of legs required for each pre-assembled section to give your bar the professional and uncluttered look you demand.

****Contact your Perlick representative to configure pre-assembled sections.***



FREESTANDING UNDERBAR

- Freestanding underbar modules are built and shipped as individual pieces with their own backsplashes and front aprons.
- Each module ships with a complete set of legs.
- Freestanding units give you complete control to make last-minute design changes or respond to unforeseen obstacles at the job site.



WARNING: California Prop 65 Notice

These products may expose you to chemicals including Chromium, which are known to the state of California to cause cancer and birth defects or other reproductive harm. For more information on whether a product in this list contains these chemicals, please refer to the specific product page at perlick.com. Or to find out more about Prop 65, go to P65Warnings.ca.gov.





Typical modular bar section
(Underbar equipment not shown. Order separately)



Typical modular bar void section

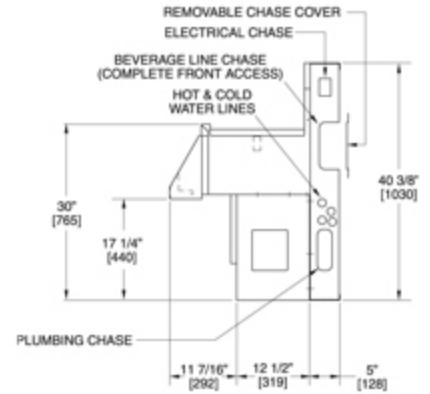

PEDESTAL BASE END VIEW

MODULAR BAR FEATURES:

- Pre-engineered sections up to 8-1/2 ft. ensure exact fit, eliminating on-site adjustments
- All metal construction conceals beverage and utility lines
- Interior finish panel is adjustable for sealing to the floor
- Set-in-place beverage line chase eliminates damage to insulated beverage lines
- Bar front panels are easily removed for quick access to all utilities and beverage lines
- Bar top and front panels can be prefabricated to reduce on-site millwork costs
- Faucets and drain sockets are factory installed
- Optional electrical outlets, fluorescent lights, and LED lights available

A MODULAR BAR SECTION IS PRICED USING MBS UNITS

STRAIGHT SECTIONS

- Each 6" width equals (1) MBS unit
- Example: 48" of Modular Bar structure equals (8) MBS units

CORNER SECTIONS

- 90° corner sections are priced using (8) MBS units
- 60° and 75° corner sections are priced using (4) MBS units
- 30° and 45° corner sections are priced using (2) MBS units
- 5°, 10°, 15°, 20° and 25° corner sections are priced using (1) MBS unit

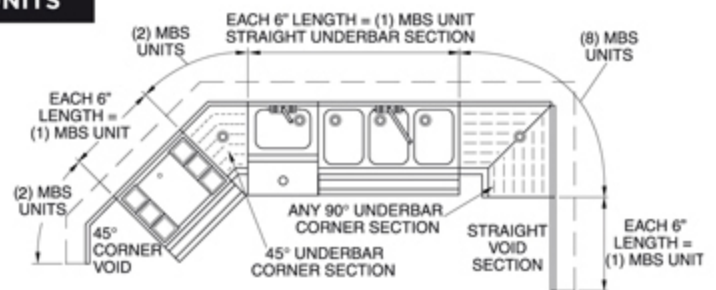

Part No	Description	Ship Wt. (lbs)	
MBS	6" bar structure section	10	260.00 per 6"

An upcharge for non-standard heights applies. Please contact factory for pricing.

Accessories

Part No	Description
MBS-LED-CW	LED accent light kit, cool white, 24Vdc. 2.5w
MBS-LED-PS40	Power supply for up to 12 LED lights, converts 120Vac to 24Vdc, 40w Max
MBS-ERCL	Mini fluorescent light kit, 120Vac, 3.5w, 2 prong plug
MBS-EC	Junction box with S.S. duplex cover
MBS-EC-G	Gasket, duplex outlet, weatherproof, bag of 2
MBS-MT	Full size footprint template (printed on durable film/per ft.)
57420	Millwork panel clip, 3/4" offset, 24 pieces

Note: Modular Bar systems are custom made and cannot be returned for credit.

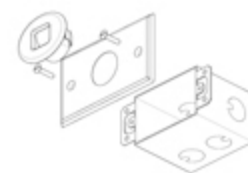

MBS-LED-CW
(LED light, junction box, and cover)

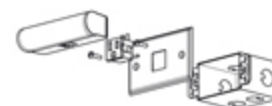

MBS-ERCL
(Mini light, junction box, receptacle, and cover)

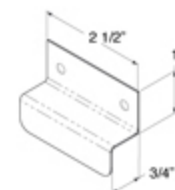

57420
(Millwork panel clip)



AMERICAN
BAR SYSTEM
PERLICK DISTRIBUTOR

American Barsystems EK · Phone 0049 (0)231 108 77 99 0 · Fax 0049 (0)231 108 77 99
americanbarsystem@t-online.de · www.americanbarsystem.de · www.perlick.com

UNDERBAR COCKTAIL STATIONS

(Not applicable on Modular Bar)

BARTENDER COCKTAIL STATIONS

Perlick's pre-built cocktail stations are designed to give you all the functionality a bartender needs at arm's width for more efficient drink building. Various sizes and configurations are available to fit your specific needs.

All units include the following accessories:

- Ice chest with 10 circuit cold plate
- Bottle rail (full width of ice chest)
- Bottle wells and covers for ice chest
- Condiment cup rack
- Backsplash cut-out for soda lines (located on left end of ice chest)
- End splash (located between ice chest and blender)
- Towel ring (located on blender)



UCS60A

48" COCKTAIL STATIONS

TS Series

Part No.	Width	Ship Wt. (lbs.)	List Price
UCS48A-LF	48"	250	8,670.00
UCS48B-LF	48"	250	8,625.00

60" COCKTAIL STATIONS

TS Series

Part No.	Width	Ship Wt. (lbs.)	List Price
UCS60A-LF	60"	270	9,195.00
UCS60B-LF	60"	280	9,965.00



UCS48A

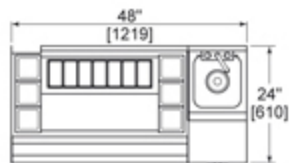

UCS48A-LF

- 36" Ice chest
- 12" Blender with sink and lead-free faucet

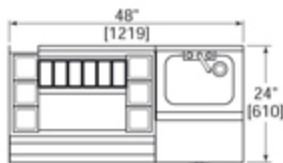

UCS48B-LF

- 30" Ice chest
- 18" Blender with sink and lead-free faucet

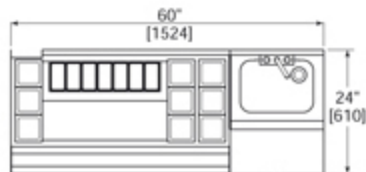

UCS60A-LF

- 42" Ice chest
- 18" Blender with sink and lead-free faucet

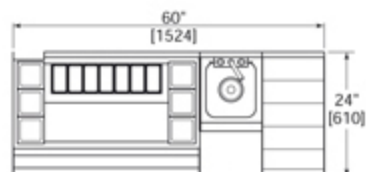

UCS60B-LF

- 36" Ice chest
- 12" Blender with sink and lead-free faucet
- 12" Liquor display

Note: Cocktail stations are custom made and cannot be returned for credit.



WARNING: California Prop 65 Notice
See page 6 for details.



American Barsystems EK · Phone 0049 (0)231 108 77 99 0 · Fax 0049 (0)231 108 77 99
americanbarsystem@t-online.de · www.americanbarsystem.de · www.perlick.com



TOBIN ELLIS SIGNATURE SERIES

BAR EQUIPMENT CONCEIVED AND
DESIGNED BY A RENOWNED BARTENDER...
AND BUILT BY PERLICK



Featuring the World's Original Bartenders' Cockpit

TOBIN ELLIS is founder and principal of Studio Barmagic (est. 1997) and also proudly a veteran bartender of 30+ years who started his foodservice & hospitality career as a dishwasher in upstate New York. His work as an innovation specialist and hospitality generalist over the decades has spanned bar and beverage consulting, advertising and marketing, and most notably designing products, concepts, and spaces. Tobin is also a passionate advocate for the hospitality industry and maintains the Hospitality Relief Dashboard at barmagic.com that holds more than 700 relief resources for his industry. His life's work is centered around improving fellow bartenders' lives behind the wood.

Called "a shot of adrenaline" by the New York Times, Tobin was born in Silicon Valley and raised in Rochester, New York where he first made a name as a veteran high-volume bartender, 6-time national bartending champion, and world-renowned bar operations and training consultant.

Tobin's body of multi-disciplinary work has helped win a slew of accredited hospitality and design awards including a **2019 Best Bars in America Award** from Esquire Magazine and a **2015 GOOD DESIGN Award** from The Chicago Athenaeum Museum of Architecture and Design for his signature line of underbar equipment manufactured by Perlick.



**Bar Designer and World Champion
Bartender Tobin Ellis**

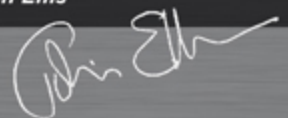

TOBIN ELLIS SIGNATURE SERIES BARTENDER STATION

Pre-configured Bartender Stations

Part No.	Width	Ship Wt. (lbs.)
PTE68-A	68"	300

68" Bartender Station for mod bar installation, 12" insulated bottle well, 30" cold plate ice chest, 8" slanted liquor rack, 18" utility sink, speed rail and accessories, splash mount gooseneck faucet with swing spout (67419-GN-LF), dual foot operated water valves (67420-2-LF).

PTE68-A-WF	68"	300
-------------------	------------	------------

68" Bartender Station for on-site, conventionally framed and finished wall installation, 12" insulated bottle well, 30" cold plate ice chest, 8" slanted liquor rack, 18" utility sink, speed rail and accessories, splash mount gooseneck faucet with swing spout (934GN-LF) in lieu of foot pedal operated faucet for free-standing installation.

PTE68-B	68"	300
----------------	------------	------------

68" Bartender Station for mod bar installation, 12" insulated bottle well, 30" cold plate ice chest, 8" slanted liquor rack, 18" utility sink, speed rail and accessories. Insulated bottle well includes soda manifold, splash mount gooseneck faucet with swing spout (67419-GN-LF), dual foot operated water valves (67420-2-LF).

PTE68-B-WF	68"	300
-------------------	------------	------------

68" Bartender Station for on-site, conventionally framed and finished wall installation, 12" insulated bottle well, 30" cold plate ice chest, 8" slanted liquor rack, 18" utility sink, speed rail and accessories. Insulated bottle well includes soda manifold, splash mount gooseneck faucet with swing spout (934GN-LF) in lieu of foot pedal operated faucet for free-standing installation.

PTE68-C	68"	300
----------------	------------	------------

68" Bartender Station for mod bar installation, 12" craft ice vault, 30" cold plate ice chest, 8" slanted liquor rack, 18" utility sink, speed rail and accessories. Insulated bottle well includes soda manifold, splash mount gooseneck faucet with swing spout (67419-GN-LF), dual foot operated water valves (67420-2-LF).

PTE68-C-WF	68"	300
-------------------	------------	------------

68" Bartender Station for on-site, conventionally framed and finished wall installation, 12" craft ice vault, 30" cold plate ice chest, 8" slanted liquor rack, 18" utility sink, speed rail and accessories. Insulated bottle well includes soda manifold, splash mount gooseneck faucet with swing spout (934GN-LF) in lieu of foot pedal operated faucet for free-standing installation.

PTE80-A	80"	355
----------------	------------	------------

80" Bartender Station for mod bar installation, (2) - 12" insulated bottle wells, manifold holder, 30" cold plate ice chest, 8" slanted liquor rack, 18" utility sink, speed rail and accessories, splash mount gooseneck faucet with swing spout (67419-GN-LF), dual foot operated water valves (67420-2-LF).

PTE80-A-WF	80"	355
-------------------	------------	------------

80" Bartender Station for on-site, conventionally framed and finished wall installation, (2) - 12" insulated bottle wells, manifold holder, 30" cold plate ice chest, 8" slanted liquor rack, 18" utility sink, speed rail and accessories, splash mount gooseneck faucet with swing spout (934GN-LF) in lieu of foot pedal operated faucet for free-standing installation.



PTE68-A-WF

BBS36C
Refrigerated Drawers
sold separately



Top drawer open with
storage compartments
and cutting board



Sink with drainer closeup, bottle
wells and speed rail compartments



Drainboard top
with optional
BBS-CB cutting
board



BBS36C

TOBIN ELLIS SIGNATURE SERIES FRONT-FACING REFRIGERATED DRAWERS

Part No.	Description	Width
BBS36C	Bartender station refrigerated drawer cabinet: self contained, 2 drawers with dividers, solid stainless steel, drainboard top with 4 glass racks	36"

See page 80 for leg and anti-tip caster options.

ACCESSORIES - Refrigerated Drawer Cabinet

Part No.	Description
BBC-GR	Garnish/ingredient rack for combination of ninth size pans
BBC-P9	Pan, ninth-size (6-15/16" x 4-1/4"), stainless steel
BBC-CB	Cutting board, white, 17" x 13" x 1/2", with handle hole and drip channel

BBS36C EXTENDED WARRANTY

Part No.	Description
730	Second year extended parts and labor warranty



Two drawers shown with dividers

eco friendly
R290 Hydrocarbon
Refrigerant



TOBIN ELLIS SIGNATURE SERIES ICE VAULT

Designed by Tobin Ellis to integrate into the Tobin Ellis Signature Series Perlick Cocktail Station, the station maximizes speed and profitability for bartenders and bar owners. Rear vault compartment safely stores up to 48 large format cubes within reach of the bartender. VariChill™ adjustable temperature damper allows you to adjust the temperature in the front vault for storage of juices, spirits, vermouths, or any other bottled ingredient. Triple action lid allows for quick, no-look access to the rear freezer compartment. Slide back for quick access then lift to fold the lid back so it remains in the open position.



Part No.	Description
ISC12-4	Ice Vault - 4in backsplash freestanding
ISC12-6	Ice Vault - 6in backsplash freestanding
ISC12-MB	Ice Vault - modular bar

ACCESSORIES - Tobin Ellis Ice Vault

Part No.	Description
1026867	Ice tempering kit (required per NSF)



1026867



ISC12-6 Top view shown with Ice Tempering Kit

TOBIN ELLIS SIGNATURE SERIES COCKTAIL STATION - ICE CHESTS (17" Depth)

Part No.	Description	Ice Cap. (lbs.)	Width	Ship Wt. (lbs.)
TSC24IC	Ice chest, no cold plate, 24"	50	24"	60
TSC30IC	Ice chest, no cold plate 30"	64	30"	70
TSC36IC	Ice chest, no cold plate, 36"	78	36"	80
TSC42IC	Ice chest, no cold plate, 42"	92	42"	90
TSC24IC10	Ice chest, with cold plate, 24"	50	24"	130
TSC30IC10	Ice chest, with cold plate, 30"	64	30"	140
TSC36IC10	Ice chest with cold plate, 36"	78	36"	150
TSC42IC10	Ice chest, with cold plate, 42"	92	42"	160



TSC24IC10 Shown with optional ice covers

ACCESSORIES - Tobin Ellis Ice Chest Covers

Part No.	Description
ICC-C24	Covers, 3 piece, sliding, 24"
ICC-C30	Covers, 3 piece, sliding, 30"
ICC-C36	Covers, 3 piece, sliding, 36"
ICC-C42	Covers, 3 piece, sliding, 42"

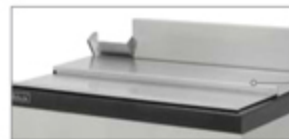

ICC-C24

ACCESSORIES - Tobin Ellis Ice Chest Dividers*

Part No.	Description
ICC-TSC	Ice divider, cocktail station ice chests

*Cocktail Station ice chests can be divided in half, thirds, or quarters. Note: 24" ice chest can only be divided in half.



ICC-TSC

TOBIN ELLIS SIGNATURE SERIES COCKTAIL STATION - Speed Rails

Designed to work exclusively with Tobin Ellis Signature Cocktail Station Modules.

Part No.	Description	Width
SRC-CL	Speed rail, curved, left end	12"
SRC-CR	Speed rail, curved, right end	12"
SRC-S12	12" Straight speed rail	12"
SRC-S18	18" Straight speed rail	18"
SRC-S24	24" Straight speed rail	24"
SRC-S30	30" Straight speed rail	30"
SRC-S36	36" Straight speed rail	36"
SRC-S42	42" Straight speed rail	42"
SRC-S48	48" Straight speed rail	48"

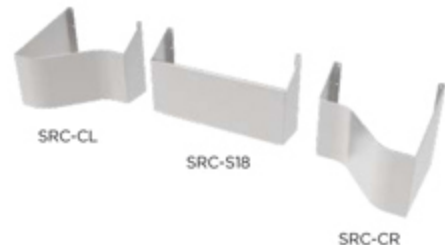

SRC-CL

SRC-S18

SRC-CR

NEW

Tobin Ellis Signature Series Drainboards

The **NEW Tobin Ellis Signature Series Drainboards** elevate the conventional drainboard design by offering additional surface area for glass storage. With "honeycomb" shaped 18-gauge stainless steel perforated inserts, they ensure optimal air flow, leading to efficient drainage.

The outcome? Maximum air circulation beneath the glass, facilitating a speedy, effective, and thorough drying process.

**DESIGNED BY A BARTENDER
FOR BARTENDERS**

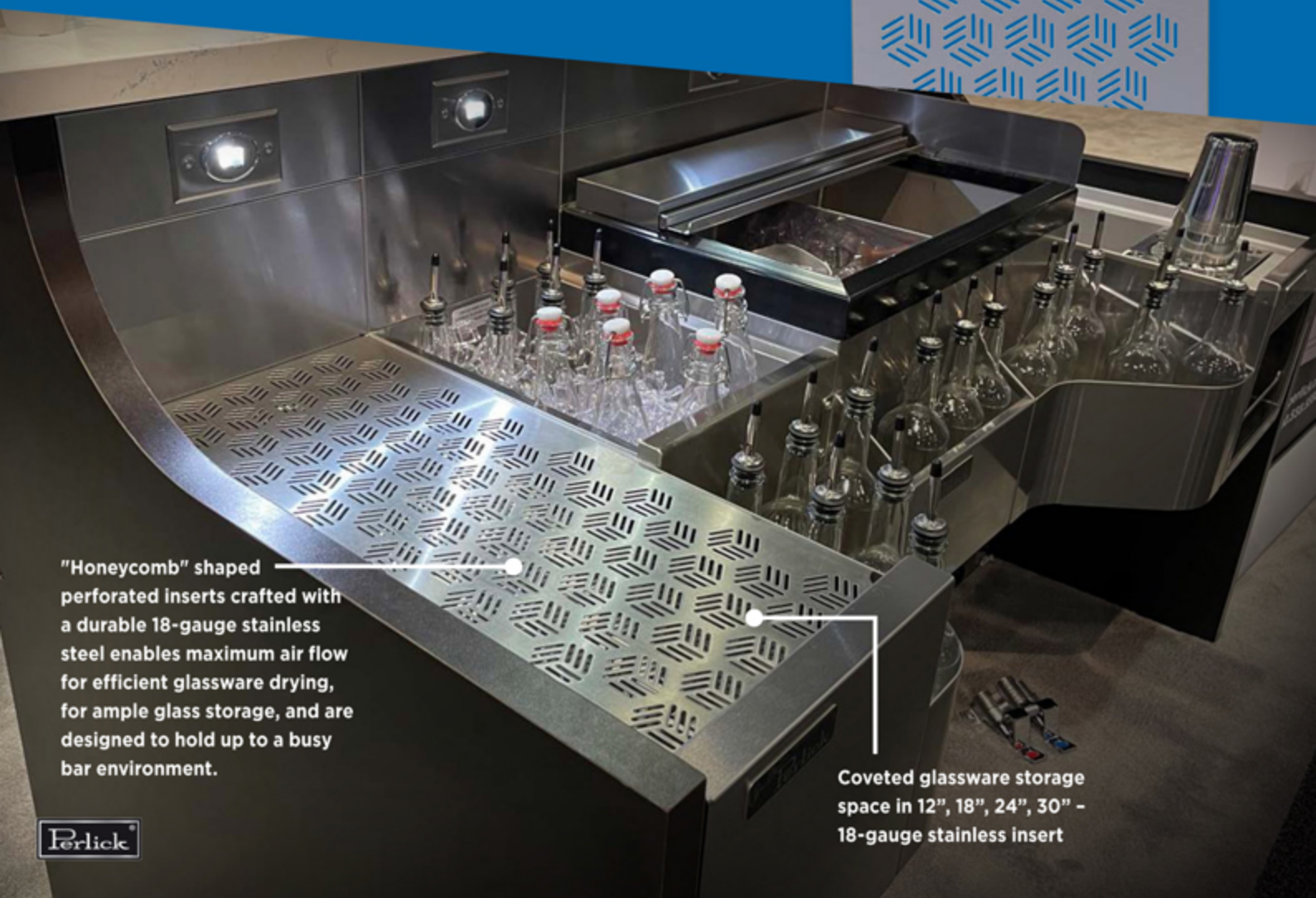
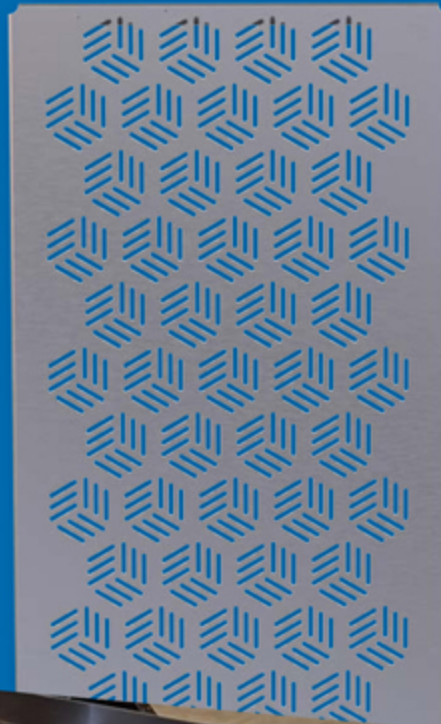

"Honeycomb" shaped perforated inserts crafted with a durable 18-gauge stainless steel enables maximum air flow for efficient glassware drying, for ample glass storage, and are designed to hold up to a busy bar environment.

Coveted glassware storage space in 12", 18", 24", 30" - 18-gauge stainless insert

Perlick®

AMERICAN
BAR SYSTEM
PERLICK DISTRIBUTOR

American Barsystems EK · Phone 0049 (0)231 108 77 99 0 · Fax 0049 (0)231 108 77 99
americanbarsystem@t-online.de · www.americanbarsystem.de · www.perlick.com

New TOBIN ELLIS SIGNATURE SERIES COCKTAIL STATION
Drainboards with Glass Rack

Part No.	Description	Width	Ship Wt. (lbs.)
TSCE12DB	12" Drainboard with glass rack insert	12"	35
TSCE18DB	18" Drainboard with glass rack insert	18"	40
TSCE24DB	24" Drainboard with glass rack insert	24"	45
TSCE30DB	30" Drainboard with glass rack insert	30"	50



TSCE12DB

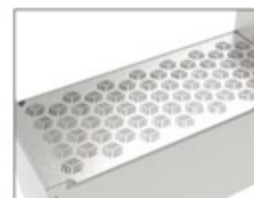

TSCE12DB closeup with NEW drainboard pattern

TOBIN ELLIS SIGNATURE SERIES COCKTAIL STATION
Insulated Bottle Well

Part No.	Description	Width	Ship Wt. (lbs.)
TSC12IBW	Insulated bottle well, 12" (17" depth)	12"	35
TSC12IBW-MH	Insulated bottle well, with manifold housing, 12" (17" depth)	12"	50
TSCE12IBW	Insulated bottle well, extended depth, 12" (27-1/2" depth)	12"	55

*Soda gun sold separately



TSC12IBW



TSC12IBW-MH

TOBIN ELLIS SIGNATURE SERIES COCKTAIL STATION
Slanted Speed Rack (27-1/2" Depth)

Part No.	Description	Width	Ship Wt. (lbs.)
TSCE8SSR	8" Liquor step	8"	35
TSCE12SSR	12" Liquor step	12"	40
TSCE8SSR-BP	8" Liquor step with blender platform	8"	35
TSCE12SSR-BP	12" Liquor step with blender platform	12"	40



TSCE8SSR
Shown w/ optional
MBS-LED-CW
LED lights



MBS-LED-CW

ACCESSORIES - Slanted Speed Rack

Part No.	Description
MBS-LED-CW	LED accent light, cool white, 24VDC, 2.5W
MBS-LED-PS40	Power supply for up to 12 LED lights, converts 120VAC to 25VDC, 40W maximum

TOBIN ELLIS SIGNATURE SERIES COCKTAIL STATION
12" Utility Sinks with Glass Rinser (27-1/2" Depth)

Part No.	Description	Width	Ship Wt. (lbs.)
TSCE12PS	Cocktail station 12" prep sinks with glass rinser	12"	50
TSCE12PS-RC	Cocktail station 12" prep sinks with glass rinser, 12" with recessed cubby	12"	50



TSCE12PS



TSCE12PS-RC

Both are shown with optional foot pedal operated

TOBIN ELLIS SIGNATURE SERIES COCKTAIL STATION
18" Utility Sink with Glass Rinser and Tool Caddy (27-1/2" Depth)

Part No.	Description	Width	Ship Wt. (lbs.)
TSCE18PSTC	Utility sink with glass rinser and tool caddy, 18"	18"	60
TSCE18PSTC-RC	Utility sink with glass rinser and tool caddy, 18" with recessed cubby	18"	60

ACCESSORIES - Rinse Sink

Part No.	Description
67419-GN-LF*#	Swing spout, gooseneck, wall mount
67419-6W-LF*#	Swing spout, 6", wall mount
67420-2-LF	Water valve, dual pedal, foot operated, 1/2" NPT
934GN-LF	Front loading, wall/splash mount, lead-free faucet with gooseneck spout
934-6LF	Front loading, wall/splash mount, lead-free faucet with 6" swing spout
7055-47	Wet waste basket, stainless steel

* For use with foot operated water valve. # Faucet connection extends 1" beyond back of cabinet. OK on Modular Bar.



67419-GN-LF*#



67420-2-LF

TOBIN ELLIS SIGNATURE SERIES DRAFT COCKTAIL SYSTEM COMPONENTS

- NSF certified circulating pump maintains a thorough blend of beverage ingredients without over-agitating
- Programmable timer allows for intermittent mixing to precisely and automatically control circulation
- In-line mesh filter prevents pulp and other ingredients from entering pump
- Choose from 5- and 10-gallon circulating cocktail kegs or select from 5-gallon and 2.5-gallon standard non-circulating kegs for cocktails that do not require stirring

DRAFT COCKTAIL DISPENSING KITS

Order one kit for each keg being dispensed. Circulating cocktail pump must be mounted outside of the direct draw cabinet.



Part No.	Description
KCTCDD-X	Tobin Ellis Direct Draw Cocktail Dispensing kit

Kit includes:

Part No.	Description
KCP-X	Circulating cocktail pump
KCPC	Pump parts bag including in-line filter and timer
	Gas and beverage tubing
	Mounting brackets and hardware for cocktail pump

*Circulating Cocktail Kegs ordered separately



NON-CIRCULATING COCKTAIL KEGS

Part No.	Description
CC5NAT	5 gallon, standard non-circulating cocktail keg
CC2.5NAT	2.5 gallon standard non-circulating keg
CCTCK	Parts bag for non-circulating cocktail keg

CIRCULATING COCKTAIL KEGS

Part No.	Description
KC5	Tobin Ellis 5 gallon, circulating cocktail keg
KC10	Tobin Ellis 10 gallon, circulating cocktail keg

CIRCULATING DRAFT COCKTAIL COMPONENTS

Part No.	Description
KCP-X*	Tobin Ellis circulating pump for cocktail keg
KCPC*	Tobin Ellis circulating pump connection kit cocktail keg

*Included in KCTCLD-X

ADDITIONAL ACCESSORIES

Part No.	Description
KCNT	Nitrogen cylinder, alum., 244 cu/in internal volume
2925C	Primary regulator for N2, twin gauge
2928F	Primary regulator for CO2, twin gauge
KCPS	Tobin Ellis pulp strainer for kegging cocktail mixture

Towers are ordered separately. Draft Cocktail System compatible with all towers containing 304 stainless steel shanks.





TOBIN ELLIS SIGNATURE SERIES LIMITED EDITION MOBILE BAR

Designed by Tobin Ellis especially for high-volume, upscale venues, this mobile cockpit features a custom, high-performance solid surface "cockpit bar counter" with an 8" deep workboard and additional ergonomic features for greater bartender comfort, all wrapped in luxurious, eco-friendly toffee crocodile recycled leather.

All Perlick Tobin Ellis Signature Series Limited Edition Mobile Bars include:

- Luxury finishing with eco-friendly recycled leather in Toffee Crocodile selected especially for upscale environments
- Extra large inlaid 8" deep 14-gauge stainless steel perforated workboard with a custom Antique Copper PVD finish keep bar top clean and dry
- Smooth, rounded edges and corners for added bartender comfort
- Durable, solid surface Vanilla Sugar finish bar top
- Optimized to an ideal height for all bartenders to increase speed and reduce repetitive stress injuries
- Double drainboard design for maximum flexibility
- Holds up to 27 liters, 36 pieces of glassware, 40 cans or bottles of soda, 3 types of ice, and more, depending on setup
- Puts bartender at center for true zero-step bartending



MOBS-66LE

TOBIN ELLIS SIGNATURE SERIES LIMITED EDITION MOBILE BAR

Part No.	Description
MOBS-66LE	Mobile bar, 66"



Eco-friendly toffee crocodile recycled leather



MOBS-66LE Front view

TOBIN ELLIS SIGNATURE SERIES MOBILE BARS

Perlick's Signature Series Mobile Bars utilize the Tobin Ellis zero-step bartending cockpit design for efficiency, which means more drinks poured in less time, resulting in greater profits and less bartender fatigue. Easily move the bar anywhere inside or outside of your venue for design and operational flexibility. Utilize one or several units to create multiple cocktail stations.

All Tobin Ellis Signature Series Mobile Bars include:

- Tobin Ellis Signature Series Bartenders' Cockpit for increased efficiency and revenue
- Laminate, stainless steel, or engineered solid surface bar top options
- Laminate exterior offered in multiple colors
- Locking 5" 304 stainless steel casters, for corrosion resistance, with polyurethane tread
- Lower storage area for glass racks, dry goods, and canned or bottled beverages
- LED bartender task lighting for operating in the evening and low light settings
- Ice melt drainage tank

TOBIN ELLIS SIGNATURE SERIES MOBILE BARS

Part No.	Description
	Mobile bar, 42"
MOBS-42TE	Exterior vinyl graphics option
	Stainless steel top
	Engineered solid surface top
	Mobile bar, 66"
MOBS-66TE	Exterior vinyl graphics option
	Stainless steel top
	Engineered solid surface top
	Mobile bar, 66" with handwashing sink
MOBS-66TE-S	Exterior vinyl graphics option
	Stainless steel top
	Engineered solid surface top



MOBS-42TE



MOBS-66TE



MOBS-66TE-S

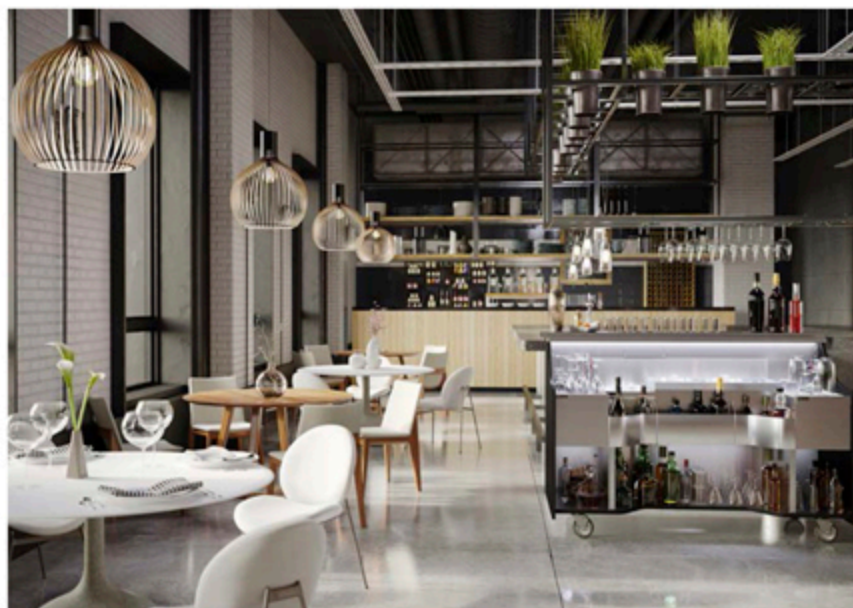

PERLICK MOBILE BARS

Designed by Tobin Ellis

Perlick Mobile Bars are an economical solution to your mobile bar needs. Easily move the bar anywhere inside or outside your venue for design and operational flexibility.

All Perlick Mobile Bars include:

- Laminate, stainless steel, or engineered solid surface bar top options
- Laminate exterior offered in multiple colors
- Locking 5" 304 stainless steel casters, for corrosion resistance, with polyurethane tread
- Ice melt drainage tank
- Lower storage area for glass racks, dry goods, and canned or bottled beverages
- LED bartender task lighting for operating in the evening and low light settings

PERLICK MOBILE BARS

Part No.	Description
MOBS-42TS	Mobile bar, 42"
	Exterior vinyl graphics option
	Stainless steel top
MOBS-66TS	Engineered solid surface top
	Mobile bar, 66"
	Exterior vinyl graphics option
MOBS-66TS-S	Stainless steel top
	Engineered solid surface top
	Mobile bar, 66" with handwashing sink
MOBS-66TS-S	Exterior vinyl graphics option
	Stainless steel top
	Engineered solid surface top

TOBIN ELLIS SIGNATURE SERIES MOBILE REFRIGERATION

Part No.	Description
MOBS-BBS36C	Mobile BBS36C Refrigeration

PERLICK MOBILE CARTS

Part No.	Description
MOBS-24DSC	Mobile cart, 24" drainboard storage cabinet
	Exterior vinyl graphics option
	Stainless steel top
	Engineered solid surface top



MOBS-42TS



MOBS-66TS



MOBS-66TS-S



MOBS-BBS36C



MOBS-24DSC

CUSTOMIZATION

Tobin Ellis Signature Series Mobile Bars, Perlick Mobile Bars, and the Tobin Ellis Signature Series Refrigerated Drawers, and the Perlick Drainboard Cabinet are available in a variety of finishes to match your room's decor. The Perlick Mobile Refrigeration does not feature bar top options.

For more details, refer to the product spec sheets or visit Perlick.com.

LAMINATE EXTERIOR OPTIONS

- | | |
|--------------|------------------|
| Black | Gray Sand |
| Pewter Brush | Ebony Wood |
| Beige Suede | Amber Maple |
| Maple | Mahogany |
| Red Maple | Victorian Cherry |

Note: Custom vinyl wrap graphics available (must call Perlick for quote and ordering process)

BAR TOP OPTIONS

- | | |
|---------------------------------|------------------|
| Standard | Gray Sand |
| Black | Ebony Wood |
| Pewter Brush | Amber Maple |
| Beige Suede | Mahogany |
| Maple | Victorian Cherry |
| Red Maple | |
| Engineered Solid Surface | |
| White Quartz | Allspice Quartz |
| Black Pearl | |
| Stainless Steel | |

PERLICK MOBILE TAP

Superior dispensing equipment paired with premium, commercial-grade refrigeration offers the ultimate combination for a durable and reliable system you can trust to deliver the perfect pour.

- Two-faucet draft arm dispenses the following combinations of beverages:
 - Nitro and cold brew coffee or wine
 - Beer and wine
 - Two varieties of wine
 - Two varieties of beer
- Kit includes a 24" refrigeration unit, two-faucet draft arm, all dispensing equipment, and casters for ease of mobility
- Forced-air refrigeration technology ensures consistent temperature throughout the entire keg and tower, maintaining flavor and minimizing foam
- Quick disconnect kegs included with HC24RS4S-GO-SLFLT
- Includes two low profile couplers (HC24RS4S-GO-SLFLT includes one coupler and two sets of quick disconnects with kegs)
- Large, easy-to-move casters offer flexibility to move the dispensing unit where needed, optimizing profits
- Locking refrigeration door prevents tampering with components and beverages inside the unit
- NSF certified



HC24RS4S-HO-SLFLT
HC24RS4S-IO-SLFLT
HC24RS4S-JO-SLFLT



HC24RS4S-HO-SLFLT



Two-faucet draft arm included



Casters for ease of mobility



HC24RS4S-GO-SLFLT
Inside view of nitro/cold brew coffee or wine Mobile Tap

PERLICK MOBILE TAP

Part No.	Description
HC24RS4S-GO-SLFLT	Kit, mobile tap, commercial, nitro and kegged wine or cold brew coffee, 2 faucet
HC24RS4S-HO-SLFLT	Kit, mobile tap, commercial, kegged wine and kegged wine, 2 faucet
HC24RS4S-IO-SLFLT	Kit, mobile tap, commercial, domestic beer and kegged wine, 2 faucet
HC24RS4S-JO-SLFLT	Kit, mobile tap, commercial, domestic beer and domestic beer, 2 faucet



WARNING: California Prop 65 Notice
See page 6 for details.



American Barsystems EK · Phone 0049 (0)231 108 77 99 0 · Fax 0049 (0)231 108 77 99
americanbarsystem@t-online.de · www.americanbarsystem.de · www.perlick.com

STANDARD ICE CHESTS

TS Series	TSD Series	TSS Series	Ice Cap. (lbs.)	Ship Wt. (lbs.)	No. of Cold Plate Circuits
Part No.	Part No.	Part No.			
18" Width					
TS18IC	TSD18IC	N/A	35	50	N/A

Accessories for 18" Ice Chests

Part No.	Description
ICC18	Front and back covers
BW3-18	3 plastic bottle wells, front and back covers
BW9-18	9 plastic bottle wells, no covers

24" Width

TS24IC	TSD24IC	N/A	50	60	0
TS24IC10	TSD24IC10	TSS24IC10			

Accessories for 24" Ice Chests

Part No.	Description
ICC24	Front and back covers
BW3-24	3 plastic bottle wells, front and back covers
BW6-24	3 plastic bottle wells, front and back covers, 3 plastic bottle wells
BW6A-24	6 plastic bottle wells, front and back covers

30" Width

TS30IC	TSD30IC	N/A	70	70	N/A
TS30IC10	TSD30IC10	TSS30IC10			

Accessories for 30" Ice Chests

Part No.	Description
ICC30	Front and back covers
BW3-30	3 plastic bottle wells, front and back covers
BW6-30	3 plastic bottle wells, front and back covers, 3 plastic bottle wells
BW6A-30	6 plastic bottle wells, front and back covers
BW9-30	3 plastic bottle wells, front and back covers, 6 plastic bottle wells

36" Width

TS36IC	TSD36IC	N/A	85	80	N/A
TS36IC10	TSD36IC10	N/A			

Accessories for 36" Ice Chests

Part No.	Description
ICC36	Front and back covers
BW3-36	3 plastic bottle wells, front and back covers
BW6-36	3 plastic bottle wells, front and back covers, 3 plastic bottle wells
BW6A-36	6 plastic bottle wells, front and back covers
BW9-36	3 plastic bottle wells, front and back covers, 6 plastic bottle wells

42" Width

TS42IC	TSD42IC	N/A	100	90	N/A
TS42IC10	TSD42IC10	N/A			

Accessories for 42" Ice Chests

Part No.	Description
ICC42	Front and back covers
BW3-42	3 plastic bottle wells, front and back covers
BW6-42	3 plastic bottle wells, front and back covers, 3 plastic bottle wells
BW6A-42	6 plastic bottle wells, front and back covers
BW9-42	3 plastic bottle wells, front and back covers, 6 plastic bottle wells

48" Width

TS48IC	TSD48IC	N/A	115	100	N/A
TS48IC10	TSD48IC10	N/A			

Accessories for 48" Ice Chests

Part No.	Description
ICC48	Front and back covers
BW3-48	3 plastic bottle wells, front and back covers
BW6-48	3 plastic bottle wells, front and back covers, 3 plastic bottle wells
BW6A-48	6 plastic bottle wells, front and back covers
BW9-48	3 plastic bottle wells, front and back covers, 6 plastic bottle wells

Note: All cold plate ice chests are 10 circuit



TS30IC10
Shown with cover
and optional soda
chase cutout

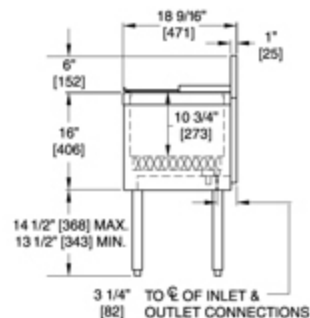

End View Standard Ice Chest

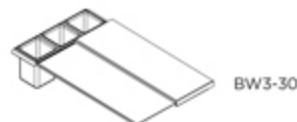

BW3-30

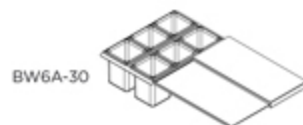

BW6A-30

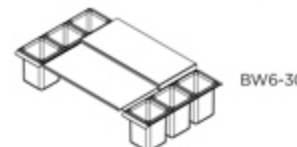

BW6-30

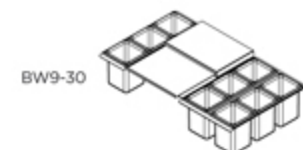

BW9-30

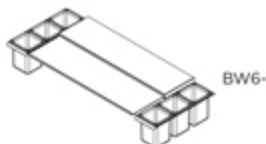

BW6-42

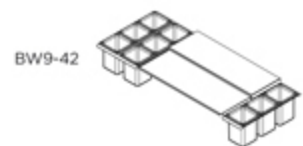

BW9-42

FULL DEPTH ICE CHESTS

TSF Series			
Part No.	Ice Cap. (lbs.)	Ship Wt. (lbs.)	No. of Cold Plate Circuits
18" Width			
TSF18IC	45	60	N/A
TSF18IC10	45	130	10

Accessories for TSF18 Ice Chests

Part No.	Description
ICC-F18	Front and back covers
BWF4-18	4 plastic bottle wells, front and back covers

24" Width			
TSF24IC	65	70	N/A
TSF24IC10	65	140	10

Accessories for TSF24 Ice Chests

Part No.	Description
ICC-F24	Front and back covers
BWF4-24	4 plastic bottle wells, front and back covers
BWF8-24	4 plastic bottle wells, front and back covers, 4 plastic bottle wells

30" Width			
TSF30IC	85	80	N/A
TSF30IC10	85	150	10

Accessory Covers and Bottle Wells for TCF30 Ice Chests

Part No.	Description
ICC-F30	Front and back covers
BWF4-30	4 plastic bottle wells, front and back covers
BWF8-30	4 plastic bottle wells, front and back covers, 4 plastic bottle wells

36" Width			
TSF36IC	105	90	N/A
TSF36IC10	105	160	10

Accessories for TSF36 Ice Chests

Part No.	Description
ICC-F36	Front and back covers
BWF4-36	4 plastic bottle wells, front and back covers
BWF8-36	4 plastic bottle wells, front and back covers, 4 plastic bottle wells

42" Width			
TSF42IC	125	100	N/A
TSF42IC10	125	170	10

Accessories for TSF42 Ice Chests

Part No.	Description
ICC-F42	Front and back covers
BWF4-42	4 plastic bottle wells, front and back covers
BWF8-42	4 plastic bottle wells, front and back covers, 4 plastic bottle wells

48" Width			
TSF48IC	145	110	N/A
TSF48IC10	145	180	10

Accessories for TSF48 Ice Chests

Part No.	Description
ICC-F48	Front and back covers
BWF4-48	4 plastic bottle wells, front and back covers
BWF8-48	4 plastic bottle wells, front and back covers, 4 plastic bottle wells



TSF24IC10

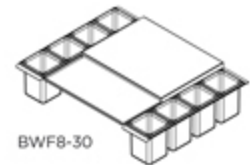

BWF8-30

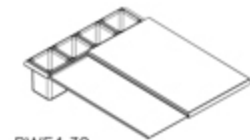

BWF4-30

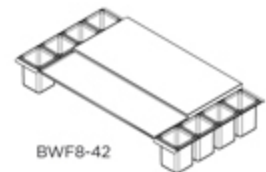

BWF8-42

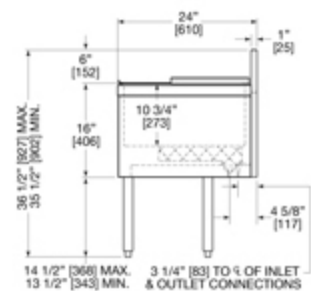

End View TSF Ice Chest

EXTRA CAPACITY ICE CHESTS

TS Series	TSD Series	Ice Cap. (lbs.)	Ship Wt. (lbs.)	No. of Cold Plate Circuits
Part No.	Part No			
24" Width				
TS24IC-EC	TSD24IC-EC	75	100	N/A
TS24IC-EC10	TSD24IC-EC10	75	170	10

Accessories for 24" Ice Chests

Part No.	Description
ICC24	Front and back covers
BW3-24	3 plastic bottle wells, front and back covers
BW6-24	3 plastic bottle wells, front and back covers, 3 plastic bottle wells
BW6A-24	6 plastic bottle wells, front and back covers

30" Width				
TS30IC-EC	TSD30IC-EC	95	110	N/A
TS30IC-EC10	TSD30IC-EC10	95	180	10

Accessories for 30" Ice Chests

Part No.	Description
ICC30	Front and back covers
BW3-30	3 plastic bottle wells, front and back covers
BW6-30	3 plastic bottle wells, front and back covers, 3 plastic bottle wells
BW6A-30	6 plastic bottle wells, front and back covers
BW9-30	3 plastic bottle wells, front and back covers, 6 plastic bottle wells

36" Width				
TS36IC-EC	TSD36IC-EC	115	120	N/A
TS36IC-EC10	TSD36IC-EC10	115	190	10

Accessories for 36" Ice Chests

Part No.	Description
ICC36	Front and back covers
BW3-36	3 plastic bottle wells, front and back covers
BW6-36	3 plastic bottle wells, front and back covers, 3 plastic bottle wells
BW6A-36	6 plastic bottle wells, front and back covers
BW9-36	3 plastic bottle wells, front and back covers, 6 plastic bottle wells

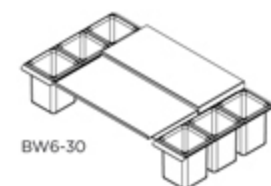
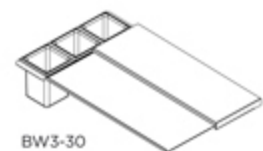
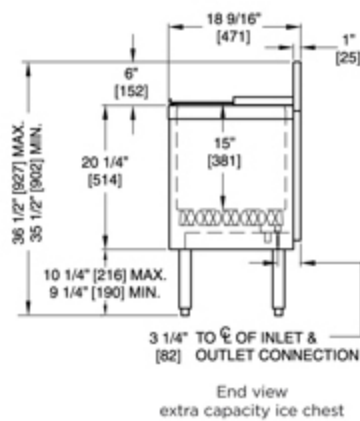

SERVICE STATION

SS Series	Ice Cap. (lbs.)	Ship Wt. (lbs.)	No. of Cold Plate Circuits
Part No.			
24" Width			
SS24IC10	114	170	10
SS24IC20*	114	240	20

Accessory Covers and Bottle Wells for 24" Ice Chests

Part No.	Description
ICC-SS24	Front and back covers
BW-SS6-24	3 plastic bottle wells, 4 piece cover set, 3 plastic bottle wells

30" Width			
SS30IC10	144	190	10
SS30IC20*	144	260	20

Accessory Covers and Bottle Wells for 30" Ice Chests

Part No.	Description
ICC-SS30	Front and back covers
BW-SS6-30	3 plastic bottle wells, 4 piece cover set, 3 plastic bottle wells

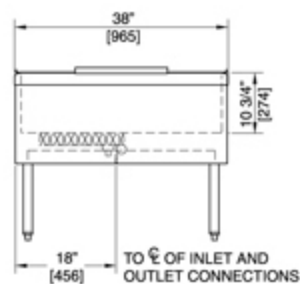

End view of service station ice chest

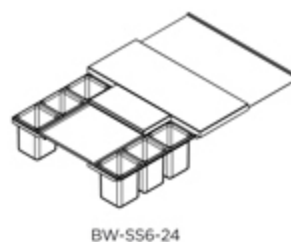
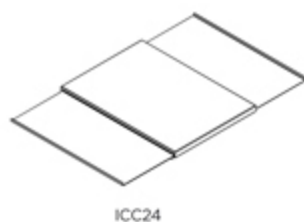

DROP-IN ICE CHESTS

Part No.	Ice Cap. (lbs.)	Ship Wt. (lbs.)	No. of Cold Plate Circuits
17" Width (NEW)			
DI17IC	35	50	N/A
18" Width			
DI18IC	35	50	N/A
24" Width			
DI24IC	50	60	N/A
DI24IC10	50	130	10
30" Width			
DI30IC	65	70	N/A
DI30IC10	65	140	10
36" Width			
DI36IC	80	80	N/A
DI36IC10	80	150	10

Note: Standard covers are included with all drop-in ice chests.



DI24IC

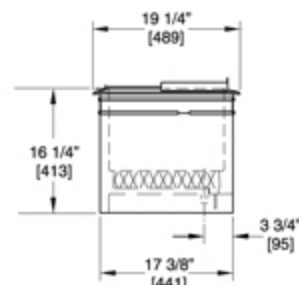

End view drop-in ice chest

ICE CHEST ACCESSORIES

Condiment Trays

Free-standing stainless steel rack. Designed for ice chest back cover but can be located anywhere convenient. Each plastic cup is 5-1/2" x 3" x 3" deep and holds 1 pint.

Part No.	Description
CC4	4 cup condiment tray 12-1/2" width
CC5	5 cup condiment tray 15-3/8" width
CC6	6 cup condiment tray 18-1/4" width
CC7	7 cup condiment tray 21-1/4" width

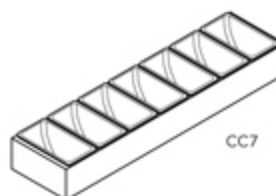

CC7

Ice Dividers - Free-standing

Part No.	Application	Width	Height
ICD-TS	Standard ice chests	15-1/16"	9-5/8"
ICD-DI*	Drop-in ice chests	14-3/4"	9-5/8"
ICD-TSF	Full depth ice chests	20-1/2"	9-5/8"
ICD-EC	Extra capacity ice chests	15-1/16"	13-7/8"
ICD-SS	Service station ice chests (38")	35-9/16"	9-5/8"
ICD-PT	Pass-thru station ice chests (32")	29-9/16"	9-5/8"

* Not applicable for DI17IC

Add "-R" suffix for field installed

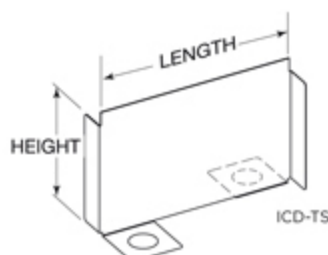

ICD-TS

Backsplash Cutout

Part No.	Description
7055-265A*	For soda lines

* Not applicable on TSD models or modular bar

Note: Only available on ice chests and drainboards.



7055-265A - soda chase cutout

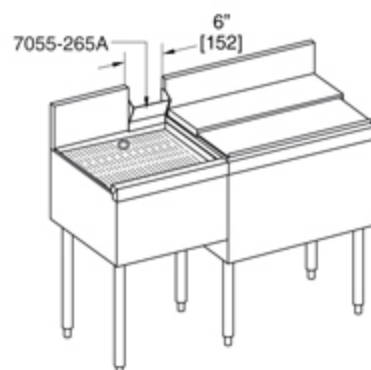

INSULATED STORAGE CHESTS

6" Wide Chest

TS Series	TSF Series	TSS Series		
Part No.	Part No.	Part No.	Description	Ship Wt. (lbs.)
TS6U	TSF6U	TSS6U	6" Chest	30
TS6U2	TSF6U2	TSS6U2	6" Chest with 3 bottle wells	32

12" Wide Chest

TS12U	TSF12U	TSS12U	12" Chest	36
TS12U2	TSF12U2	TSS12U2	12" Chest with 6 bottle wells	38
TS12U3	TSF12U3	N/A	12" Chest with 8 condiment cups	38



TS12U2

Accessories

Part No.	Description
59543-1	8 bottle wire rack divider for TS12U



59543-1

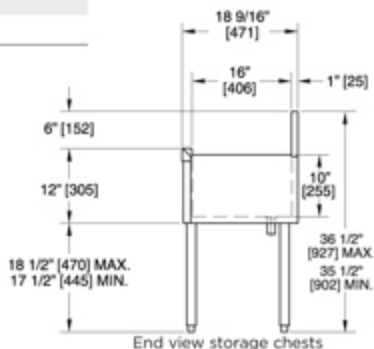

End view storage chests



TS6U2



TS12U2

ICE CREAM CENTER

24" Wide Cabinet with Drop-In Ice Cream Unit

Includes five year compressor warranty

TS Series	TSD Series	
Part No.	Part No.	Ship Wt. (lbs.)
TS24DC-A	TSD24DC-A	199

*Order #8000B Drop-In Ice Cream Unit separately

Drop-In Ice Cream Unit Only

Includes five year compressor warranty

16" Wide x 16" Deep x 26-34" High

Part No.	Description	Ship Wt. (lbs.)
8000B	Drop-in ice cream freezer unit	114

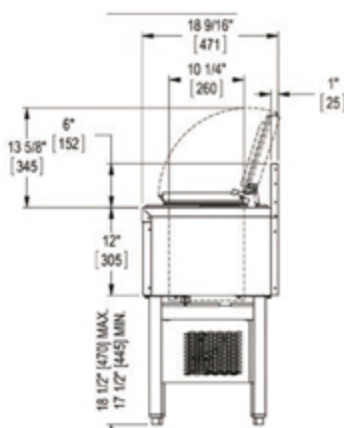
TSD24DC-A
(Shown with 8000B
Ice Cream Unit,
order separately)

End view ice cream cabinet

Second Year Extended Parts and Labor Warranty

Part No.	Description
730	Second year extended parts and labor warranty

ACCESSORIES FOR DROP-IN ICE CREAM UNIT

Part No.	Description
8005A-1	Dipper well kit
8005-2	Lead-free faucet kit for dipper well
8005A	Dipper well and faucet kit

Note: Modules on this page, assembled to other modules, are custom made and cannot be returned for credit.

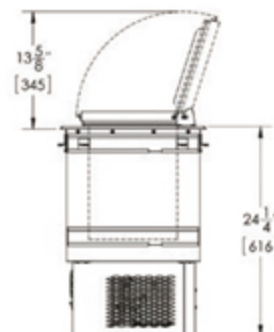

8000B

End view drop-in
ice cream unit

Soda gun fillers are designed to mount Wunder-Bar® or Schroeder America™ 8-14 product soda gun manifolds and drip cups (not included). Manifolds mount to a universal interior side bracket to conceal soda lines. The drip cup mounts to the top cover, which is removable without tools for easy access and service. Soda gun fillers have no provisions for legs. Filler must be mounted to adjacent equipment. Soda gun, manifold, and drip cup are not included and shown for illustration purpose only.

SODA GUN FILLER SECTIONS

TS Series	TSF Series	TSS Series	PTS Series	Application		
Part No.	Part No.	Part No.	Part No.	Wunder-Bar®	Schroeder®	Ship Wt. (lbs.)
*TS4SGB	*TSF4SGB	TSS4.25SGB	PTS4.25SGB	Yes	Yes	20
TS6SGB	TSF6SGB	TSS6SGB	PTS6SGB	Yes	Yes	25

*Accepts only non-flow-control manifolds that don't exceed 3" in overall thickness; 36" (914) overall height

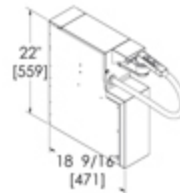

TS6SGB

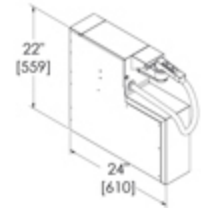

TSF6SGB

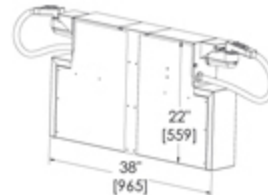

TSS6SGB

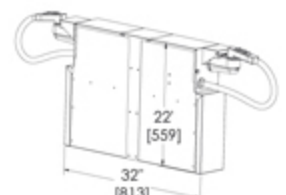

PTS6SGB

6" FILLER SECTIONS

Part No.	Description	Ship Wt. (lbs.)
TS Series		
TS6FA	With flat top	18
TS6CO-DB	With access cutout and drainboard	15
TS6CO2	Access cutout and 2 bottle wells	25
TSF Series		
TSF6CO-DB	With access cutout and drainboard	

Accessories

Part No.	Description
7055-66	Chase for TS6CO
7055-74	Chase for TS6CO2
7055-68	Stainless steel backsplash

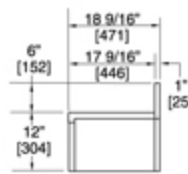

End View TS6FA

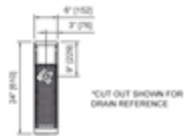

TSF6CO-DB

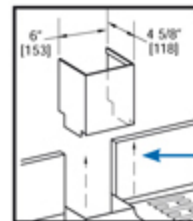

TS6CO-BW
(with 7055-66
backsplash chase)

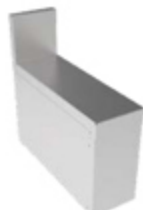
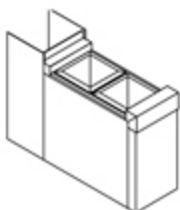

Note: Modules on this page, assembled to other modules, are custom made and cannot be returned for credit.

New DRAINBOARD & EQUIPMENT STANDS

TS Series	TSF Series	TSS Series	Width	Ship Wt. (lbs.)
TS12DB	TSF12DB	TSS12DB	12"	35
TS13DB	TSF13DB	N/A	13"	35
TS14DB	TSF14DB	N/A	14"	37
TS15DB	TSF15DB	N/A	15"	37
TS16DB	TSF16DB	N/A	16"	38
TS17DB	TSF17DB	N/A	17"	38
TS18DB	TSF18DB	TSS18DB	18"	40
TS19DB	TSF19DB	N/A	19"	40
TS20DB	TSF20DB	N/A	20"	42
TS21DB	TSF21DB	N/A	21"	42
TS22DB	TSF22DB	N/A	22"	44
TS23DB	TSF23DB	N/A	23"	44
TS24DB	TSF24DB	TSS24DB	24"	45
TS25DB	TSF25DB	N/A	25"	45
TS26DB	TSF26DB	N/A	26"	47
TS27DB	TSF27DB	N/A	27"	47
TS28DB	TSF28DB	N/A	28"	48
TS29DB	TSF29DB	N/A	29"	48
TS30DB	TSF30DB	TSS30DB	30"	50
TS36DB	TSF36DB	N/A	36"	60
TS42DB	TSF42DB	N/A	42"	90
TS48DB	TSF48DB	N/A	48"	115



TS24DB



Closeup of drainboard

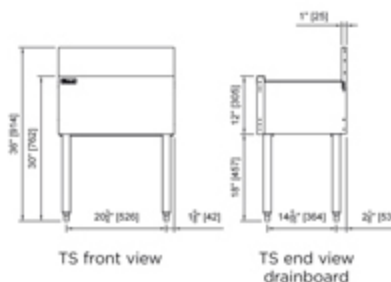
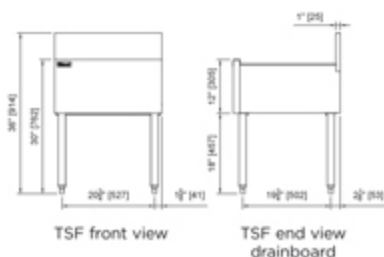

TSF18DB

**DROP-DOWN DRAINBOARDS**

TSF Series		
Part No.	Width	Ship Wt. (lbs.)
TSF12DD	12"	30
TSF18DD	18"	35
TSF24DD	24"	40

Note: Legs are included with drop-down drainboards.

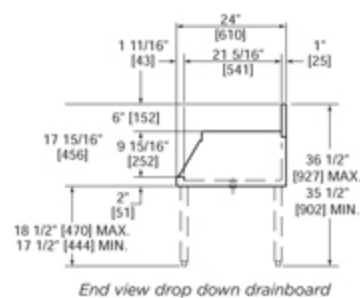

TS24DD

**ACCESSORY PERLICK FLEX MOUNT LEG RELOCATION KIT**

Part No.	Description
1039805	Perlick Flex Mount Leg Relocation Kit, includes rail, bolt, and tightening knob, for NEW TSF Series Equipment



1039805



New DRAINBOARD INSERTS

TS Series	TSF Series		
Part No.	Part No.	Width	Ship Wt. (lbs.)
1040635-12	1032968-12	12"	5
1040635-13	1032968-13	13"	5
1040635-14	1032968-14	14"	6
1040635-15	1032968-15	15"	6
1040635-16	1032968-16	16"	7
1040635-17	1032968-17	17"	7
1040635-18	1032968-18	18"	8
1040635-19	1032968-19	19"	8
1040635-20	1032968-20	20"	9
1040635-21	1032968-21	21"	9
1040635-22	1032968-22	22"	9
1040635-23	1032968-23	23"	10
1040635-24	1032968-24	24"	10

2x size options for drainboards larger than 24"
 -R suffix for field installed

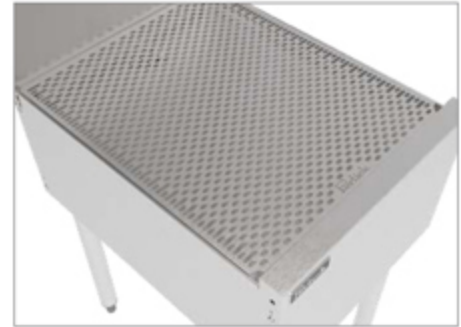

New DRAINBOARD FLAT TOP INSERTS

TS Series	TSF Series		
Part No.	Part No.	Width	Ship Wt. (lbs.)
1040689-12	1032573-12	12"	5
1040689-15	1032573-15	15"	6
N/A	1032573-16	15"	6
1040689-18	1032573-18	18"	8
1040689-24	1032573-24	24"	10

(2) 15" option for 30" drainboards
 -R suffix for field installed



EQUIPMENT STANDS

Part No.	Width	Ship Wt. (lbs.)
ES18	18"	45
ES24	24"	65

Note: Modules on this page, assembled to other modules, are custom made and cannot be returned for credit.



ES18

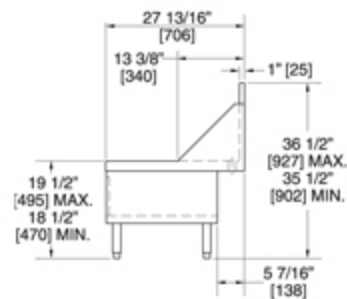

End view equipment stand

New BLENDERS STATIONS WITH SINK

TSF Series	TSS Series	Width	Ship Wt. (lbs.)
Part No.	Part No.		
TSF12BS	TSS12BS*	12"	50
TSF18BS	TSS18BS	18"	60

* Water faucet sold separately with TSS blender station



TSF18BS

New BLENDERS STATIONS WITH SINK AND RINSER

TSF Series	Width	Ship Wt. (lbs.)
Part No.		
TSF18BS-RS	18"	50



TSF18BS-RS

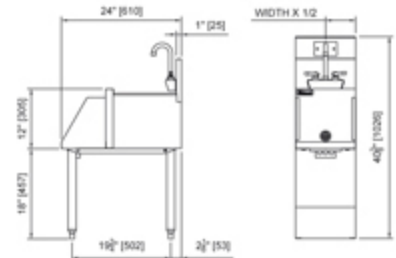

End view blender station with sink

ACCESSORIES FOR BLENDER STATIONS**Accessory "Wall" Mount Water Faucets for TS Series Blender Stations**

Part No.	Description
934GN-LF	Wall faucet with gooseneck spout, lead-free, 2.2 GPM (8.3 L/min)

Accessory "Deck" Mount Water Faucets for TSD & TSS Series Blender Stations

Part No.	Description
926GN-LF	Deck faucet with gooseneck spout, lead-free, 2.2 GPM (8.3 L/min)

Misc. Accessories for Blender Stations

Part No.	Description
43688A	Water conserving aerator, 0.5 GPM (1.9 L/min)
43688F	Water conserving aerator, 1.5 GPM (5.7 L/min)
7055-52	Perforated wet waste pan for 12" & 14" blenders, clear plastic, 2.7 quart
7055-48	Perforated wet waste pan for 18" blender, stainless, 7 quart
736B	Towel ring, field installed
736BIN	Towel ring, factory installed

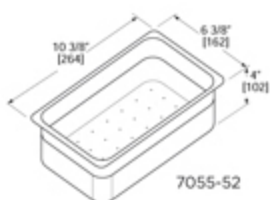
934GN-LF
Wall Mounted
Faucet

7055-52

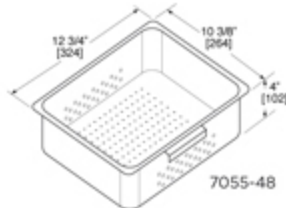

7055-48



934GN-LF



926GN-LF

BLENDER STATION WITH FLAT TOP

TS Series	Width	Ship Wt. (lbs.)
Part No.		
TS12BLD	12"	45
TS18BLD	18"	55



TS12BLD

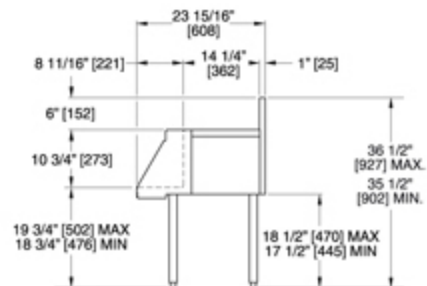

End view blender station with flat work surface

TSS 3" DECK ASSEMBLIES

Joins TSS modules to form back-to-back service stations.

TSS Series		
Part No.	Description	Ship Wt. (lbs.)
TSS12BU	12" Deck	10
TSS18BU	18" Deck	11
TSS24BU	24" Deck	12
TSS30BU	30" Deck	13

Water faucet sold separately.



ACCESSORY LEAD-FREE WATER FAUCETS FOR TSS SERIES DECK ASSEMBLIES

Part No.	Description
926GN-LF	Deck faucet with lead-free gooseneck spout, 2.2 GPM (8.3 L/min)
926-6LF	Deck faucet with 6" lead-free swing spout, 2.2 GPM (8.3 L/min)
926-10LF	Deck faucet with 10" lead-free swing spout, 2.2 GPM (8.3 L/min)
926DJ-LF	Deck faucet with 18" lead-free double jointed swing spout, 2.2 GPM (8.3 L/min)



ACCESSORY PERLICK FLEX MOUNT LEG RELOCATION KIT

Part No.	Description
1039805	Perlick Flex Mount Leg Relocation Kit, includes rail, bolt, and tightening knob, for NEW TSF Series Equipment

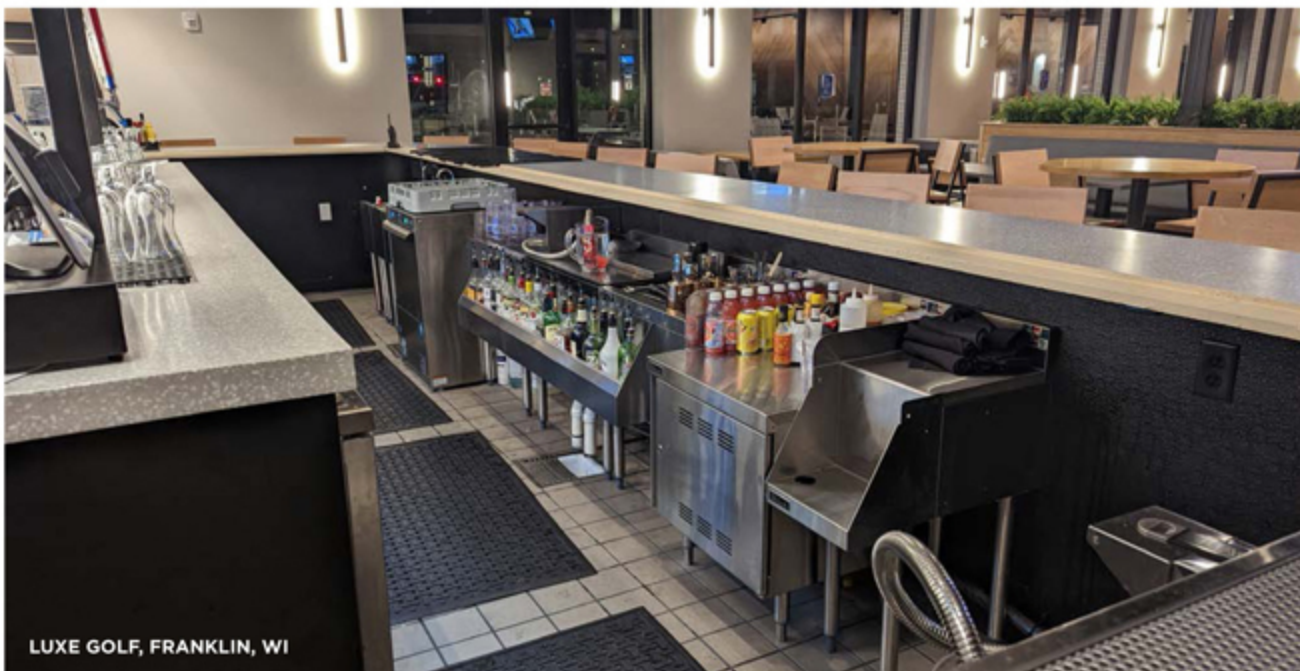

New BARTENDER PREP SINKS**TSF Series**

Part No.	Description	Width
TSF8PS-BRT	Underbar prep sink, 8" W x 24" D, with cutting board (8"W x 7.5"D), glass rinser (5" Diameter), and tool well (5.5" diameter)	8"
TSF12PS-SB	Underbar prep sink, 12" W x 24" D, with sink bowl (9.75"W x 10.5" FTB x 6" D), cutting board (12"W x 7.5"D)	12"
TSF12PS-SR	Underbar prep sink, 12" W x 24" D, with sink bowl (9.75"W x 10.5" FTB x 6" D), glass rinser (5" diameter)	12"
TSF14PS-SRT	Underbar prep sink, 14" W x 24" D, with sink bowl (9.75"W x 10.5" FTB x 6" D), glass rinser (5" Diameter), and tool well (5.5" diameter)	14"
TSF18PS-SBR	Underbar prep sink, 18" W x 24" D, with sink bowl (13.75"W x 10" FTB x 9.5" D), cutting board (11.5"W x 7.5"D), glass rinser (5" diameter)	18"
TSF20PS-SBRT	Underbar prep sink, 20" W x 24" D, with sink bowl (9.75"W x 10.5" FTB x 6" D), cutting board (20"W x 7.5"D), glass rinser (5" Diameter), and tool well (5.5" diameter)	20"
TSF24PS-SBRT	Underbar prep sink, 24" W x 24" D, with sink bowl (9.75"W x 10.5" FTB x 6" D), cutting board (11.75"W x 13"D), glass rinser (5" Diameter), and tool well (5.5" diameter)	24"



TSF8PS-BRT

Accessories for Prep Sinks

Part No.	Description
1039805	Perlick Flex Mount Leg Relocation Kit, includes rail, bolt, and tightening knob, for NEW TSF Series Equipment
GR-1K	Water pressure regulator install kit (required for this unit)



TSF18PS-SR

1039805
Perlick Flex Mount
Leg Relocation Kit



TSF20PS-SBRT



TSF24PS-SBRT



Tool well closeup shown



Sink/faucet closeup shown



New DUMP SINKS

TS Series		TSF Series		TSS Series	
Part No.	Part No.	Part No.	Part No.	Width	Ship Wt. (lbs.)
TS12DS	TSF12DS	TSS12DS		12"	45
TS18DS	N/A	N/A		18"	60



TS12DS



TSF12HS



TSF12HS Shown with New towel dispenser and hand soap dispenser design

New HAND SINKS

TSF Series		TSD Series		Soap Disp. Mounting	Towel Type	Width	Ship Wt. (lbs.)
Part No.	Part No.	Part No.	Part No.				
TSF12HS	N/A			Splash	Folded	12"	50
TSF18HS	TSD18HST			Deck	Roll paper towel	18"	60

ACCESSORIES

"Wall" Mount Water Faucets for TS Series Hand Sinks

Part No.	Description
934GN-LF	Front loading, wall/splash mount, lead-free faucet with gooseneck spout

"Deck" Mount Water Faucets for TSS Series Hand Sinks

Part No.	Description
926GN-LF	Deck faucet with lead-free gooseneck spout, 2.2 GPM (8.3 L/min)

Misc. Accessories for Hand Sinks

Part No.	Description
UAC-EFA	Faucet control, electronic, battery operated
UAC-HWFC	Faucet control, mechanical. Mounts on any faucet in minutes. <i>Simply remove the aerator and install controller to end of spout. Set the faucet handles to your desired water flow and temperature.</i>
43705	Wrist blade handles, pair, field installed (<i>not applicable on TS12HSN</i>)
67420-2*-LF	Water valve, dual pedal, foot operated, 1/2" NPT
67419-6W*-LF	Swing spout, 6", wall mounted, for use with foot operated water valve
67419-6D*-LF	Swing spout, 6", deck mounted, for use with foot operated water valve
43688A	Water conserving aerator, 0.5 GPM (1.9 L/min), field installed
43688F	Water conserving aerator, 1.5 GPM (5.7 L/min), field installed
736B	Towel ring, field installed
736BIN	Towel ring, factory installed
7055-48	Perforated wet waste pan for 12" and 18" hand sinks, stainless, 7 quart

* Applicable for TS12HS and TS12HSN only



UAC-EFA



UAC-HWFC



43705



67420-2



67419-6W



67419-6D

Touchless Faucets

Part No.	Description
946GN	Electronic hands free faucet, deck mount
944GN	Electronic hands free faucet, wall mount (<i>Includes Touchless Faucet Adapter Kit - 904-088</i>)



946GN



944GN



Touchless faucets include adapter kit - 904-088

SINKS WITH 2 TANKS

TS Series	TSD Series	Overall Width	Tank Location	Drainboard Width	Ship Wt. (lbs.)
Part No.	Part No.				
TS24M2	TSF24M2	24" (2')	Center	N/A	65

Accessory "Wall" Mount Water Faucets for TS Series 2 Tank Sinks

Part No.	Description
934-6LF	Wall faucet with 6" lead-free swing spout, 2.2 GPM (8.3 L/min)

Accessory "Deck" Mount Water Faucets for TSD and TSS Series 2 Tank Sinks

926-6LF	Deck faucet with 6" lead-free swing spout, 2.2 GPM (8.3 L/min)
---------	--

Misc. Accessory for 2 Tank Sinks

202PVC	Drain connection kit for sinks with two tanks
--------	---



TS24M2

SINKS WITH 3 TANKS

TS Series	TSF Series	Overall Width	Tank Location	Drainboard Width
Part No.	Part No.			
TS36M3	TSF36M3	36" (3')	N/A	N/A
TS48M3-DBR	TSF48M3-DBR	48" (4')	Right	12"
TS48M3-DBL	TSF48M3-DBL	48" (4')	Left	12"
TS60M3-DB	TSF60M3-DB	60" (5')	Both sides, flanked or right & left	2 @ 12"
TS72M3-DB	TSF72M3-DB	72" (6')	Both sides, flanked or right & left	2 @ 18"
TS84M3-DB	TSF84M3-DB	84" (7')	Both sides, flanked or right & left	2 @ 24"
TS96M3-DB	TSF96M3-DB	96" (8')	Both sides, flanked or right & left	2 @ 30"



TSF48M3-DBR

Accessory "Wall" Mount Water Faucets for TS Series 3 Tank Sinks

Part No.	Description
934-10LF	Wall faucet with 10" lead-free swing spout, 2.2 GPM (8.3 L/min)

Accessory "Deck" Mount Water Faucets for TSD and TSS Series 3 Tank Sinks

926-10LF	Deck faucet with 10" lead-free swing spout, 2.2 GPM (8.3 L/min)
----------	---



202PVC

26482PVC

Misc. Accessory for 3 Tank Sinks

26482PVC	Drain connection kit for sinks with three tanks
7055A46	Wet waste pan - drains into standpipe
CR-S01	California Health Code, "Integral" drainboards (for TS43L/R with one drainboard)
CR-S02	California Health Code, "Integral" drainboards (for sinks with two drainboards)

Note: Modules on this page, assembled to other modules, are custom made and cannot be returned for credit.

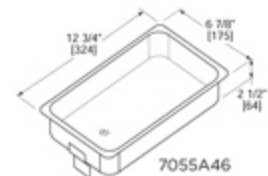

7055A46



TS60M3-DB



1039805

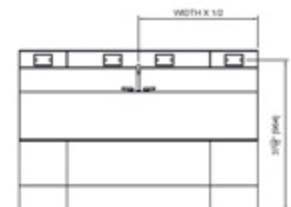
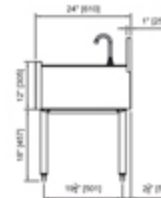

TS60M3-DB

ACCESSORY PERLICK FLEX MOUNT LEG RELOCATION KIT

Part No.	Description
1039805	Perlick Flex Mount Leg Relocation Kit, includes rail, bolt, and tightening knob, for NEW TSF Series Equipment



SINKS WITH 4 TANKS

TS Series	TSF Series	Overall Width	Tank Location	Drainboard Width	Ship Wt. (lbs.)
Part No. TS48M4	Part No. TSF48M4	48" (4')	N/A	N/A	125
TS72M4-DB	TSF72M4-DB	72" (6')	Both sides, flanked or right & left	2 @ 12"	150
TS84M4-DB	TSF84M4-DB	84" (7')	Both sides, flanked or right & left	2 @ 18"	165
TS96M4-DB	TSF96M4-DB	96" (8')	Both sides, flanked or right & left	2 @ 24"	200

Accessory "Wall" Mount Water Faucets for TS Series 4 Tank Sinks

Part No.	Description
934DJ-LF	Front loading, wall/splash mount, lead-free faucet with double jointed swing spout

Accessory "Deck" Mount Water Faucets for TSD and TSS Series 4 Tank Sinks

926DJ-LF	Deck faucet with 18" lead-free double jointed swing spout, 2.2 GPM (8.3 L/min)
----------	--

Misc. Accessory for 4 Tank Sinks

26483PVC	Drain connection kit for sinks with four tanks
7055A46	Wet waste pan - drains into standpipe
CR-S02	California Health Code, "Integral" drainboards (for sinks with two drainboards)



TS84M4-DB

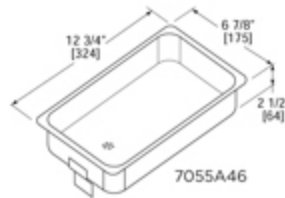

7055A46

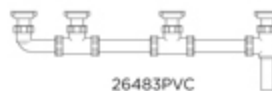

26483PVC

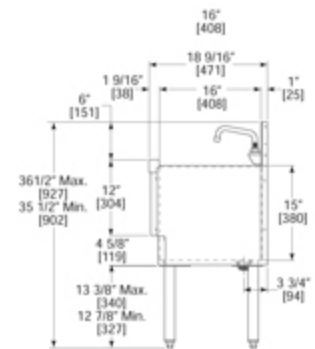

SINKS WITH EXTRA CAPACITY TANKS

These sinks have 16 1/4" long x 16" wide x 15" deep tanks to meet various regional health codes.

TS Series	TSF Series	Width	Number of Tanks	Number of Faucets Required	Ship Wt. (lbs.)
Part No. TS18M1-EC	Part No. TSF18M1-EC	18"	1	1	105
TS54M3-EC	TSF54M3-EC	54"	3	2	205

Faucets not included. Order separately.



TS18M1-EC

Accessory "Wall" Mount Water Faucets for TS Series Extra Capacity Sinks

Part No.	Description
934-6LF	Wall faucet with 6" lead-free swing spout, 2.2 GPM (8.3 L/min)

Accessory "Deck" Mount Water Faucets for TSD and TSS Series Extra Capacity Sinks

926-6LF	Deck faucet with 6" lead-free swing spout, 2.2 GPM (8.3 L/min)
---------	--



TS54M3-EC

ACCESSORY PERLICK FLEX MOUNT LEG RELOCATION KIT

Part No.	Description
1039805	Perlick Flex Mount Leg Relocation Kit, includes rail, bolt, and tightening knob, for NEW TSF Series Equipment

Perlick

NEW Perlick Storage Cabinets & Drainboards

The best bars are the perfect blend of performance and style, form and functionality. **Perlick's NEW Storage Cabinets and Drainboards** feature an ergonomic design to help bartenders be faster, more productive, safer, and profitably engaged with customers. With decades of experience laying out remarkable custom bars, we can help you create your ideal venue.

NEW stadium-shaped perforated drainboard insert, pitched drainboard top

NEW optional field reversible door

NEW Quick Clamp legs



New STORAGE BINS FOR GLASSWARE

Part No.	Description	Width	Ship Wt. (lbs.)
TSF24SC-GR	With drainboard top, perforated glass rack insert, and two glass rack shelves	24"	80



TSF24SC-GR

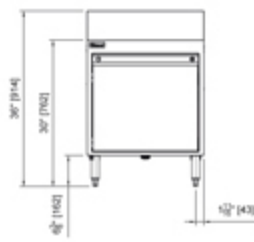

Front view storage bin

ACCESSORIES

Part No.	Description
1051837	Kit, glass rack storage cabinet, additional drain shelf and clips
1051281-1	Pan, chemical storage, storage cabinet

New STORAGE CABINETS WITH FULL DRAINBOARD TOP

TSF Series - Less Doors (includes one shelf)

Part No.	Width	Ship Wt. (lbs.)
TSF12SC*	12"	30
TSF16SC*	16"	45
TSF18SC*	18"	40
TSF24SC*	24"	80
TSF30SC*	30"	90
TSF36SC	36"	100
TSF42SC	42"	115
TSF48SC	48"	125

* Can be factory assembled to TSF12CM and TSF24CM. Specify left or right location of TSF12CM.



TSF24SC
Shown with **NEW** optional field reversible door and with glass rack insert

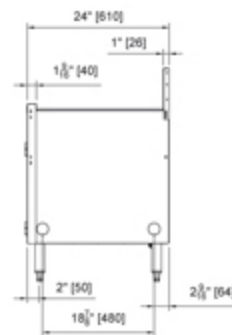

End view storage cabinet

TS Series - Less Doors (includes one shelf)

Part No.	Width	Ship Wt. (lbs.)
TS12SC	12"	24
TS18SC	18"	32
TS24SC	24"	52
TS30SC	30"	64
TS36SC	36"	80
TS42SC	42"	90
TS48SC	48"	100



TS18SC
Shown with **NEW** optional field reversible door and with glass rack insert

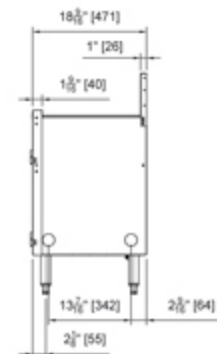

End view storage cabinet with sink



TSF18DS-TR
Shown with **NEW** optional field reversible door

New STORAGE CABINET WITH SINK AND WASTE CHUTE
Less shelf, optional door

Part No.	Width	Ship Wt. (lbs.)
TSF18DS-TR*	18"	50

* Can be factory assembled to TSF12SC, TSF16SC, TSF18SC, TSF24SC and TSF30SC. Specify left or right location of TSF12CM.

Note: Modules on this page, assembled to other modules, are custom made and cannot be returned for credit.

New DOORS FOR STORAGE CABINETS
Factory installed doors*

Part No.	Description
DR12SC	Door, 12" (left hinged, field reversible)
DR16SC	Door, 16" (left hinged, field reversible)
DR18SC	Door, 18" (left hinged, field reversible)
DR24SC	Door, 24" (left hinged, field reversible)
DR30SC	Door set for 30" cabinet
DR36SC	Door set for 36" cabinet
DR42SC	Door set for 42" cabinet
DR48SC	Door set for 48" cabinet

MISCELLANEOUS

Part No.	Description
SC-ES	End splash (specify left or right location)

LIQUOR STEP CABINETS

Four steps provide ample space to display liquor bottles.

Part No.	Width	Ship Wt. (lbs)
DBLS-18	18"	130
DBLS-24	24"	145
DBLS-30	30"	160

GLASS STORAGE CABINETS

Includes three sound-deadening stainless steel adjustable shelves.

Part No.	Width	Ship Wt. (lbs)
DBGS-18	18"	140
DBGS-24	24"	160
DBGS-30	30"	180

STORAGE CABINETS (Width x 24-3/4" Deep x 34-9/16")

All models are made from stainless steel and are specially designed to complement our entire back bar line.

**CUSTOMER OPTIONS****LOCKING COVER FOR DB CABINETS***

Width	Part No.	Part No.
18"	DB-LC18	DB-LC18-R
24"	DB-LC24	DB-LC24-R
30"	DB-LC30	DB-LC30-R

BOTTLE GUARDS*

Width	Part No.	Part No.
18"	DB-BG18	DB-BG18-R
24"	DB-BG24	DB-BG24-R
30"	DB-BG30	DB-BG30-R

* "-R" suffix for Field Installed

LED LIGHT KIT FOR DBGS, DBLS CABINETS*

Cool white LED (4200k) light strip, 12V DC with integrated on/off switch. 100-240VAC transformer with 2-prong wall plug included. **Warranty: LED lamp - 3 years parts, transformer - 1 year parts.**

Part No.	Width	# of LEDs	Watts	Amps
DB-CWL18	18"	24	3.76	0.31
DB-CWL24	24"	36	5.64	0.47
DB-CWL30	30"	36	5.64	0.47



DB-BG24
Accessory bottle guard

ADDITIONAL ACCESSORIES

Description	Part No.	DBGS-18/ DBLS-18	Part No.	DBGS-24/DBLS-24 DBMP-24/DBSW-24	Part No.	DBGS-30/DBLS-30
4" leg and black front baseplate	66320-108SS-4		66320-24SS-4		66320-30SS-4	
4" black end baseplate	66320SS-4		66320SS-4		66320SS-4	
6" leg and black front baseplate	66320-108SS		66320-24SS		66320-30SS	
6" black end baseplate	66320SS		66320SS		66320SS	
Legs 4" - 5-3/4" (Set of four)	57933		57933		57933	
Legs 6" - 7-1/2" (Set of four)	57782		57782		57782	
Legs 6"-9" (Set of four)	67075		67075		67075	



POS CABINETS
 ("TSF" DEPTH) - LESS DOOR

Part No.	Width	Ship Wt. (lbs.)
TSF18POS	18"	45
TSF24POS	24"	65

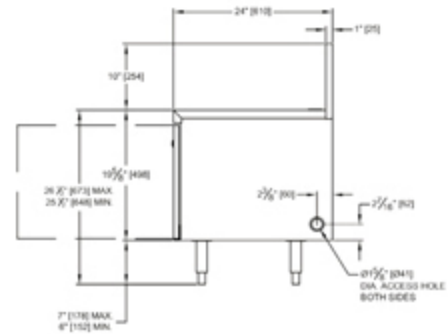

ACCESSORIES FOR POS CABINETS

Factory installed doors*

Part No.	Description
POS-DR18L-R	Door, 18" (specify left or right hinging)
POS-DR24L-R	Door, 24" (specify left or right hinging)
POS-DRLK	Door lock
POS-DRLK-R	Door lock

* = "R" for right hinged door

END SPLASH

Part No.	Description
POS-ESL	End splash (specify left or right location)

CHEMICAL STORAGE CABINETS WITH SINK (24" DEEP)

Part No.	Description	Width
TSF24CM	Glass storage and chemical cabinet with sink and spray hose	24"

Part No.	Description	Width
New TSF12CM	Chemical cabinet with sink and spray hose	12"

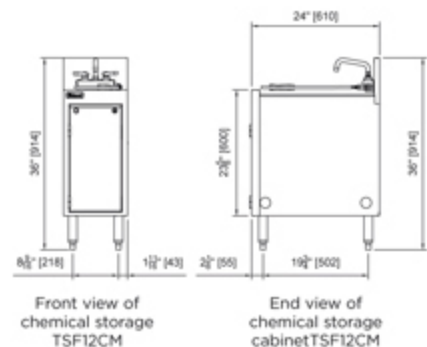
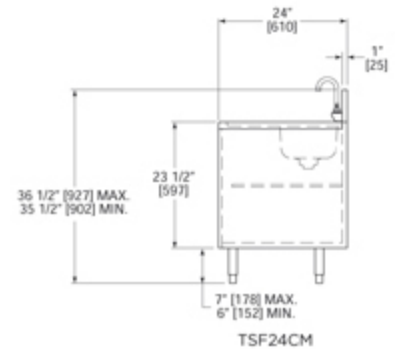

LIQUOR DISPLAY CABINET

Part No.	Width	Ship Wt. (lbs.)
TS12LS	12"	40
TS18LS	18"	45
TS24LS	24"	50

ACCESSORIES

Part No.	Description
BG12	Bottle guardrail set for TS12LS
BG18	Bottle guardrail set for TS18LS
BG24	Bottle guardrail set for TS24LS

*Add R suffix for field installed

LOCKING COVERS FACTORY AND FIELD INSTALLED

Part No.	Description
LC12*	Locking cover for TS12LS
LC18*	Locking cover for TS18LS
LC24*	Locking cover for TS24LS

*Add -R suffix for field installed



TS12LS
(With BG12
bottle guards)

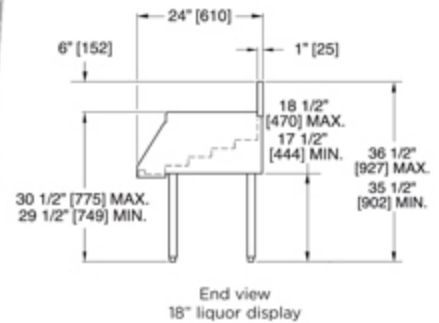

PHOTO: AC HOTEL BY MARRIOTT, MINNEAPOLIS

UNDERBAR BEER DRAINER

TS Series		TSD Series		Description	Ship Wt. (lbs.)
Part No.	Part No.	Part No.	Part No.		
7055A8	7055D8	7055D8	7055D8	18" drainer for four faucets	30
7055A9	7055D9	7055D9	7055D9	24" drainer for six faucets	40

ACCESSORIES

Part No.	Description
63262	Pair of legs for beer drainers

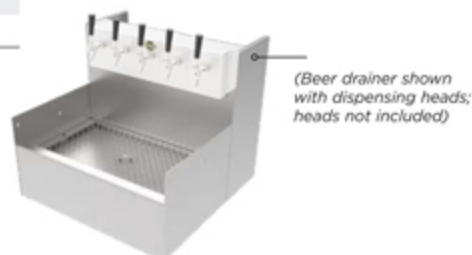

7055D9

63262
Pair of legs for
beer drainers



BRIDGE TRASH

Requires support by adjacent underbar equipment or accessory end panel and leg kit.

TSF Series		
Part No.	Width	Ship Wt. (lbs.)
TSF12BTB	12"	25

MISC. ACCESSORIES FOR BRIDGE TRASH

Part No.	Description
BTB-PL	End panel and pair of legs (specify left or right, one side only)
BTB-ES	End splash, TSF (specify left or right)
57265	Wastebasket, grey (11" L x 20" W x 30" H)



TSF12BTB

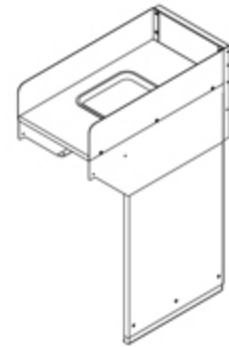

TRASH RECEPTACLE

Requires support by adjacent underbar equipment or accessory panel and leg kit.

Part No.	Width	Ship Wt.(lbs.)
TS12TRA	12"	35

MISC. ACCESSORIES FOR TS12TRA TRASH RECEPTACLE

Part No.	Description
TRA-PL	Panel leg (specify left or right, one side only)
57265	Wastebasket, grey (11" L x 20" W x 30" H)



TS12TRA

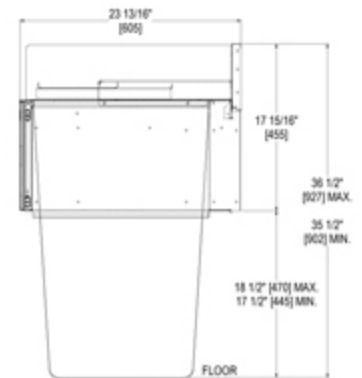

End view trash receptacle

APRON TRASH CUT-OUT FOR TRASH RECEPTACLE

Specify location left and/or right. Available on multi-tank sinks with 12" drainboards only.

Part No.	Width
TR12CO*	12"

*Not applicable on Modular Bar

MISC. ACCESSORY FOR APRON TRASH CUT-OUT

Part No.	Description
58643	Wastebasket, grey (11" L x 15 1/4" W x 19-7/8" H)

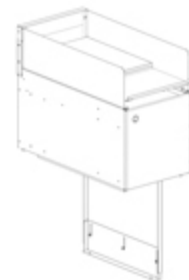

TRA-PL Panel Leg Kit



TSF60M3-DBL and TR12CO

New CORNER FILLER SECTIONS WITH DRAINBOARD TOP

TS Series		TSF Series	
Part No.	Part No.	Angle	Description
Inside Corners			
TS45D-FI*	TSF45D-FI*	45°	Drainboard, full corner, inside
TS90D-FI	TSF90D-FI	90°	Drainboard, full corner, inside
TS90TC	TSF90TC	90°	Drainboard, trim corner, inside

New DRAINBOARD, FULL CORNER, OUTSIDE

TS Series		TSF Series	
Part No.	Part No.	Angle	Description
TS45D-FO*	TSF45D-FO*	45°	Drainboard, full corner, outside

MISC. ACCESSORIES FOR CORNER FILLER SECTIONS WITH DRAINBOARD TOPS

Part No.	Description
*63555	Pair of legs for one side of 45°, 60°, and 75° corner filler sections

Note: Equipment legs are included on 90° corner filler sections.

ACCESSORY PERLICK FLEX MOUNT LEG RELOCATION KIT

Part No.	Description
1039805	Perlick Flex Mount Leg Relocation Kit, includes rail, bolt, and tightening knob, for NEW TSF Series Equipment

New CORNER DRAINBOARDS

TS Series		TSF Series		Width	Splash Location	Ship Wt. (lbs.)
Part No.	Part No.	Width	Splash Location			
Inside Corners						
TS90LIC	TSF90D-I	24"	Left corner			55
TS90RIC	TSF90D-I	24"	Right corner			55

Note: Equipment legs are included on corner drainboards.

CORNER FILLER SECTIONS WITH FLAT TOP

TS Series		TSF Series		Angle	Description
Part No.	Part No.	Angle	Description		
TS05F-I	TSF05F-I	5°	Flat top, clip corner, inside		
TS10F-I	TSF10F-I	10°	Flat top, clip corner, inside		
TS15F-I	TSF15F-I	15°	Flat top, clip corner, inside		
TS20F-I	TSF20F-I	20°	Flat top, clip corner, inside		
TS25F-I	TSF25F-I	25°	Flat top, clip corner, inside		
TS30F-I	TSF30F-I	30°	Flat top, clip corner, inside		
TS45F-I	TSF45F-I	45°	Flat top, clip corner, inside		
TS60F-I	TSF60F-I	60°	Flat top, clip corner, inside		
TS90F-I	TSF90F-I	90°	Flat top, clip corner, inside		

OUTSIDE CORNER

TSF Series		
Part No.	Angle	Description
TSF15F-O	15°	Flat top, clip corner, outside
TSF20F-O	20°	Flat top, clip corner, outside
TSF25F-O	25°	Flat top, clip corner, outside

CORNER FILLER END PANEL AND LEG KIT ACCESSORIES FOR CORNER FILLER SECTIONS WITH FLAT TOP

TS Series		TSF Series	
Part No.	Part No.	Description	
TS-CEL-L	TSF-CEL-L	Corner filler end panel and leg kit, left side	
TS-CEL-R	TSF-CEL-R	Corner filler end panel and leg kit, right side	

Note: Order side panel accessory (TSF-CEL-L/R) for installation of TSF flat top next to TS equipment.



TS45D-FI



TS45D-FO



TSF90TC



TSF90D-FI



TS90LIC



TS90RIC

TS20F-I
Shown with TS-CEL-L

SPEED RAIL OPTIONS

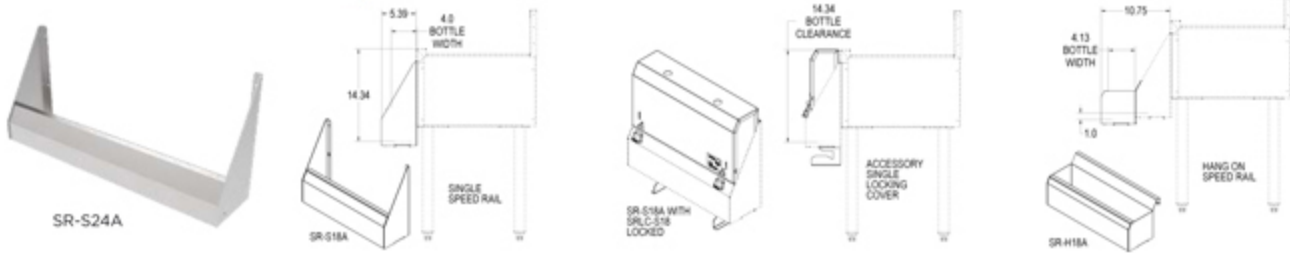

Single Speed Rails*

Part No.	Width
SR-S12A	12"
SR-S13A	13"
SR-S14A	14"
SR-S15A	15"
SR-S16A	16"
SR-S17A	17"
SR-S18A	18"
SR-S19A	19"
SR-S20A	20"
SR-S21A	21"
SR-S22A	22"
SR-S23A	23"
SR-S24A	24"
SR-S28A	28"
SR-S30A	30"
SR-S34A	34"
SR-S36A	36"
SR-S42A	42"
SR-S48A	48"
SR-S54A	54"
SR-S60A	60"
SR-S72A	72"

*Add "R" suffix for field installed

Accessory Single Locking Cover*

Part No.	Width
SRLC-S12	12"
SRLC-S13	13"
SRLC-S14	14"
SRLC-S15	15"
SRLC-S16	16"
SRLC-S17	17"
SRLC-S18	18"
SRLC-S19	19"
SRLC-S20	20"
SRLC-S21	21"
SRLC-S22	22"
SRLC-S23	23"
SRLC-S24	24"
SRLC-S28	28"
SRLC-S30	30"
SRLC-S34	34"
SRLC-S36	36"
SRLC-S42	42"
SRLC-S48	48"
SRLC-S54	54"
SRLC-S60	60"
SRLC-S72	72"

*Add "R" suffix for field installed

Hang-on Speed Rails*

Part No.	Width
SR-H12A	12"
SR-H13A	13"
SR-H14A	14"
SR-H15A	15"
SR-H16A	16"
SR-H17A	17"
SR-H18A	18"
SR-H19A	19"
SR-H20A	20"
SR-H21A	21"
SR-H22A	22"
SR-H23A	23"
SR-H24A	24"
SR-H28A	28"
SR-H30A	30"
SR-H34A	34"
SR-H36A	36"

*Add "R" suffix for field installed

Note: These are made from combinations of two smaller speed rail covers

Dual Speed Rails*

Part No.	Width
SR-D12A	12"
SR-D13A	13"
SR-D14A	14"
SR-D15A	15"
SR-D16A	16"
SR-D17A	17"
SR-D18A	18"
SR-D19A	19"
SR-D20A	20"
SR-D21A	21"
SR-D22A	22"
SR-D23A	23"
SR-D24A	24"
SR-D28A	28"
SR-D30A	30"
SR-D34A	34"
SR-D36A	36"
SR-D42A	42"
SR-D48A	48"

*Add "R" suffix for field installed

Note: Locking covers include cover only. Order speed rail separately.

Accessory Dual Locking Cover*

Part No.	Width
SRLC-D12	12"
SRLC-D13	13"
SRLC-D14	14"
SRLC-D15	15"
SRLC-D16	16"
SRLC-D17	17"
SRLC-D18	18"
SRLC-D19	19"
SRLC-D20	20"
SRLC-D21	21"
SRLC-D22	22"
SRLC-D23	23"
SRLC-D24	24"
SRLC-D28	28"
SRLC-D30	30"
SRLC-D34	34"
SRLC-D36	36"
SRLC-D42	42"
SRLC-D48	48"

*Add "R" suffix for field installed

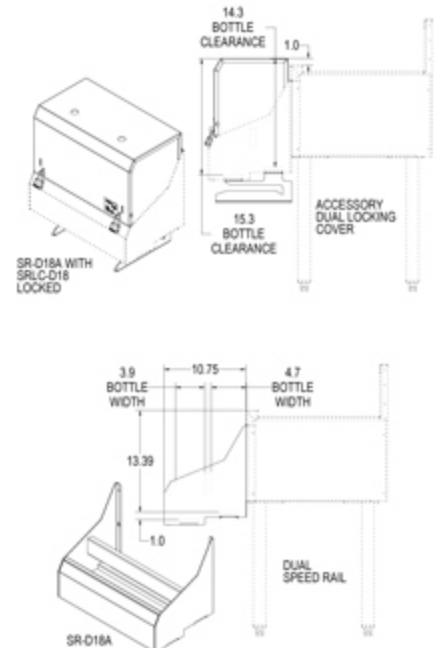

DRINK RAIL DRAINERS

Easily mounts to underbar top, creating a perfect assembly area for the bartender while protecting your valuable bar surface.

Part No.	Width	Ship Wt. (lbs.)
DRD12	12"	5
DRD18	18"	7
DRD24	24"	9
DRD30	30"	12
DRD36	36"	14
DRD42	42"	16
DRD48	48"	18

Part No.	Angle	Description
DRD90-I	90°	Corner filler, 90°, inside
DRD45-I	45°	Corner filler, 45°, inside
DRD90-O	90°	Corner filler, 90°, outside
DRD45-O	45°	Corner filler, 45°, outside

Misc. Accessories

Part No.	Description
1390D	1/2" I.D. vinyl drain tube, antimicrobial



DRD90-I



DRD45-I



DRD90-O



DRD45-O

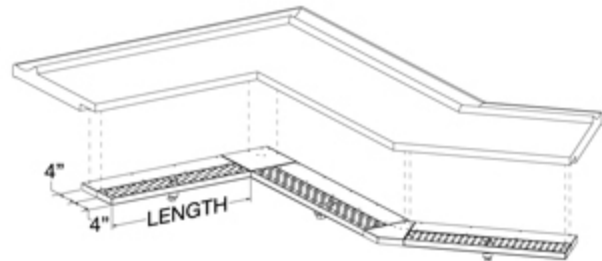
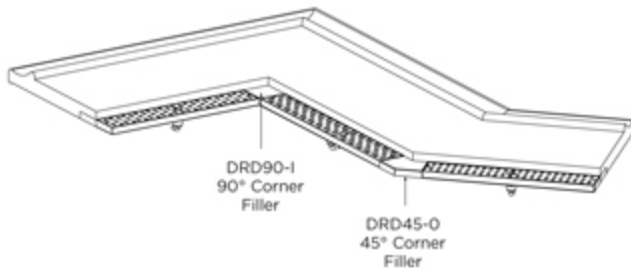

DRINK RAIL RINSERS

Part No.	Width	Ship Wt. (lbs.)
DRR6	6"	7

SERVICE STATION DROP-IN DRAINERS

Service station drop-in drainers provide a flush mounted, draining, stainless steel work surface. Designed for installation into a cut-out opening in the bar.

12" Deep Drop-in Drainers

Part No.	Overall Dimensions
RDP12x24	12" x 24"
RDP12x30	12" x 30"
RDP12x36	12" x 36"
RDP12x42	12" x 42"
RDP12x48	12" x 48"

18" Deep Drop-in Drainers

Part No.	Overall Dimensions
RDP18x24	18" x 24"
RDP18x30	18" x 30"
RDP18x36	18" x 36"
RDP18x42	18" x 42"
RDP18x48	18" x 48"

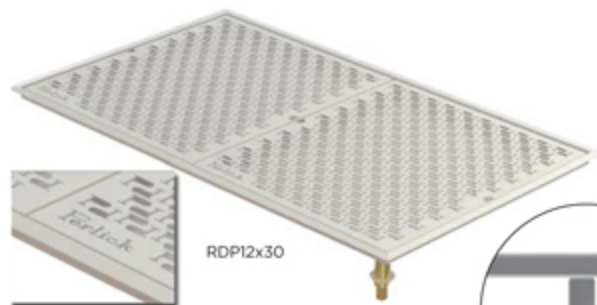
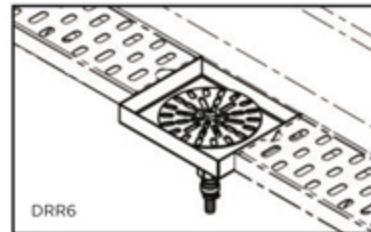

RDP12x30



WARNING: California Prop 65 Notice
See page 6 for details.



PLUMBING ACCESSORIES

Part No.	Description
43688A	Water conserving aerator, 0.5 GPM (1.9 L/min), field installed
43688F	Water conserving aerator, 1.5 GPM (5.7 L/min), field installed
43705	Wrist blade handles, pair, field installed (not applicable on TS12HSN)
54965-1	Drain screen for 1-1/2" drain socket
54965-2	Crumb cup for 1-1/2" drain socket
43385R	Basin tubes, pair, 3/8" for deck faucets



TOWEL RING

Part No.	Description
736B	Towel ring, field installed
736BIN	Towel ring, factory installed



LEG KITS AND FOOT INSERTS

Part No.	Description
63555	Pair of leg and mounting plates, 17-1/2" to 18-1/2" long
63555-2	Pair of leg and mounting plates, 13-1/2" to 14-1/2" long
63249HR	"High rise" foot insert, 3" height adjustment
63247	"Flanged foot" insert, 1" height adjustment
7860-18A	Leg kit, (4) 6" x 7" w/3" square mounting flange



CONNECTOR KIT

Part No.	Description
7055-45	Underbar field connection kit



WET WASTE PANS

Part No.	Description
7055-52	Perforated wet waste pan for 12" and 14" blenders, clear plastic, 2.7 quart
7055-48	Perforated wet waste pan for 18" blender, stainless steel, 7 quart
7055A46	Wet waste pan - drains into standpipe

SIDE SPLASH GUARDS

Part No.	Description
7054L	Side splash guard, left, TS and TSD applications
7054R	Side splash guard, right, TS and TSD applications
7054SL	Side splash guard, left, TSS applications
7054SR	Side splash guard, right, TSS applications

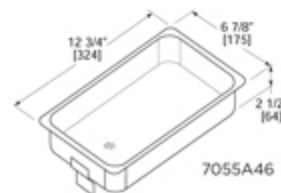
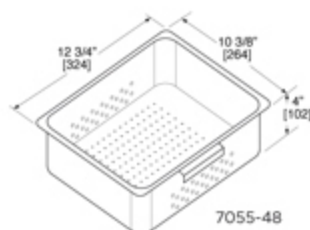
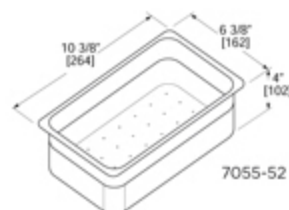

TS12DS shown with 934-6LF goose neck faucet, 7054L/7054R side splashes, and 7055-48 stainless steel wet waste pan



ACCESSORY PERLICK FLEX MOUNT LEG RELOCATION KIT

Part No.	Description
1039805	Perlick Flex Mount Leg Relocation Kit, includes rail, bolt, and tightening knob, for NEW TSF Series Equipment

ACCESS CUTOUTS FOR TS SERIES

Part No.	Description
7055-265A*	Backsplash cutout for soda lines

* Not applicable on TSD or modular bar

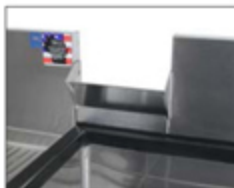

7055-265A
Backsplash cutout
for soda lines



BLENDER PLATFORMS

Part No.	Width	Description
7055-118	12"	Blender platform with one junction box and duplex outlet
7055-119	18"	Blender platform with two junction boxes and duplex outlets
7055-124	24"	Blender platform with two junction boxes and duplex outlets



TS24M2 shown with
7055-124 blender platform

BOTTLE OPENER/CAP RECEIVER & WASTE RECEPTACLE

Part No.	Description
7055-50	Bottle opener and cap receiver, field installed
7055-50IN	Bottle opener and cap receiver, factory installed



7055-50



WARNING: California Prop 65 Notice
See page 6 for details.



American Barsystems EK · Phone 0049 (0)231 108 77 99 0 · Fax 0049 (0)231 108 77 99
americanbarsystem@t-online.de · www.americanbarsystem.de · www.perlick.com

PERLICK COLUMN WINE RESERVES

Go vertical to find space to expand your wine offering

HIGH CAPACITY, SMALL FOOTPRINT

Don't let limited square footage limit your wine list. By expanding up, you'll have plenty of space to create an impressive offering of fine vintages.

- **Precise temperature and dynamic humidity controls** ensure ideal conditions for proper maturation
- **Carbon air filtration keeps air purified** and free from damaging odors
- **Stainless interior for maximum durability** and restaurant-standard cleanliness
- **Triple-pane UV glass door protects wine from light** exposure that can cause oxidation
- **Environmentally friendly** hydrocarbon refrigeration system reduces your carbon footprint by up to 99%
- **84" tall, 24" x 24" footprint** provides **high capacity wine storage** in a compact space
- **Single and dual-zone models available**
- **Programmable blue and white LED interior lighting** with slow fade effect for on and off setting



PerliQ - State-of-the-art digital touch screen provides precise control over all wine column functions.



Convertible Display Shelf - In display mode, it showcases your finest vintages. In standard flat mode, it maximizes storage capacity.

See page 81 for more information and pricing.

Contact Perlick to learn more
Perlick.com | 800.558.5592

BASE MODELS

Choose between all black, all stainless, or factory laminated exterior options. Interior of cabinet is all stainless steel with a galvanized steel back. Includes choice of white or blue LED light, left or right compressor location, door lock, and is ANSI/NSF#7-certified for open food storage. Comes with a 5 year compressor and 1 year parts and labor warranty.



eco friendly
R290 Hydrocarbon
Refrigerant

SINGLE DOOR (36" Long x 24-3/4" Deep x 34-9/16" High)

Part No.	Net Capacity	Amps	HP
BBS36	7.4 cu. ft.	1.8	1/6

THREE DOOR (84" Long x 24-3/4" Deep x 34-9/16" High)

Part No.	Net Capacity	Amps	HP
BBS84	24.8 cu. ft.	4.2	1/4

TWO DOOR (60" Long x 24-3/4" Deep x 34-9/16" High)

Part No.	Net Capacity	Amps	HP
BBS60	16.0 cu. ft.	2.5	1/5

FOUR DOOR (108" Long x 24-3/4" Deep x 34-9/16" High)

Part No.	Net Capacity	Amps	HP
BBS108	33.5 cu. ft.	4.2	1/4



BBS36



BBS60



BBS84



BBS108

CUSTOMER OPTIONS

Each cabinet is configured specifically to the customer's request. The following is pricing on each individual option.

TEMPERATURE OPTION

Model No.	Refrigerator Temp.	Wine Temp.
ALL MODELS		

* Wine temperature not approved for open food storage

EXTERIOR FINISH COLOR (No charge) Coming Soon

- **ALL BLACK**
Black vinyl top, sides, condensing cover and doors, with black PVD coated stainless steel handles
- **STAINLESS STEEL**
Stainless steel top, sides, condensing cover and doors
- **FACTORY LAMINATED***
Select your favorite option from 13 different laminate manufacturers, including Wilson Art, Treefrong, Lab Design, Fermica, Decostone, and more! **Laminate option to be specified with customer service after order is submitted.**

TOP TYPE

Choose dispensing kits to pair with any back bar refrigerator. BBS units can have tapping holes drilled in factory or left for field drilling. Pricing for laminate reflects labor charge to install selected laminate type; additional charges will apply based on material selection.

# of Doors	No Tapping (Standard)	Tapping Included	Factory Laminated*
1			
2			
3			
4			

DOOR TYPE (All models - per door)

Specify the door type beginning from left to right and indicate left or right hinging. For laminated doors, provide your laminate choice by indicating the manufacturer's name and the number and description of the laminate. **Prices listed are for labor to install selected laminate only.**

Finish	Coming Soon
Solid	
Glass	
Refrigerator drawers	
Wine drawers	
Liquor drawers	

LED LIGHT OPTION

Model No.	White LED	Light Blue LED
ALL MODELS		



HANDLE OPTIONS (All models)

Handle Type
Full length, stainless steel, 24", door
Full length, stainless steel, 16", drawer

FINISHED ENDS (Optional - all models)

End Style
Match exterior finish - left or right
Match exterior finish - both

SHELVING STYLES (All models - per door)

Shelving Style
Flat shelving
Flat with cutout for floor access
Divider shelves
Divider with cutout for floor access
Wine racks
Full extension wine shelves (set of 6) (69508)

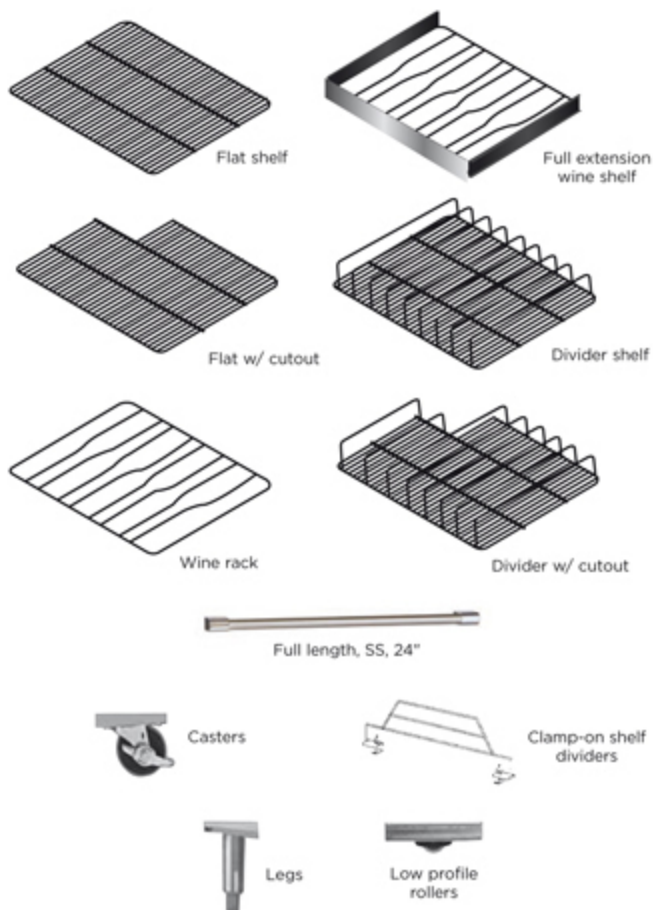

SECOND YEAR EXTENDED PARTS AND LABOR WARRANTY

Part No.	Description
730	Second year extended parts and labor warranty

ADDITIONAL ACCESSORIES

Accessory (Part No.)	BBS36	BB5560	BBS84	BBS108
4" leg and black front baseplate	68704-36	68704-60	68704-84 (Set of 6)	68704-108 (Set of 6)
4" black end baseplate	68704-22	68704-22	68704-22	68704-22
6" leg and black front baseplate	68703-36	68703-60	68703-84 (Set of 6)	68703-108 (Set of 6)
6" black end baseplate	68703-22	68703-22	68703-22	68703-22
Casters 3-3/4"	57786	57786	57787 (Set of 6)	57787 (Set of 6)
Casters 2-7/8"	67061	67061	67062 (Set of 6)	67062 (Set of 6)
Casters 6-1/8"	57784	57784	57785 (Set of 6)	57785 (Set of 6)
Low profile rollers 1-5/8"	63771A	63771A	63771A-2 (Set of 6)	63771A-2 (Set of 6)
Legs 4"- 5-3/4"	57933	57933	57934 (Set of 6)	57934 (Set of 6)
Legs 6"- 7-1/2"	57782	57782	57783 (Set of 6)	57783 (Set of 6)
Legs 6"- 9"	67075	67075	67076 (Set of 6)	67076 (Set of 6)
Clamp-on shelf dividers	C5090-48BL	C5090-48BL	C5090-48BL	C5090-48BL
Floor access (must select cutout shelving listed above)	63054	63054	63054	63054

See page 78 for dispensing heads and tapping accessories for back bar cabinets.

BASE MODEL

Choose between all black, all stainless, or factory laminated exterior options. Interior of cabinet is all stainless steel with a galvanized steel back. Can be set to two separate temperatures (one per door), perfect for storing red and white wine at their appropriate temperatures. Includes choice of white or blue LED light, left or right compressor location, door lock, and is ANSI/NSF#7-certified for open food storage. Comes with a 5 year compressor and 1 year parts and labor warranty.



eco friendly
R290 Hydrocarbon
Refrigerant

SINGLE DOOR (36" Long x 24-3/4" Deep x 34-9/16" High)

Part No.	Net Capacity	Amps	HP
DZS36	7.1 cu. ft.	1.8	1/6



DZS36 Door-Tapping



DZS60 Drawer-Tapping

TWO DOOR (60" Long x 24-3/4" Deep x 34-9/16" High)

Part No.	Net Capacity	Amps	HP
DZS60	15.0 cu. ft.	2.5	1/5



DZS60 Drawer-Drawer



DZS60 Door-Tapping

CUSTOMER OPTIONS

Each cabinet is configured specifically to the customer's request. The following is pricing on each individual option.

TEMPERATURE OPTION**Settings**

Refrigerator - wine (red) [36°F to 60°F]

Refrigerator - wine (white) [36°F to 45°F]

Wine (white) - wine (red) [45°F to 60°F]

* Wine temperature not approved for open food storage

EXTERIOR FINISH COLOR (No charge)**Coming Soon**

- **ALL BLACK**
Black vinyl top, sides, condensing cover and doors, with black PVD coated stainless steel handles
- **STAINLESS STEEL**
Stainless steel top, sides, condensing cover and doors
- **FACTORY LAMINATED***
Select your favorite option from 13 different laminate manufacturers, including Wilson Art, Treefrong, Lab Design, Fermica, Decostone, and more! **Laminate option to be specified with customer service after order is submitted.**

TOP TYPE

Choose dispensing kits to pair with any dual zone unit. DZS units can 36 units are dispensing only, choose one dispensing kit per zone. Pricing for laminate reflects labor charge to install selected laminate type; additional charges will apply based on material selection.

# of Doors/ Part No.	No Tapping (Standard)	Tapping Included	Factory Laminated*
1 - DZS36			
2 - DZS60			

DOOR TYPE (All models - per door)

Specify the door type beginning from left to right and indicate left or right hinging. For laminated doors, provide your laminate choice by indicating the manufacturer's name and the number and description of the laminate. **Prices listed are for labor to install selected laminate only.**

Finish**Coming Soon**

Solid

Glass

Refrigerator drawers

Wine drawers

LED LIGHT OPTION (DZS60 only)

Model No.	White LED	Blue LED
ALL MODELS		



HANDLE OPTIONS (All models)

Handle Type

- Full length, stainless steel, 24", door
- Full length, stainless steel, 16", drawer
- Stainless steel 12", door

FINISHED ENDS (Optional - all models)

End Style

- Match exterior finish - left or right
- Match exterior finish - both

SHELVING STYLES (All models - per door) (DZS60 ONLY)

Shelving Style

- Flat shelving
- Flat with cutout for floor access
- Divider shelves
- Divider with cutout for floor access
- Wine racks
- Full extension wine shelves (Set of 6)

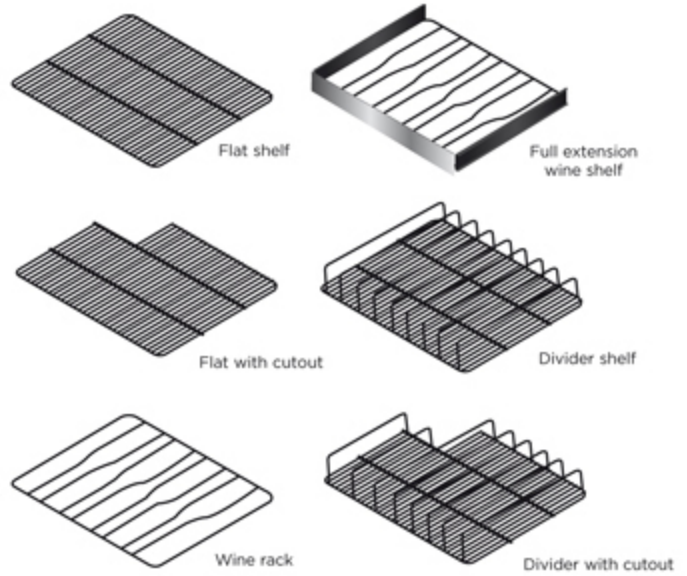

SECOND YEAR EXTENDED PARTS AND LABOR WARRANTY

Part No. Description

- | | |
|-----|---|
| 730 | Second year extended parts and labor warranty |
|-----|---|

ADDITIONAL ACCESSORIES

Accessory	Part No.	DZS36	DZS60
4" leg and black front baseplate	68704-36		
4" black end baseplate	68704-22		
6" leg and black front baseplate	68703-36		
6" black end baseplate	68703-22		
Casters 3-3/4"	57786		
Casters 2-7/8"	67061		
Casters 6-1/8"	57784		
Low profile rollers 1-5/8"	63771A		
Legs 4"- 5-3/4"	57933		
Legs 6"- 7-1/2"	57782		
Legs 6"- 9"	67075		
Clamp-on shelf dividers	C5090-48BL		
Floor access (must select cutout shelving listed above)	63054		

See page 78 for dispensing heads and tapping accessories for back bar cabinets.

LOW-HEIGHT 29" SINGLE-ZONE CABINETS WITH SELF-CONTAINED REFRIGERATION

BASE MODELS

Choose between all black, all stainless, or factory laminated exterior options. Interior of cabinet is all stainless steel with a galvanized steel back. Includes choice of white or blue LED light, left or right compressor location, door lock, and is ANSI/NSF#7-certified for open food storage. Comes with a 5 year compressor and 1 year parts and labor warranty.



eco friendly
R290 Hydrocarbon
Refrigerant

SINGLE DOOR (36" Long x 24-3/4" Deep x 29" High)

Part No.	Net Capacity	Amps	HP
BBSLP36	6.2	1.8	1/6

THREE DOOR (84" Long x 24-3/4" Deep x 29" High)

Part No.	Net Capacity	Amps	HP
BBSLP84	20.7	4.2	1/4

TWO DOOR (60" Long x 24-3/4" Deep x 29" High)

Part No.	Net Capacity	Amps	HP
BBSLP60	13.3	2.5	1/5

FOUR DOOR (108" Long x 24-3/4" Deep x 29" High)

Part No.	Net Capacity	Amps	HP
BBSLP108	27.9	4.2	1/4



BBSLP36



BBSLP60



BBSLP84



BBSLP108

CUSTOMER OPTIONS

Each cabinet is configured specifically to the customer's request. The following is pricing on each individual option.

TEMPERATURE OPTION

Model No.	Refrigerator Temp.	Wine Temp.
ALL MODELS		

* Wine temperature not approved for open food storage

EXTERIOR FINISH COLOR (No charge)

Coming Soon

- **ALL BLACK**
Black vinyl top, sides, condensing cover and doors, with black PVD coated stainless steel handles
- **STAINLESS STEEL**
Stainless steel top, sides, condensing cover and doors
- **FACTORY LAMINATED***
Select your favorite option from 13 different laminate manufacturers, including Wilson Art, Treefrong, Lab Design, Fermica, Decostone, and more! *Laminate option to be specified with customer service after order is submitted.*

TOP TYPE

Pricing for laminate reflects labor charge to install selected laminate type; additional charges will apply based on material selection.

# of Doors	No Tapping (Standard)	Tapping Included	Factory Laminated*
1			
2			
3			
4			

DOOR TYPE (All models - per door)

Specify the door type beginning from left to right and indicate left or right hinging. For laminated doors, provide your laminate choice by indicating the manufacturer's name and the number and description of the laminate. *Prices listed are for labor to install selected laminate only.*

Finish	Coming Soon
Solid	
Glass	

LED LIGHT OPTION

Model No.	White LED	Blue LED
ALL MODELS		



American Barsystems EK · Phone 0049 (0)231 108 77 99 0 · Fax 0049 (0)231 108 77 99
americanbarsystem@t-online.de · www.americanbarsystem.de · www.perlick.com

HANDLE OPTIONS (All models)

Handle Type
Full length, stainless steel, 24", door

FINISHED ENDS (Optional - all models)

End Style
Match exterior finish - left or right
Match exterior finish - both

SHELVING STYLES (All models - per door)

Shelving style
Flat shelving
Flat with cutout for floor access
Divider shelves
Divider with cutout for floor access*
Wine racks
Full extension wine shelves (set of 4)

* Not available on 36" unit

SECOND YEAR EXTENDED PARTS AND LABOR WARRANTY

Part No.	Description
730	Second year extended parts and labor warranty

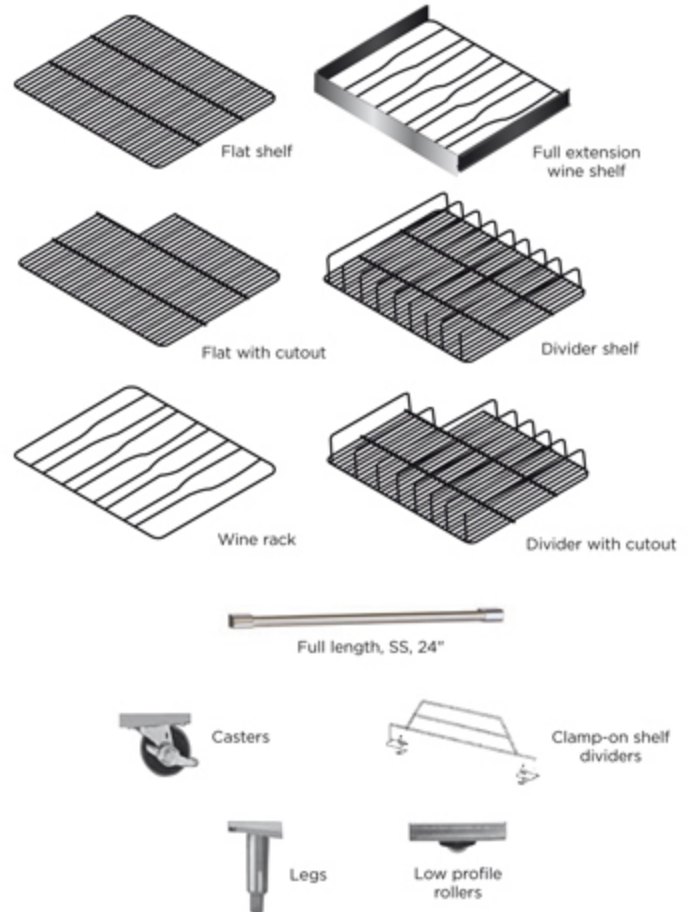

ADDITIONAL ACCESSORIES

Accessory (Part No.)	BBSLP36	BBSLP60	BBSLP84	BBSLP108
4" leg and black front baseplate	68704-36	68704-60	68704-84 (Set of 6)	68704-108 (Set of 6)
4" black end baseplate	68704-22	68704-22	68704-22	68704-22
6" leg and black front baseplate	68703-36	68703-60	68703-84 (Set of 6)	68703-108 (Set of 6)
6" black end baseplate	68703-22	68703-22	68703-22	68703-22
Casters 3-3/4"	57786	57786	57787 (Set of 6)	57787 (Set of 6)
Casters 2-7/8"	67061	67061	67062 (Set of 6)	67062 (Set of 6)
Casters 6-1/8"	57784	57784	57785 (Set of 6)	57785 (Set of 6)
Low profile rollers 1-5/8"	63771A	63771A	63771A-2 (Set of 6)	63771A-2 (Set of 6)
Legs 4"- 5-3/4"	57933	57933	57934 (Set of 6)	57934 (Set of 6)
Legs 6"- 7-1/2"	57782	57782	57783 (Set of 6)	57783 (Set of 6)
Legs 6"- 9"	67075	67075	67076 (Set of 6)	67076 (Set of 6)
Anti tip casters (one drawer) 3-3/4"	57786AT	N/A	N/A	N/A
Anti tip casters (one drawer) 6-1/4"	57784AT	N/A	N/A	N/A
Clamp-on shelf dividers	C5090-48BL	C5090-48BL	C5090-48BL	C5090-48BL
Floor access (must select cutout shelving listed above)	63054	63054	63054	63054

BASE MODELS

Choose between all black, all stainless, or factory laminated exterior options. Interior of cabinet is all stainless steel with a galvanized steel back. Includes choice of white or blue LED light, left or right compressor location, door lock, and is ANSI/NSF#7-certified for open food storage. Comes with a 5 year compressor and 1 year parts and labor warranty.



eco friendly
R290 Hydrocarbon
Refrigerant

SINGLE DOOR (32" Long x 24-3/4" Deep x 34-9/16" High)

Part No.	Net Capacity	Amps	HP
BBSN32	6.0 cu. ft.	1.8	1/6

TWO DOOR (52" Long x 24-3/4" Deep x 34-9/16" High)

Part No.	Net Capacity	Amps	HP
BBSN52	13.3 cu. ft.	2.5	1/5

THREE DOOR (72" Long x 24-3/4" Deep x 34-9/16" High)

Part No.	Net Capacity	Amps	HP
BBSN72	20.6 cu. ft.	4.2	1/4

FOUR DOOR (92" Long x 24-3/4" Deep x 34-9/16" High)

Part No.	Net Capacity	Amps	HP
BBSN92	27.8 cu. ft.	4.2	1/4



BBSN32



BBSN52



BBSN72



BBSN92

CUSTOMER OPTIONS

Each cabinet is configured specifically to the customer's request. The following is pricing on each individual option.

TEMPERATURE OPTION

Model No.	Refrigerator Temp.	Wine Temp.
ALL MODELS		

* Wine temperature not approved for open food storage

EXTERIOR FINISH COLOR (No charge)

Coming Soon

- **ALL BLACK**
Black vinyl top, sides, condensing cover and doors, with black PVD coated stainless steel handles
- **STAINLESS STEEL**
Stainless steel top, sides, condensing cover and doors
- **FACTORY LAMINATED***
Select your favorite option from 13 different laminate manufacturers, including Wilson Art, Treefrong, Lab Design, Fermica, Decostone, and more! **Laminate option to be specified with customer service after order is submitted.**

TOP TYPE

Choose dispensing kits to pair with any back bar refrigerator. BBSN units can have tapping holes drilled in factory or left for field drilling. Pricing for laminate reflects labor charge to install selected laminate type; additional charges will apply based on material selection.

# of Doors	No Tapping (Standard)	Tapping Included	Factory Laminated*
1			
2			
3			
4			

DOOR TYPE (All models - per door)

Specify the door type beginning from left to right and indicate left or right hinging. For laminated doors, provide your laminate choice by indicating the manufacturer's name and the number and description of the laminate. **Prices listed are for labor to install selected laminate only.**

Finish	Coming Soon	List Price
Solid		
Glass		

LED LIGHT OPTION

Model No.	White LED	Blue LED
ALL MODELS		



HANDLE OPTIONS (All models)

Handle Type
Full length, stainless steel, 24", door

FINISHED ENDS (Optional - all models)

End Style
Match exterior finish - left or right
Match exterior finish - both

SHELVING STYLES (All models - per door)

Shelving Style
Flat shelving
Flat with cutout for floor access
Divider shelves
Wine racks*

SECOND YEAR EXTENDED PARTS AND LABOR WARRANTY

Part No.	Description
730	Second year extended parts and labor warranty

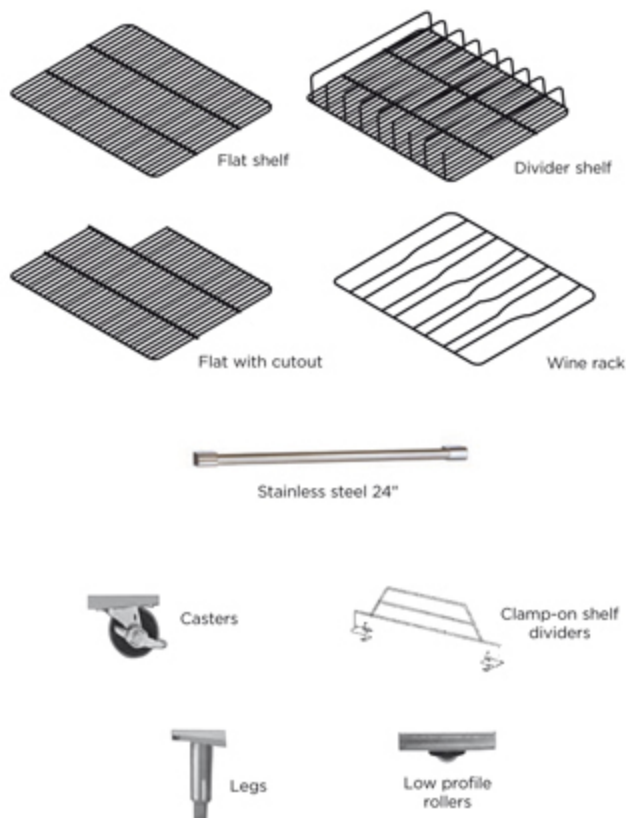

ADDITIONAL ACCESSORIES

Accessory (Part No.)	BBSN32	List	BBSN52	BBSN72	BBSN92
4" leg and black front baseplate	68704-32		68704-52	68704-72 (Set of 6)	68704-92 (Set of 6)
4" black end baseplate	68704-22		68704-22	68704-22	68704-22
6" leg and black front baseplate	68703-32		68703-52	68703-72 (Set of 6)	68703-92 (Set of 6)
6" black end baseplate	68703-22		68703-22	68703-22	68703-22
Casters 3-3/4"	57786		57786	57787 (Set of 6)	57787 (Set of 6)
Casters 2-7/8"	67061		67061	67062 (Set of 6)	67062 (Set of 6)
Casters 6-1/8"	57784		57784	57785 (Set of 6)	57785 (Set of 6)
Low profile rollers 1-5/8"	63771A		63771A	63771A-2 (Set of 6)	63771A-2 (Set of 6)
Legs 4"- 5-3/4"	57933		57933	57934 (Set of 6)	57934 (Set of 6)
Legs 6"- 7-1/2"	57782		57782	57783 (Set of 6)	57783 (Set of 6)
Legs 6"- 9"	67075		67075	67076 (Set of 6)	67076 (Set of 6)

See page 78 for dispensing heads and tapping accessories for back bar cabinets.

BASE MODELS

Choose between all black, all stainless, or factory laminated exterior options. Interior of cabinet is all stainless steel with a galvanized steel back. Includes choice of white or blue LED light, left or right compressor location, door lock, and is ANSI/NSF#7-certified for open food storage. Comes with a 5 year compressor and 1 year parts and labor warranty.

TWO DOOR (60" Long x 24-3/4" Deep x 34-9/16" High)

Part No.	Net Capacity	Amps	HP
SDBS60	14.8 cu. ft.	2.5	1/5

FOUR DOOR (108" Long x 24-3/4" Deep x 34-9/16" High)

Part No.	Net Capacity	Amps	HP
SDBS108	30.9 cu. ft.	4.2	1/4



SDBS60



eco friendly
R290 Hydrocarbon
Refrigerant



SDBS108

CUSTOMER OPTIONS

Each cabinet is configured specifically to the customer's request. The following is pricing on each individual option. All cabinets come with glass sliding doors.

TEMPERATURE OPTION

Model No.	Refrigerator Temp.	Wine Temp.
ALL MODELS		

* Wine temperature not approved for open food storage

EXTERIOR FINISH COLOR (No charge) Coming Soon

- **ALL BLACK**
Black vinyl top, sides, condensing cover and doors
- **STAINLESS STEEL**
Stainless steel top, sides, condensing cover and doors
- **FACTORY LAMINATED***
Select your favorite option from 13 different laminate manufacturers, including Wilson Art, Treefrong, Lab Design, Fermica, Decostone, and more! *Laminate option to be specified with customer service after order is submitted.*

TOP TYPE

# of Doors	No Tapping	Factory Laminated*
2		
4		

LED LIGHT OPTION

Model No.	White LED	Blue LED
ALL MODELS		

FINISHED ENDS (Optional - all models)

End Style
Match exterior finish - left or right
Match exterior finish - both

SECOND YEAR EXTENDED PARTS AND LABOR WARRANTY

Part No.	Description
730	Second year extended parts and labor warranty

SHELVING STYLES (All models - per door)

Shelving Style
Flat shelving
Wine racks*

* Not available for center compartment on 4-door models

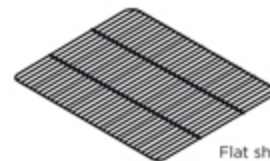

Flat shelf

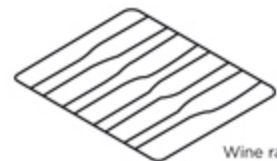

Wine rack

ADDITIONAL ACCESSORIES

Accessory	SDBS60	SDBS108
4" leg and black front baseplate	(Set of 6)	
4" black end baseplate		
6" leg and black front baseplate	(Set of 6)	
6" black end baseplate		
Casters 3-3/4"	(Set of 6)	
Casters 2-7/8"	(Set of 6)	
Casters 6-1/8"	(Set of 6)	
Low profile rollers 1-5/8"	(Set of 6)	
Legs 4"- 5-3/4"	(Set of 6)	
Legs 6"- 7-1/2"	(Set of 6)	
Legs 6"- 9"	(Set of 6)	
Clamp-on shelf dividers		



Casters

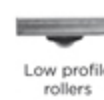

Legs

Low profile
rollersClamp-on shelf
dividers

BASE MODELS

Choose between all black, all stainless, or factory laminated exterior options. Interior of cabinet is all stainless steel with a galvanized steel back. Includes choice of white or blue LED light, left or right compressor location, door lock, and is ANSI/NSF#7-certified for open food storage. Comes with a 5 year compressor and 1 year parts and labor warranty.



eco friendly
R290 Hydrocarbon
Refrigerant

TWO DOOR (60" Long x 26-11/16" Deep x 34-9/16" High)

Part No.	Net Capacity	Amps	HP
SDPS60	14.8 cu. ft.	2.5	1/5



SDPS60

CUSTOMER OPTIONS

Each cabinet is configured specifically to the customer's request. The following is pricing on each individual option. All cabinets come with glass sliding doors.

TEMPERATURE OPTION

Model No.	Refrigerator Temp.	Wine Temp.
ALL MODELS		

* Wine temperature not approved for open food storage

EXTERIOR FINISH COLOR (No charge) Coming Soon

- **ALL BLACK**
Black vinyl top, sides, condensing cover and doors
- **STAINLESS STEEL**
Stainless steel top, sides, condensing cover, and doors
- **FACTORY LAMINATED***
Select your favorite option from 13 different laminate manufacturers, including Wilson Art, Treefrong, Lab Design, Fermica, Decostone and more! **Laminate option to be specified with customer service after order is submitted.**

TOP TYPE

Model No.	Stainless Steel	Factory Laminated*
ALL MODELS		

LED LIGHT OPTION

Model No.	White LED	Blue LED
ALL MODELS		

*2 required for pass-thru cabinets

FINISHED ENDS (Optional - all models)

End Style
Match exterior finish - left or right
Match exterior finish - both

SECOND YEAR EXTENDED PARTS AND LABOR WARRANTY

Part No.	Description
730	Second year extended parts and labor warranty

SHELVING STYLES (All models - per door)

Shelving Style
Flat Shelving
Wine Racks

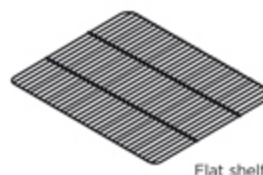

Flat shelf

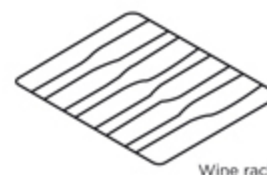

Wine rack

ADDITIONAL ACCESSORIES

Accessory	
4" legs and stainless steel baseplates	68704P-60
6" legs and stainless steel baseplates	68703P-60
Legs 4"- 5-3/4"	57933
Legs 6"- 7-1/2"	57782
Legs 6"- 9"	67075
Clamp-on shelf dividers	C5090-48BL

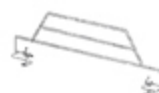

Clamp-on shelf dividers



Legs

See page 78 for dispensing heads and tapping accessories for back bar cabinets.

BASE MODELS

Choose between all black, all stainless, or factory laminated exterior options. Interior of cabinet is all stainless steel with a galvanized steel back. Includes choice of white or blue LED light, left or right compressor location, door lock, and is ANSI/NSF#7-certified for open food storage. Includes a 5 year compressor and 1 year parts and labor warranty.



eco friendly
R290 Hydrocarbon
Refrigerant

TWO DOOR (36" Long x 26-11/16" Deep x 34-9/16" High)

Part No.	Net Capacity	Amps	HP
PTS36	8.0 cu. ft.	1.8	1/6

SIX DOOR (84" Long x 26-11/16" Deep x 34-9/16" High)

Part No.	Net Capacity	Amps	HP
PTS84	26.7 cu. ft.	4.2	1/4

FOUR DOOR (60" Long x 26-11/16" Deep x 34-9/16" High)

Part No.	Net Capacity	Amps	HP
PTS60	17.4 cu. ft.	2.5	1/5



PTS36



PTS60



PTS84

CUSTOMER OPTIONS

Each cabinet is configured specifically to the customer's request. The following is pricing on each individual option.

TEMPERATURE OPTION

Model No.	Refrigerator Temp.	Wine Temp.
ALL MODELS		

* Wine temperature not approved for open food storage

EXTERIOR FINISH COLOR (No charge)**Coming Soon**

- **ALL BLACK**
Black vinyl top, sides, condensing cover and doors with black PVD coated stainless steel handles
- **STAINLESS STEEL**
Stainless steel top, sides, condensing cover, and doors
- **FACTORY LAMINATED***
Select your favorite option from 13 different laminate manufacturers, including Wilson Art, Treefrong, Lab Design, Fermica, Decostone, and more! **Laminate option to be specified with customer service after order is submitted.**

TOP TYPE

# of Doors	No Tapping (Standard)	Tapping Included	Factory Laminated*
2	no charge	no charge	
4	no charge	no charge	
6	no charge	no charge	

DOOR TYPE (Front and rear, all models - specify left or right hinge, per door)

Prices listed are for labor to install selected laminate only.

Finish	Coming Soon
Solid	
Glass	

LED LIGHT OPTION

Model No.	White LED	Blue LED
ALL MODELS	no charge	

*2 required for Pass-thru cabinets



ATLANTA AIRPORT CONCOURSE, ATLANTA, GA



American Barsystems EK · Phone 0049 (0)231 108 77 99 0 · Fax 0049 (0)231 108 77 99
americanbarsystem@t-online.de · www.americanbarsystem.de · www.perlick.com

DOOR HANDLE OPTIONS (Front and rear, all models)

Handle Type

Full length, stainless steel, 24"

Stainless steel, 12"

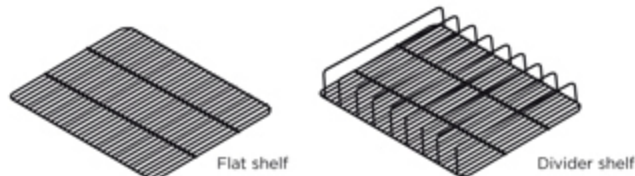

FINISHED ENDS (Optional - all models)

End Style

Match exterior finish - left or right

Match exterior finish - both

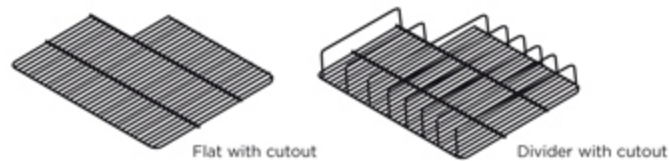

SHELVING STYLES (All models - per door)

Shelving Style

Flat shelving

Flat with cutout for floor access

Wine racks

Divided shelves

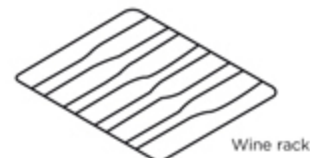

SECOND YEAR EXTENDED PARTS AND LABOR WARRANTY

Part No. Description

730 Second year extended parts and labor warranty



ADDITIONAL ACCESSORIES

Accessory (Part No.)	PTS36	PTS60	PTS84
4" leg and black baseplate (4 sides) Configurator pulls in: 68704-84 (445) + 68704-22 X 2 (310)	68704P-36	68704P-60	68704P-84 (Set of 6)
6" leg and black baseplate (4 sides) Configurator pulls in: 68703-84 (465) + 68703-22 X 2 (318)	68703P-36	68703P-60	68703P-84 (Set of 6)
Legs 4"- 5-3/4"	57933	57933	57934 (Set of 6)
Legs 6"- 7-1/2"	57782	57782	57783 (Set of 6)
Legs 6"- 9"	67075	67075	67076 (Set of 6)
Clamp-on shelf dividers	C5090-48BL	C5090-48BL	C5090-48BL
Floor access (must select cutout shelving listed above)	63054	63054	63054

See page 78 for dispensing heads and tapping accessories for back bar cabinets.

BASE MODELS

Choose between all black, all stainless, or factory laminated exterior options. Interior of cabinet is all stainless steel with a galvanized steel back. Includes choice of white or blue LED light, door lock, and is ANSI/NSF#7-certified for open food storage. Comes with a 1 year parts and labor warranty on all components other than the refrigeration system.



SINGLE DOOR (24" Long x 24-3/4" Deep x 34-9/16" High)

Part No.	Net Capacity	Amps	BTU/Hr
BBR24	7.0 cu. ft.	1.1	900

TWO DOOR (48" Long x 24-3/4" Deep x 34-9/16" High)

Part No.	Net Capacity	Amps	BTU/Hr
BBR48	15.3 cu. ft.	1.6	1900

THREE DOOR (72" Long x 24-3/4" Deep x 34-9/16" High)

Part No.	Net Capacity	Amps	BTU/Hr
BBR72	23.9 cu. ft.	2.0	2300

FOUR DOOR (96" Long x 24-3/4" Deep x 34-9/16" High)

Part No.	Net Capacity	Amps	BTU/Hr
BBR96	32.6 cu. ft.	2.5	2300



BBR24



BBR48



BBR72



BBR96

CUSTOMER OPTIONS

Each cabinet is configured specifically to the customer's request. The following is pricing on each individual option.

EXPANSION VALVES

Choose between three factory installed expansion valves compatible with a range of refrigerant options:

1539	R134A, R401A, R12
4541	R22, R407A, R407C, R407F, R448A, R449
63552	R404A, R507, R507, R402A
No Expansion Valves	Customer to provide per site conditions

FACTORY INSTALLED THERMOSTAT

Refrigerator Temperature	White Wine Temperature	Red Wine Temperature
--------------------------	------------------------	----------------------

EXTERIOR FINISH COLOR (No charge)

Coming Soon

- ALL BLACK**
Black vinyl top, sides, condensing cover and doors, with black PVD coated stainless steel handles
- STAINLESS STEEL**
Stainless steel top, sides, condensing cover and doors
- FACTORY LAMINATED***
Select your favorite option from 13 different laminate manufacturers, including Wilson Art, Treefrong, Lab Design, Fermica, Decostone, and more! *Laminate option to be specified with customer service after order is submitted.*

DOOR TYPE (All models - per door)

Specify the door type beginning from left to right and indicate left or right hinging. For laminated doors, provide your laminate choice by indicating the manufacturer's name and the number and description of the laminate. **Prices listed are for labor to install selected laminate only.**

Finish	Coming Soon
Solid	
Glass	

TOP TYPE

Pricing for laminate reflects labor charge to install selected laminate type; additional charges will apply based on material selection.

# of Doors	No Tapping (Standard)	Tapping Included	Factory Laminated*
1			
2			
3			
4			

LED LIGHT OPTION

Model No.	White LED	Blue LED
ALL MODELS		



DOOR HANDLE OPTIONS (All models)

Handle Type
Full length, stainless steel, 24"
Stainless steel, 12"

FINISHED ENDS (Optional - all models)

End Style
Match exterior finish - left or right
Match exterior finish - both

SHELVING STYLES (All models - per door)

Shelving Style
Flat shelving
Flat with cutout for floor access*
Wine racks
Divided shelves
Divider with cutout for floor access*
Full extension wine shelves (Set of 5)

* Not available with BBR24

SECOND YEAR EXTENDED PARTS AND LABOR WARRANTY

Part No.	Description
730	Second year extended parts and labor warranty

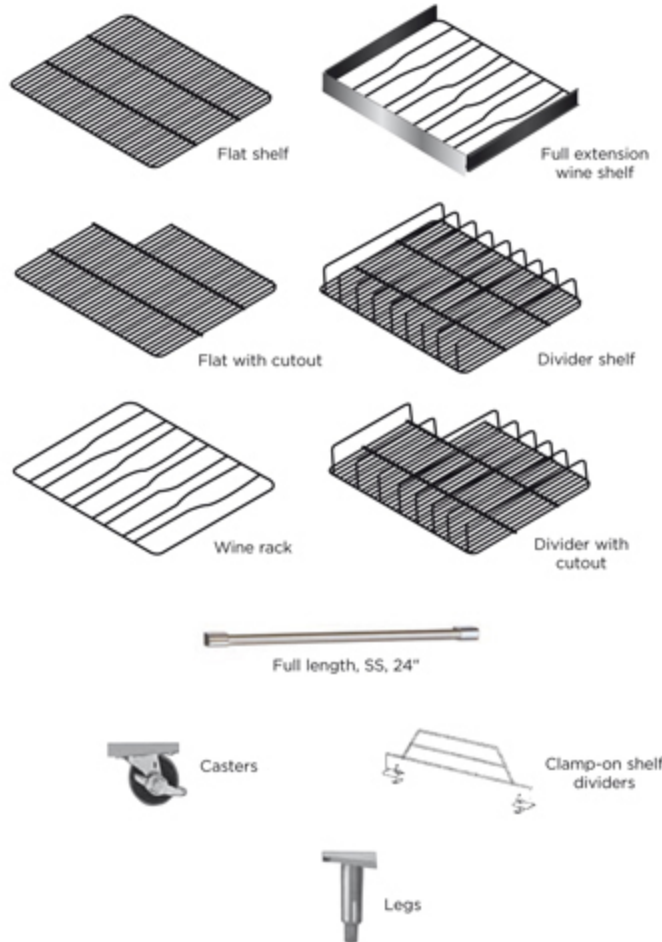

ADDITIONAL ACCESSORIES

Accessory	BBR24	BBR48	BBR72	BBR96
4" leg and black front baseplate	68704-24	68704-48	68704-72	68704-96
4" black end baseplate	68704-22	68704-22	68704-22	68704-22
6" leg and black front baseplate	68703-24	68703-48	68703-72	68703-96
6" black end baseplate	68703-22	68703-22	68703-22	68703-22
Legs 4"- 5-3/4"	57933	57933	57934 (Set of 6)	57934 (Set of 6)
Legs 6"- 7-1/2"	57782	57782	57783 (Set of 6)	57783 (Set of 6)
Legs 6"- 9"	67075	67075	67076 (Set of 6)	67076 (Set of 6)
Clamp-on shelf dividers	C5090-48BL	C5090-48BL	C5090-48BL	C5090-48BL
Floor access (must select cutout shelving listed above)	63054	63054	63054	63054
Right line cover	N/A	68646A-48R	68646A-72R	68646A-96R

LOW-HEIGHT 29" SINGLE-ZONE CABINETS WITH REMOTE REFRIGERATION

BASE MODELS

Choose between all black, all stainless, or factory laminated exterior options. Interior of cabinet is all stainless steel with a galvanized steel back. Includes choice of white or blue LED light, door lock, and is ANSI/NSF#7-certified for open food storage. Includes a 1 year parts and labor warranty on all components other than the refrigeration.



TWO DOOR (48" Long x 24-3/4" Deep x 29" High)

Part No.	Net Capacity	Amps	BTU/HR
BBRLP48	12.6	1.6	1900

FOUR DOOR (96" Long x 24-3/4" Deep x 29" High)

Part No.	Net Capacity	Amps	BTU/HR
BBRLP96	27.0	2.5	2300

THREE DOOR (72" Long x 24-3/4" Deep x 29" High)

Part No.	Net Capacity	Amps	BTU/HR
BBRLP72	19.8	2.0	2300



BBRLP48



BBRLP72



BBRLP96

CUSTOMER OPTIONS

Each cabinet is configured specifically to the customer's request. The following is pricing on each individual option.

EXPANSION VALVES

Choose between three factory installed expansion valves compatible with a range of refrigerant options:

1539	R134A, R401A, R12
4541	R22, R407A, R407C, R407F, R448A, R449
63552	R404A, R507, R507, R402A
No Expansion Valves	Customer to provide per site conditions

FACTORY INSTALLED THERMOSTAT

Refrigerator Temperature	White Wine Temperature	Red Wine Temperature
N/A		

EXTERIOR FINISH COLOR (No charge)

Coming Soon

- ALL BLACK**
Black vinyl top, sides, condensing cover and doors, with black PVD coated stainless steel handles
- STAINLESS STEEL**
Stainless steel top, sides, condensing cover and doors
- FACTORY LAMINATED***
Select your favorite option from 13 different laminate manufacturers, including Wilson Art, Treefrong, Lab Design, Fermica, Decostone, and more! *Laminate option to be specified with customer service after order is submitted.*

DOOR TYPE (All models - per door)

Specify the door type beginning from left to right and indicate left or right hinging. For laminated doors, provide your laminate choice by indicating the manufacturer's name and the number and description of the laminate. **Prices listed are for labor to install selected laminate only.**

Finish	Coming Soon
Solid	
Glass	

TOP TYPE

Pricing for laminate reflects labor charge to install selected laminate type; additional charges will apply based on material selection.

# of Doors	Stainless Steel	Factory Laminated*
2		
3		
4		

LED LIGHT OPTION

Model No.	White LED	Blue LED
ALL MODELS		



HANDLE OPTIONS (All models)

Handle Type
Full Length, SS, 24", Door
SS, 12", Door

FINISHED ENDS (Optional - all models)

End Style
Match exterior finish - left or right
Match exterior finish - both

SHELVING STYLES (All models - per door)

Shelving Style
Flat shelving
Flat with cutout for floor access
Wine racks
Divider shelves
Divider with cutout for floor access
Full extension wine shelves (Set of 3)

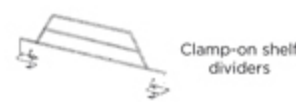
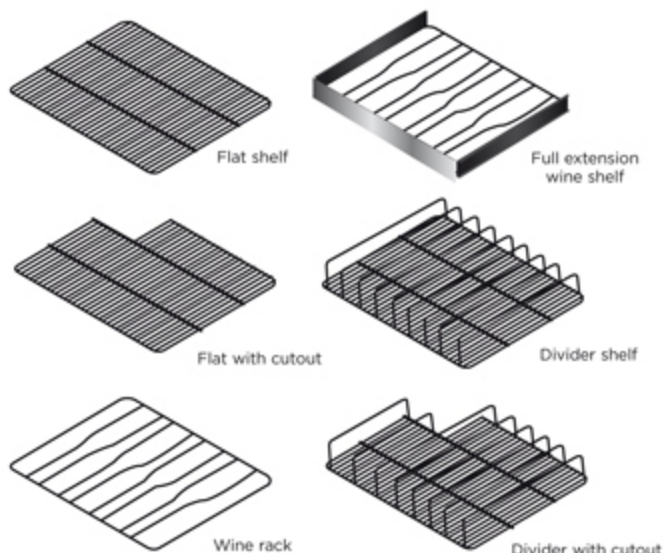

SECOND YEAR EXTENDED PARTS AND LABOR WARRANTY

Part No.	Description
730	Second year extended parts and labor warranty

ADDITIONAL ACCESSORIES

Accessory (Part No.)	BBRLP48	BBRLP72	BBRLP96
4" leg and black front baseplate	68704-48	68704-72	68704-96
4" black end baseplate	68704-22	68704-22	68704-22
6" leg and black front baseplate	68703-48	68703-72	68703-96
6" black end baseplate	68703-22	68703-22	68703-22
Legs 4"- 5-3/4"	57933	57934 (Set of 6)	57934 (Set of 6)
Legs 6"- 7-1/2"	57782	57783 (Set of 6)	57783 (Set of 6)
Legs 6"- 9"	67075	67076 (Set of 6)	67076 (Set of 6)
Clamp-on shelf dividers	C5090-48BL	C5090-48BL	C5090-48BL
Floor access (must select cutout shelving listed above)	63054	63054	63054
Right line cover	68646A-48R	68646A-72R	68646A-96R

BASE MODELS

Choose between all black, all stainless, or factory laminated exterior options. Interior of cabinet is all stainless steel with a galvanized steel back. Includes choice of white or blue LED light, door lock, and is ANSI/NSF#7-certified for open food storage. Comes with 1 year parts and labor warranty on all components other than the refrigeration system.



TWO DOOR (40" Long x 24-3/4" Deep x 34-9/16" High)

Part No.	Net Capacity	Amps	BTU/Hr
BBRN40	12.0 cu. ft.	1.6	1900

FOUR DOOR (80" Long x 24-3/4" Deep x 34-9/16" High)

Part No.	Net Capacity	Amps	BTU/Hr
BBRN80	26.8 cu. ft.	2.5	2300

THREE DOOR (60" Long x 24-3/4" Deep x 34-9/16" High)

Part No.	Net Capacity	Amps	BTU/Hr
BBRN60	19.0 cu. ft.	2.0	2300



BBRN40



BBRN60



BBRN80

CUSTOMER OPTIONS

Each cabinet is configured specifically to the customer's request. The following is pricing on each individual option.

EXPANSION VALVES

Choose between three factory installed expansion valves compatible with a range of refrigerant options:

1539	R134A, R401A, R12
4541	R22, R407A, R407C, R407F, R448A, R449
63552	R404A, R507, R507, R402A
No Expansion Valves	Customer to provide per site conditions

FACTORY INSTALLED THERMOSTAT

Refrigerator Temperature	White Wine Temperature	Red Wine Temperature
N/A		

EXTERIOR FINISH COLOR (No charge)

Coming Soon

- **ALL BLACK**
Black vinyl top, sides, condensing cover and doors, with black PVD coated stainless steel handles
- **STAINLESS STEEL**
Stainless steel top, sides, condensing cover and doors
- **FACTORY LAMINATED***
Select your favorite option from 13 different laminate manufacturers, including Wilson Art, Treefrong, Lab Design, Fermica, Decostone, and more! **Laminate option to be specified with customer service after order is submitted.**

DOOR TYPE (All models - per door)

Specify the door type beginning from left to right and indicate left or right hinging. For laminated doors, provide your laminate choice by indicating the manufacturer's name and the number and description of the laminate. **Prices listed are for labor to install selected laminate only.**

Finish	Coming Soon
Solid	no charge
Glass	

TOP TYPE

Pricing for laminate reflects labor charge to install selected laminate type; additional charges will apply based on material selection.

# of Doors	No Tapping (Standard)	Tapping Included	Factory Laminated*
2	no charge	N/A	
3	no charge	no charge	
4	no charge	no charge	

LED LIGHT OPTION

Model No.	White LED	Blue LED
ALL MODELS	no charge	



DOOR HANDLE OPTIONS (All models)

Handle Type
Full length, stainless steel, 24"
Stainless steel, 12"

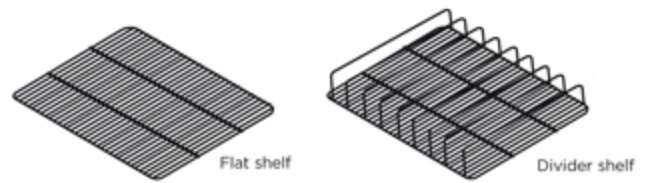

FINISHED ENDS (Optional - all models)

End Style
Match exterior finish - left or right
Match exterior finish - both



SHELVING STYLES (All models - per door)

Shelving Style
Flat shelving
Wine racks
Divided shelves



SECOND YEAR EXTENDED PARTS AND LABOR WARRANTY

Part No.	Description
730	Second year extended parts and labor warranty

ADDITIONAL ACCESSORIES

Accessory (Part No.)	BBRN40	BBRN60	BBRN80
4" leg and black front baseplate	68704-40	68704-60	68704-80
4" black end baseplate	68704-22	68704-22	68704-22
6" leg and black front baseplate	68703-40	68703-60	68703-80
6" black end baseplate	68703-22	68703-22	68703-22
Legs 4"- 5-3/4"	57933	57934 (Set of 6)	57934 (Set of 6)
Legs 6"- 7-1/2"	57782	57783 (Set of 6)	57783 (Set of 6)
Legs 6"- 9"	67075	67076 (Set of 6)	67076 (Set of 6)
Clamp-on shelf dividers	C5090-48BL	C5090-48BL	C5090-48BL
Floor access (must select cutout shelving listed above)	63054	63054	63054
Right line cover	N/A	68646A-60R	68646A-80R

See page 78 for dispensing heads and tapping accessories for back bar cabinets.

BASE MODELS

Choose between all black, all stainless, or factory laminated exterior options. Interior of cabinet is all stainless steel with a galvanized steel back. Includes choice of white or blue LED light, door lock, and is ANSI/NSF#7-certified for open food storage. Comes with 1 year parts and labor warranty on all components other than the refrigeration system.



SDBR48



SDBR96

TWO DOOR (48" Long x 24-3/4" Deep x 34-9/16" High)

Part No.	Net Capacity	Amps	BTU/Hr
SDBR48	14.8 cu. ft.	1.6	1900

FOUR DOOR (96" Long x 24-3/4" Deep x 34-1/2" High)

Part No.	Net Capacity	Amps	BTU/Hr
SDBR96	30.9 cu. ft.	2.5	2300

CUSTOMER OPTIONS

Each cabinet is configured specifically to the customer's request. The following is pricing on each individual option. All cabinets come with glass sliding doors.

EXPANSION VALVES

Choose between three factory installed expansion valves compatible with a range of refrigerant options:

1539	R134A, R401A, R12
4541	R22, R407A, R407C, R407F, R448A, R449
63552	R404A, R507, R507, R402A
No Expansion Valves	Customer to provide per site conditions

FACTORY INSTALLED THERMOSTAT

Refrigerator Temperature	White Wine Temperature	Red Wine Temperature
N/A		

EXTERIOR FINISH COLOR (No charge)**Coming Soon**

- **ALL BLACK**
Black vinyl top, sides, condensing cover and doors, with black PVD coated stainless steel handles
- **STAINLESS STEEL**
Stainless steel top, sides, condensing cover and doors
- **FACTORY LAMINATED***
Select your favorite option from 13 different laminate manufacturers, including Wilson Art, Treefrog, Lab Design, Fermica, Decostone, and more! *Laminate option to be specified with customer service after order is submitted.*

TOP TYPE

# of Doors	No Tapping	Factory Laminated*
2		
4		

LED LIGHT OPTION

Model No.	White LED	Blue LED
ALL MODELS		

FINISHED ENDS (Optional - all models)**End Style**

Match exterior finish - left or right

Match exterior finish - both

SHELVING STYLES (All models - per door)**Shelving Style**

Flat shelving

Wine racks

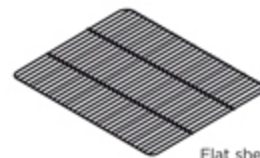

Flat shelf

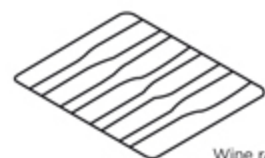

Wine rack

ADDITIONAL ACCESSORIES

Accessory	SDBR48	SDBR96
4" leg and black front baseplate		
4" black end baseplate		
6" leg and black front baseplate		
6" black end baseplate		
Legs 4"- 5-3/4"		(Set of 6)
Legs 6"- 7-1/2"		(Set of 6)
Legs 6"- 9"		(Set of 6)
Clamp-on shelf dividers		
Right line cover		

SECOND YEAR EXTENDED PARTS AND LABOR WARRANTY

Part No.	Description
730	Second year extended parts and labor warranty



BASE MODELS

Choose between all black, all stainless, or factory laminated exterior options. Interior of cabinet is all stainless steel with a galvanized steel back. Includes choice of white or blue LED light, door lock, and is ANSI/NSF#7-certified for open food storage. Comes with 1 year parts and labor warranty on all components other than the refrigeration system.

TWO DOOR (48" Long x 26-11/16" Deep x 34-1/2" High)

Part No.	Net Capacity	Amps	BTU/Hr
SDPR48	14.1 cu. ft.	1.6	1900



SDPR48



CUSTOMER OPTIONS

Each cabinet is configured specifically to the customer's request. The following is pricing on each individual option.

FACTORY INSTALLED THERMOSTAT

Refrigerator Temperature	White Wine Temperature	Red Wine Temperature

EXPANSION VALVES

Choose between three factory installed expansion valves compatible with a range of refrigerant options:

1539	R134A, R401A, R12
4541	R22, R407A, R407C, R407F, R448A, R449
63552	R404A, R507, R507, R402A
No Expansion Valves	Customer to provide per site conditions

EXTERIOR FINISH COLOR (No charge)

Coming Soon

- **ALL BLACK**
Black vinyl top, sides, condensing cover and doors
- **STAINLESS STEEL**
Stainless steel top, sides, condensing cover and doors
- **FACTORY LAMINATED***
Select your favorite option from 13 different laminate manufacturers, including Wilson Art, Treefrong, Lab Design, Fermica, Decostone, and more! **Laminate option to be specified with customer service after order is submitted.**

TOP TYPE

# of Doors	No Tapping	Factory Laminated*
2		

LED LIGHT OPTION

Model No.	White LED	Blue LED
ALL MODELS		

*2 required for Pass-thru cabinets

FINISHED ENDS (Optional - all models)

End Style
Match exterior finish - left or right
Match exterior finish - both

SHELVING STYLES (All models - per door)

Shelving Style
Flat shelving
Wine racks

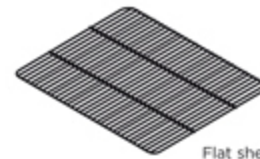

Flat shelf

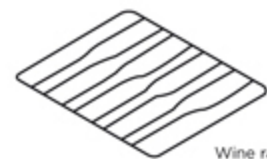

Wine rack

ADDITIONAL ACCESSORIES

Accessory	Part No.
4" legs and stainless steel baseplates (4 sides)	68704P-48
6" legs and stainless steel baseplates (4 sides)	68703P-48
Legs 4"- 5-3/4"	57933
Legs 6"- 7-1/2"	57782
Legs 6"- 9"	67075
Clamp-on shelf dividers	C5090-48BL
Right line cover	68646A-96R



Legs



Clamp-on shelf dividers

SECOND YEAR EXTENDED PARTS AND LABOR WARRANTY

Part No.	Description
730	Second year extended parts and labor warranty

BASE MODELS

Choose between all black, all stainless, or factory laminated exterior options. Interior of cabinet is all stainless steel with a galvanized steel back. Includes choice of white or blue LED light, door lock, and is ANSI/NSF#7-certified for open food storage. Comes with 1 year parts and labor warranty on all components other than the refrigeration system.

FOUR DOOR (48" Long x 26-11/16" Deep x 34-9/16" High)

Part No.	Net Capacity	Amps	BTU/Hr
PTR48	16.6 cu. ft.	1.6	1900

SIX DOOR (72" Long x 26-11/16" Deep x 34-9/16" High)

Part No.	Net Capacity	Amps	BTU/Hr
PTR72	25.7 cu. ft.	2.0	2300



PTR72



PTR48

CUSTOMER OPTIONS

Each cabinet is configured specifically to the customer's request. The following is pricing on each individual option.

EXPANSION VALVES

Choose between three factory installed expansion valves compatible with a range of refrigerant options:

1539	R134A, R401A, R12
4541	R22, R407A, R407C, R407F, R448A, R449
63552	R404A, R507, R507, R402A
No Expansion Valves	Customer to provide per site conditions

FACTORY INSTALLED THERMOSTAT

Refrigerator Temperature	White Wine Temperature	Red Wine Temperature
N/A		

EXTERIOR FINISH COLOR (No charge)**Coming Soon**

- **ALL BLACK**
Black vinyl top, sides, condensing cover and doors, with black PVD coated stainless steel handles
- **STAINLESS STEEL**
Stainless steel top, sides, condensing cover and doors
- **FACTORY LAMINATED***
Select your favorite option from 13 different laminate manufacturers, including Wilson Art, Treefrong, Lab Design, Fermica, Decostone, and more! **Laminate option to be specified with customer service after order is submitted.**

TOP TYPE

# of Doors	No Tapping (Standard)	Tapping Included	Factory Laminated*
2			
3			

DOOR TYPE

Specify the door type beginning from left to right and indicate left or right hinging. For laminated doors, provide your laminate choice by indicating the manufacturer's name and the number and description of the laminate. **Prices listed are for labor to install selected laminate only.**

Finish	Coming Soon
Solid	
Glass	

LED LIGHT OPTION

Model No.	White LED	Blue LED
ALL MODELS		

*2 required for Pass-thru cabinet



DOOR HANDLE OPTIONS (Front and rear - all models)

Handle Type
Full length, stainless steel, 24"
Stainless steel, 12"

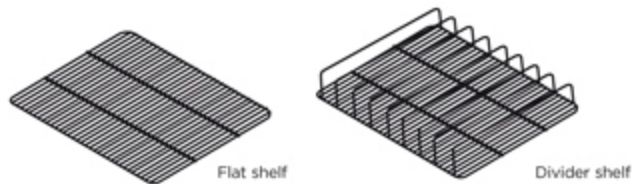

FINISHED ENDS (Optional - all models)

End Style
Match exterior finish - left or right
Match exterior finish - both

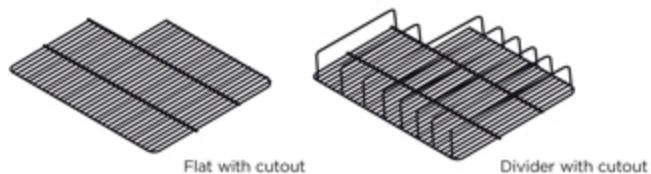

SHELVING STYLES (All models - per door)

Shelving Style
Flat shelving
Wine racks
Divided shelves
Divider with cutout for floor access
Flat with cutout for floor access



SECOND YEAR EXTENDED PARTS AND LABOR WARRANTY

Part No.	Description
730	Second year extended parts and labor warranty



ADDITIONAL ACCESSORIES

Accessory (Part No.)	PTR48	PTR72
4" leg and black baseplate (4 sides)	68704P-48	68704P-72
6" leg and black baseplate (4 sides)	68703P-48	68703P-72
Legs 4"- 5-3/4"	57933	57934
Legs 6"- 7-1/2"	57782	57783
Legs 6"- 9"	67075	67076
Clamp-on shelf dividers	C5090-48BL	C5090-48BL
Floor access (must select cutout shelving listed above)	63054	63054
Right line cover	68646A-48R	68646A-72R

See page 78 for dispensing heads and tapping accessories for back bar cabinets.

BEER DISPENSING KITS

Components included in beer dispensing kits:



- Dispensing head*
- Drainer
- Faucet(s)
- Air distributor - 1 valve per faucet
- Beer line connector - 1 per faucet
- Air hose - 1 per faucet*
- Air distributor cover
- Beer line/drainage cover
- Air scoop and tubing**
- Air sleeve
- Spanner wrench
- Drainer tubing - 8 ft.
- Silicone
- Hardware and fittings

*Note: Keg coupler not included in beer dispensing kits; must order separately. Refer to the Perlick Tapping Price Book or perlick.com.

Part No.	Tower Style/Finish	No. of Faucets
69526-1DA	Draft Arm/Chrome	1
69526-1DATF	Draft Arm/T-F Brass	1
69526-2DA	Draft Arm/Chrome	2
69526-2DATF	Draft Arm/T-F Brass	2
69526-3DA	Draft Arm/Chrome	3
69526-3DATF	Draft Arm/T-F Brass	3
69526-2TT	Tee Tower/SS	2
69526-2TTTF	Tee Tower/T-F Brass	2
69526-3TT	Tee Tower/SS	3
69526-3TTTF	Tee Tower/T-F Brass	3
69526-4TT	Tee Tower/SS	4
69526-4TTTF	Tee Tower/T-F Brass	4
69526-5TT	Tee Tower/SS	5
69526-5TTTF	Tee Tower/T-F Brass	5
69526-6TT	Tee Tower/SS	6
69526-6TTTF	Tee Tower/T-F Brass	6
69526-2N	Napoli/Chrome	2
69526-2NTF	Napoli/T-F Brass	2
69526-1L	Lucky/Chrome	1
69526-1LG	Lucky/Gold	1
69526-2L	Lucky/Chrome	2
69526-2LG	Lucky/Gold	2
69526-3P	Panther/Chrome	3
69526-3PG	Panther/Gold	3
69526-4P	Panther/Chrome	4
69526-4PG	Panther/Gold	4
69526-3HA	Havana/Chrome	3
69526-4HA	Havana/Chrome	4
69526-5HA	Havana/Chrome	5
69526-6HA	Havana/Chrome	6

** Appropriate air scoop provided when kit is ordered with a refrigeration unit. 1 each included with -R field installed kits.

WINE DISPENSING KITS

Components included in wine dispensing kits:



- Dispensing head*
- Drainer
- Faucets*
- Keg coupler* - 1 per faucet
- Air distributor - 1 valve per faucet
- Wine line connector* - 5 ft., 1 per faucet
- Air hose - 1 per faucet
- Air distributor cover
- Wine line/drainage cover
- Air scoop and tubing**
- Air sleeve
- Spanner wrench
- Drainer tubing - 8 ft.
- Silicone
- Hardware and fittings

*Indicates 304 stainless steel component

Part No.	Tower Style/Finish	No. of Faucets
69526W-1DA	Draft Arm/Chrome	1
69526W-2DA	Draft Arm/Chrome	2
69526W-3DA	Draft Arm/Chrome	3
69526W-2TT	Tee Tower/SS	2
69526W-3TT	Tee Tower/SS	3
69526W-4TT	Tee Tower/SS	4
69526W-5TT	Tee Tower/SS	5
69526W-1L	Lucky/Chrome	1
69526W-2L	Lucky/Chrome	2
69526W-3P	Panther/Chrome	3
69526W-4P	Panther/Chrome	4

WINE DISPENSING KITS FOR DZS36 MODEL

Part No.	Tower Style/Finish	No. of Faucets
67945W-1DA	Draft Arm/Chrome	1
67945W-2DA	Draft Arm/Chrome	2
67945W-2TT	Tee Tower/SS	2
67945W-2L	Lucky/Chrome	2

BEER DISPENSING KITS FOR DZS36 MODEL

Part No.	Tower Style/Finish	No. of Faucets
67945-1DA	Draft Arm/Chrome	1
67945-2DA	Draft Arm/Chrome	2
67945-2TT	Tee Tower/SS	2
67945-2L	Lucky/Chrome	2

Note: Cabinets used for dispensing are custom made and cannot be returned for credit.

Part No.	Description
-R (suffix)	Universal Field Installation Kit

Example: 69526-1DA-R



NITROGEN BEVERAGE DISPENSING KITS

Beverages such as coffee, tea, beer, and others can be infused using the **Perlick Nitro Dispensing Kit**. The **Perlick Dual infuser kit** gives you the capability to dispense two nitrogen infused beverages at the same PSI. Kit allows connection to a tower with up to 4 faucets. Pair with Perlick's superior refrigeration for a durable and reliable dispensing system you can trust.

SINGLE NITROGEN INFUSER KIT

Part No.

1030849

DUAL NITROGEN INFUSER KIT

Part No.

1030850

**NITRO DISPENSING KITS**

Components included in the nitro dispensing kits are as follows:

- Nitrogen infuser (single or dual)
- Disconnect, ball-lock, for gas (gray) - 4
- Disconnect, ball-lock, for liquid (black) - 4
- Silicone sealant
- Red gas line - 30 ft.
- Beverage tubing - 5
- 6-way air distributor
- Snorkle tubing - 5 ft.
- Bushing
- Air sleeve
- Twin-gauge nitrogen regulator
- Nitro installation instructions
- Mounting template
- Dispensing tower installation instructions
- Tapping parts bag

**Towers, faucets, and refrigeration sold separately.*



Dual Infuser Kit (103850)
closeup shown



Dual Infuser Kit (103850)
installed in an HC24 unit

DRY STORAGE CABINETS (NON-REFRIGERATED)

BASE MODELS

Choose between all black, all stainless, or factory laminated exterior options. Interior of cabinet is all stainless steel with a galvanized steel back. Includes door lock and three vinyl-coated shelves (*per compartment*).

SINGLE DOOR (24" Long x 24-3/4" Deep x 34-9/16" High)

Part No.	Net Capacity
DB24	7.4 cu. ft.

TWO DOOR (48" Long x 24-3/4" Deep x 34-9/16" High)

Part No.	Net Capacity
DB48	15.3 cu. ft.



DB48

CUSTOMER OPTIONS

Each cabinet is configured specifically to the customer's request. The following is pricing on each individual option.

TOP TYPE

Pricing for laminate reflects labor charge to install selected laminate type; additional charges will apply based on material selection.

# of Doors	No Tapping	Factory Laminated*
1		
2		

EXTERIOR FINISH COLOR (No charge) Coming Soon

- **ALL BLACK**
Black vinyl top, sides, condensing cover and doors, with black PVD coated stainless steel handles
- **STAINLESS STEEL**
Stainless steel top, sides, condensing cover and doors
- **FACTORY LAMINATED***
Select your favorite option from 13 different laminate manufacturers, including Wilson Art, Treefrong, Lab Design, Fermica, Decostone, and more! **Laminate option to be specified with customer service after order is submitted.**

DOOR HANDLE OPTIONS (All models)

Handle Type
Full length, stainless steel, 24"
Stainless steel, 12"

FINISHED ENDS (Optional - all models)

End Style
Match exterior finish - left or right
Match exterior finish - both

DOOR TYPE (All models - per door)

Specify the door type beginning from left to right and indicate left or right hinging. For laminated doors, provide your laminate choice by indicating the manufacturer's name and the number and description of the laminate. **Prices listed are for labor to install selected laminate only.**

Finish	Coming Soon
Solid	
Glass	

SHELVING STYLES (All models - per door)

Shelving Style
Flat shelving
Wine racks
Divided shelves
Full extension wine shelves (Set of 5)

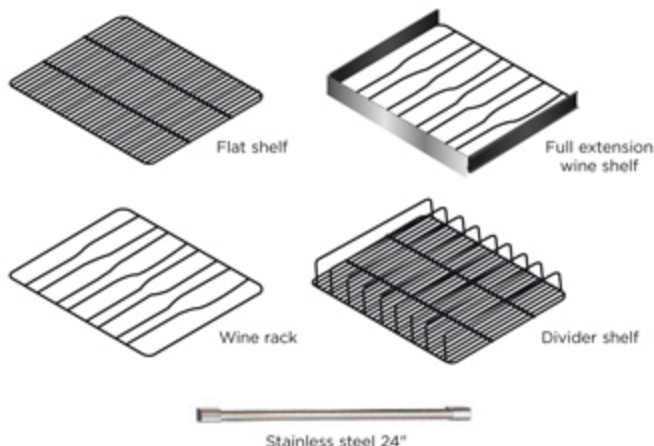

Stainless steel 24"



ADDITIONAL ACCESSORIES

Accessory	DB24	DB48
4" leg and black front baseplate	68704-24	68704-48
4" black end baseplate	68704-22	68704-22
6" leg and black front baseplate	68703-24	68703-48
6" black end baseplate	68703-22	68703-22
Casters 3-3/4"	57786	57786
Casters 2-7/8"	67061	67061
Casters 6-1/8"	57784	57784
Low profile rollers 1-5/8"	63771A	63771A
Legs 4"- 5-3/4"	57933	57933
Legs 6"- 7-1/2"	57782	57782
Legs 6"- 9"	67075	67075
Clamp-on shelf dividers	C5090-48BL	C5090-48BL

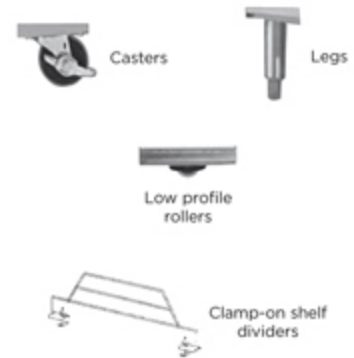

LMD2-24

LIGHTED MERCHANDISE DISPLAYS FOR CUSTOM SERIES CABINETS

All models are constructed of stainless steel with 4" deep acrylic tier inserts for illumination. Each unit has UL listed electrical components and super bright energy saving LED lights for long life (50,000 hours minimum).

The option for the on/off switch and power cord to be located on the left or right allows for adjoining units to create longer displays. The raised 2 tier unit has an illuminated front panel for use with Perlick glass merchandise display units. Select models now available with blue LED lighting.

LIGHTED MERCHANDISE DISPLAYS - 2 TIER (Cool White LED)*

Part No.	Overall Width	Overall Depth	Overall Height	Ship Wt. (lbs.)
LMD2-24 (L or R)	24"	8"	8-1/2"	13
LMD2-36 (L or R)	36"	8"	8-1/2"	20
LMD2-48 (L or R)	48"	8"	8-1/2"	26
LMD2-60 (L or R)	60"	8"	8-1/2"	33
LMD2-72 (L or R)	72"	8"	8-1/2"	40
LMD2-84 (L or R)	84"	8"	8-1/2"	46

LIGHTED MERCHANDISE DISPLAYS - 3 TIER (Cool White LED)*

Part No.	Overall Width	Overall Depth	Overall Height	Ship Wt. (lbs.)
LMD3-24 (L or R)	24"	8"	8-1/2"	13
LMD3-36 (L or R)	36"	8"	8-1/2"	20
LMD3-48 (L or R)	48"	8"	8-1/2"	26
LMD3-60 (L or R)	60"	8"	8-1/2"	33
LMD3-72 (L or R)	72"	8"	8-1/2"	40

* Warm white LED option; call for availability



SOAKY MOUNTAIN WATERPARK, NASHVILLE, TN

NARROW DOOR DRY STORAGE CABINETS (NON-REFRIGERATED)

BASE MODELS

Choose between all black, all stainless, or factory laminated exterior options. Interior of cabinet is all stainless steel with a galvanized steel back. Includes door lock and three vinyl-coated shelves (per compartment).

SINGLE DOOR (20" Long x 24-3/4" Deep x 34-9/16" High)

Part No.	Net Capacity
DBN20	5.0 cu. ft.



DBN20

TWO DOOR (40" Long x 24-3/4" Deep x 34-9/16" High)

Part No.	Net Capacity
DBN40	12.0 cu. ft.



DBN40

CUSTOMER OPTIONS

Each cabinet is configured specifically to the customer's request. The following is pricing on each individual option.

TOP TYPE

Pricing for laminate reflects labor charge to install selected laminate type, additional charges will apply based on material selection.

# of Doors	No Tapping	Factory Laminated*
1		
2		

EXTERIOR FINISH COLOR (No charge) Coming Soon

- **ALL BLACK**
Black vinyl top, sides, condensing cover and doors, with black PVD coated stainless steel handles
- **STAINLESS STEEL**
Stainless steel top, sides, condensing cover and doors
- **FACTORY LAMINATED***
Select your favorite option from 13 different laminate manufacturers, including Wilson Art, Treefrong, Lab Design, Fermica, Decostone, and more! **Laminate option to be specified with customer service after order is submitted.**

DOOR HANDLE OPTIONS (All models)

Handle Type
Full length, SS, 24"
Stainless steel, 12"

FINISHED ENDS (Optional - all models)

End Style
Match exterior finish - left or right
Match exterior finish - both

DOOR TYPE (All models - per door)

Specify the door type beginning from left to right and indicate left or right hinging. For laminated doors, provide your laminate choice by indicating the manufacturer's name and the number and description of the laminate. **Prices listed are for labor to install selected laminate only.**

Finish	Coming Soon
Solid	
Glass	

SHELVING STYLES (All models - per door)

Shelving Style
Flat shelving
Wine racks
Divided shelves

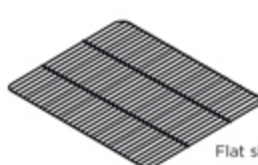

Flat shelf

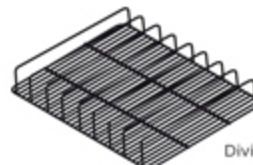

Divider shelf

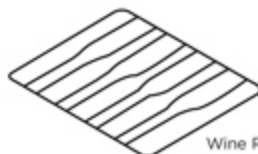

Wine Rack



Stainless Steel 24"



ADDITIONAL ACCESSORIES

Accessory (Part No.)	DBN20	DBN40
4" leg and black front baseplate	68704-20	68704-40
4" black end baseplate	68704-22	68704-22
6" leg and black front baseplate	68703-20	68703-40
6" black end baseplate	68703-22	68703-22
Casters 3-3/4"	57786	57786
Casters 2-7/8"	67061	67061
Casters 6-1/8"	57784	57784
Low profile rollers 1-5/8"	63771A	63771A
Legs 4"- 5-3/4"	57933	57933
Legs 6"- 7-1/2" (set of 4)	57782	57782
Legs 6"- 9"	67075	67075
Clamp-on shelf dividers	C5090-48BL	C5090-48BL

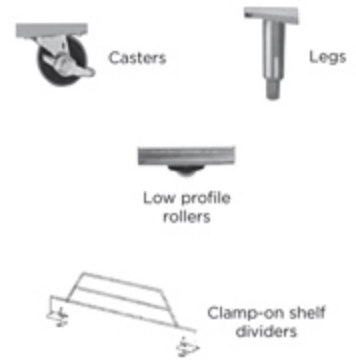

ALLY'S POWERHOUSE CAFE, MILWAUKEE, WI



PIZZA MAN, MILWAUKEE, WI



AMERICAN
BAR SYSTEM
PERLICK DISTRIBUTOR

American Barsystems EK · Phone 0049 (0)231 108 77 99 0 · Fax 0049 (0)231 108 77 99
americanbarsystem@t-online.de · www.americanbarsystem.de · www.perlick.com

BASE MODELS

Choose between all black, or all stainless exterior options. Interior of cabinet is all stainless steel with a galvanized steel back. Door and condensing unit cover options include black vinyl (NC) or stainless steel (see upcharge). Interior and base are galvanized. **Note: Dispensing head not included.**

eco friendly
R290 Hydrocarbon Refrigerant

SINGLE DOOR (36" Long x 24-3/4" Deep x 34-9/16" High)

Part No.	Net Capacity
DDS36	7.4 cu. ft.

TWO DOOR (60" Long x 24-3/4" Deep x 34-9/16" High)

Part No.	Net Capacity
DDS60	16.0 cu. ft.

THREE DOOR (84" Long x 24-3/4" Deep x 34-9/16" High)

Part No.	Net Capacity
DDS84	24.8 cu. ft.

FOUR DOOR (108" Long x 24-3/4" Deep x 34-9/16" High)

Part No.	Net Capacity
DDS108	33.5 cu. ft.

SECOND YEAR EXTENDED PARTS AND LABOR WARRANTY

Part No.	Description
730	Second year extended parts and labor warranty



DDS60 shown with optional 2-faucet draft arm



DDS84 shown with black vinyl doors and optional 1- and 2-faucet draft arm

CUSTOMER OPTIONS

Each cabinet is configured specifically to the customer's request. The following is pricing on each individual option.

ADDITIONAL ACCESSORIES

Part No.	Accessory	Single-Door	2-Door	3-Door	4-Door
57834A	Shelves for 2/3/4 kegs				
67413	2-way secondary regulator kit				
67414	3-way secondary regulator kit				
65494	CO2 regulator kit				
43311	CO2 shut off valve kit				
68704-36	4" leg and black front baseplate				
68704-22	4" black end baseplate				
68703-36	6" leg and black front baseplate				
68703-22	6" black end baseplate				
57793	Set of four 4-5-3/4" legs				
57934	Set of six 4-5-3/4" legs				
57782	Set of four 6"-7-1/2" legs				
57783	Set of six 5-3/4"-7-1/2" legs				
67075	Set of four 6"-9" legs				
67076	Set of six 6"-9" legs				
57784	Set of four 6" casters				
57785	Set of six 6" casters				
57786	Set of four 3-3/4" casters				
57787	Set of six 3-3/4" casters				
67061	Set of four 2-7/8" casters				
67072	Set of six 2-7/8" casters				
63771A	Set of four low profile rollers 1-5/8"				
63771A-2	Set of six low profile rollers 1-5/8"				



Draft Arm



Tee Tower



Napoli



Lucky



Panther



Havana

BEER DISPENSING KITS

Components included in beer dispensing kits are as follows:

- Dispensing head
- Drainer
- Faucet(s)
- Air distributor - 1 valve per faucet
- Beer line connector - 1 per faucet
- Air hose - 1 per faucet
- Air distributor cover
- Beer line/drain cover
- Air scoop and tubing
- Air sleeve
- Spanner wrench
- Drainer tubing - 8 ft.
- Silicone
- Hardware and fittings

Note: Keg coupler not included in beer dispensing kits; must order separately. Refer to the Perlick Tapping Price Book or perlick.com.

Part No.	Tower Style/Finish	No. of Faucets
69526-1DA	Draft Arm/Chrome	1
69526-1DATF	Draft Arm/T-F Brass	1
69526-2DA	Draft Arm/Chrome	2
69526-2DATF	Draft Arm/T-F Brass	2
69526-3DA	Draft Arm/Chrome	3
69526-3DATF	Draft Arm/T-F Brass	3
69526-2TT	Tee Tower/SS	2
69526-2TTTF	Tee Tower/T-F Brass	2
69526-3TT	Tee Tower/SS	3
69526-3TTTF	Tee Tower/T-F Brass	3
69526-4TT	Tee Tower/SS	4
69526-4TTTF	Tee Tower/T-F Brass	4
69526-5TT	Tee Tower/SS	5
69526-5TTTF	Tee Tower/T-F Brass	5
69526-6TT	Tee Tower/SS	6
69526-6TTTF	Tee Tower/T-F Brass	6
69526-2N	Napoli/Chrome	2
69526-2NTF	Napoli/T-F Brass	2
69526-1L	Lucky/Chrome	1
69526-1LG	Lucky/Gold	1
69526-2L	Lucky/Chrome	2
69526-2LG	Lucky/Gold	2
69526-3P	Panther/Chrome	3
69526-3PG	Panther/Gold	3
69526-4P	Panther/Chrome	4
69526-4PG	Panther/Gold	4
69526-3HA	Havana/Chrome	3
69526-4HA	Havana/Chrome	4
69526-5HA	Havana/Chrome	5
69526-6HA	Havana/Chrome	6

Part No.	Description
-R (suffix)	Universal field installation kit

Example: 69526-1DA-R



BASE MODELS

Top, ends, grill, doors, and back exterior are stainless steel. Interior and base are galvanized steel. Full stainless steel drainer. Includes door locks, high-impact bumpers. 6-1/8" casters and side cabinet access panel which conceals CO2 drum (not included), regulator, and liquid waste tank.

Comes with 5 year compressor warranty and 1 year parts and labor warranty.

Note: Dispensing head not included; see below for options.



DDC92
shown with optional 1-faucet
and 2-faucet draft arms

eco friendly
R290 Hydrocarbon
Refrigerant



Draft Arm



Tee Tower

BEER DISPENSING KITS

Components included in beer dispensing kits are as follows:

- Dispensing head
- Drainer
- Faucet(s)
- Air distributor - 1 valve per faucet
- Beer line connector - 1 per faucet
- Air hose - 1 per faucet
- Air distributor cover
- Beer line/drainer cover
- Air scoop and tubing
- Air sleeve
- Spanner wrench
- Drainer tubing - 8 ft.
- Silicone
- Hardware and fittings

Note: Keg coupler not included in beer dispensing kits; must order separately. Refer to the Perlick Tapping Price Book or perlick.com.

TWO DOOR (68" Long x 24-3/4" Deep x 34-9/16" High)

Part No.	Net Capacity
DDC68	16.0 cu. ft.

THREE DOOR (92" Long x 24-3/4" Deep x 34-9/16" High)

Part No.	Net Capacity
DDC92	24.8 cu. ft.

SECOND YEAR EXTENDED PARTS AND LABOR WARRANTY

Part No.	Description
730	Second year extended parts and labor warranty

Note: For 230/50HZ add \$220

ADDITIONAL ACCESSORIES

Part No.	Description
57806A	5# CO2 Gas cylinder
65494	CO2 Regulator kit

Part No.	Tower Style/Finish	No. of Faucets
69526-IDA	Draft Arm/Chrome	1
69526-IDATF	Draft Arm/T-F Brass	1
69526-2DA	Draft Arm/Chrome	2
69526-2DATF	Draft Arm/T-F Brass	2
69526-3DA	Draft Arm/Chrome	3
69526-3DATF	Draft Arm/T-F Brass	3
69526-2TT	Tee Tower/SS	2
69526-2TTTF	Tee Tower/T-F Brass	2
69526-3TT	Tee Tower/SS	3
69526-3TTTF	Tee Tower/T-F Brass	3
69526-4TT	Tee Tower/SS	4
69526-4TTTF	Tee Tower/T-F Brass	4
69526-5TT	Tee Tower/SS	5
69526-5TTTF	Tee Tower/T-F Brass	5
69526-6TT	Tee Tower/SS	6
69526-6TTTF	Tee Tower/T-F Brass	6

The following accessories are available for the Perlick back bar refrigeration. **Note: Legs and caster come in sets of four or six.** Any models over 60" need a set of six legs or casters. For models 60" and less, order a set of four legs or casters. See pages listed below for accessory grids for individual models.

BBS Series.....	pg. 48
DZS60 Series.....	pg. 50
BBSLP Series.....	pg. 52
BBSN Series.....	pg. 54
SDBS Series.....	pg. 56
SDPS Series.....	pg. 57
PTS Series.....	pg. 58
BBR Series.....	pg. 60
BBRLP Series.....	pg. 62
BBRN Series.....	pg. 64
SDBR Series.....	pg. 66
SDPR Series.....	pg. 67
PTR Series.....	pg. 68
DB Series.....	pg. 72
DBN Series.....	pg. 74
DDS Series.....	pg. 77



Casters



Low profile rollers



Legs



Clamp-on shelf dividers

MISC. ACCESSORY

Part No.	Description
1390D	1/2" I.D. anti-microbial vinyl drain tube (per ft.)

SET OF CASTERS (2-7/8")

Part No.	Accessory
67061	Casters 2-7/8" (set of four)
67062	Casters 2-7/8" (set of six)

SET OF CASTERS (3-3/4")

Part No.	Accessory
57786	Casters 3-3/4" (set of four)
57787	Casters 3-3/4" (set of six)

SET OF CASTERS (6-1/8")

Part No.	Accessory
57784	Casters 6-1/8" (set of four)
57785	Casters 6-1/8" (set of six)

SET OF LOW PROFILE ROLLERS (1-5/8")

Part No.	Accessory
63771A	Low profile rollers 1-5/8" (set of four)
63771A-2	Low profile rollers 1-5/8" (set of six)

SET OF ADJUSTABLE LEGS (4"- 5-3/4")

Part No.	Accessory
57933	Legs 4"- 5-3/4" (set of four)
57934	Legs 4"- 5-3/4" (set of six)

SET OF ADJUSTABLE LEGS (6"- 7-1/2")

Part No.	Accessory
57782	Legs 6"- 7-1/2" (set of four)
57783	Legs 6"- 7-1/2" (set of six)

SET OF ADJUSTABLE LEGS (6"- 9")

Part No.	Accessory
67075	Legs 6"- 9" (set of four)
67076	Legs 6"- 9" (set of six)

SET OF ANTI-TIP CASTERS (3-3/4")

Part No.	Accessory
57786AT	Anti-tip casters 3-3/4"

SET OF ANTI-TIP CASTERS (6-1/4")

Part No.	Accessory
57784AT	Anti-tip casters 6-1/4"

CLAMP-ON SHELF DIVIDERS

Part No.	Accessory
C5090-48BL	Clamp-on shelf dividers



Column Wine Reserves are available in single or dual zone models. All units feature a panel-ready glass door, ready to accept custom cabinetry panels to blend into any design. Stainless steel door panels with handles installed are available (order separately). All models feature full extension wine shelves, with one convertible display shelf, triple pane, Low-E, bronze tinted glass, and eco-friendly R600A refrigerant. Optional stainless steel finish panels available for factory install only.

HIGH-CAPACITY, SMALL FOOTPRINT

Don't let limited square footage limit your wine list. By expanding up, you'll have plenty of space to create an impressive offering of fine vintages. Perlick's space efficient, climate controlled column refrigeration for wine takes advantage of available vertical space.

- 84" tall - 24" x 24" footprint provides high-capacity wine storage in a compact space
- Factory set sensor maintains optimum humidity level
- Programmable blue and white LED interior lighting with slow fade effect for on and off setting

SINGLE ZONE (23-3/4" WIDE, 24-1/16" DEEP, 84" HIGH)

Part No.	Description	Net Capacity	Amps
CC24W	Commercial wine column, single zone, glass door panel ready	12.6 cu. ft.	2.6

Wine Column Refrigerator, single zone, full extension wine shelves, one convertible display shelf, temperature range 40°F-68°F

DUAL ZONE (23-3/4" WIDE, 24-1/16" DEEP, 84" HIGH)

Part No.	Description	Net Capacity	Amps
CC24D	Commercial wine column, dual zone, glass door panel ready	12.2 cu. ft.	2.6

Wine Column Refrigerator, dual zone, full extension wine shelves, one convertible display shelf, temperature range 40°F-68°F

Part No.	Description
CR-SG-24PDL4L	Left hinged stainless steel glass door overlay, with 2-tone handle, lock, 4" toe kick
CR-SG-24PDR4L	Right hinged stainless steel glass door overlay, with 2-tone handle, lock, 4" toe kick
CR-SG-24PDL6L	Left hinged stainless steel glass door overlay, with 2-tone handle, lock, 6" toe kick
CR-SG-24PDR6L	Right hinged stainless steel glass door overlay, with 2-tone handle, lock, 6" toe kick
CFG-COL_COM_LPANEL-SS	Stainless steel finish side panel - left side
CFG-COL_COM_LPANEL-SS	Stainless steel finish side panel - right side
CR-PRO-HANDLE	Door handle kit - order separately only if needed for customer provided overlay (i.e. custom mill work)



CC24W-1-4R
shown with stainless steel door
overlay and door handle



eco friendly
R600a Refrigerant



Heavy-duty, full extension,
soft closing wine shelves



PerliQ state-of-the-art digital
touch screen

Compact storage for crucial service needs. Perlick under counter refrigeration is made with all stainless steel interior top and sides with a galvanized steel back and base. Commercial grade full extension shelving for easy loading and product access and more.

eco friendly
R600a Refrigerant

SINGLE DOOR (24" LONG X 24" DEEP X 34" HIGH)

Part No.	Description	Shelving Footnote	Tapping Options	Capacity Cubic Ft.	Temp. Range	HP	Amps	Ship Wt. (lbs.)
HC24RS4	Refrigerator	[1]	[8] [9] [10]	5.3	+33°F to +42°F	1/6	1.6	185
HC24FS4	Chiller	[2]	N/A	5.3	-10°F to +10°F	1/6	2.4	195
HC24WS4	Wine reserve	[3]	N/A	5.3	+40°F to +68°F	1/6	1.6	205



HC24RS4

TWO DOOR (48" LONG X 24" DEEP X 34" HIGH)

Part No.	Description	Shelving Footnote	Tapping Options	Capacity Cubic Ft.	Temp. Range	HP	Amps	Ship Wt. (lbs.)
HC48RS4	Refrigerator	[4]	[11] [12] [13]	11.7	+32°F to +42°F	1/6	1.6	335
HC48WS4	Wine reserve	[5]	N/A	11.7	+40°F to +68 °F	1/6	1.6	375

[4] Cabinet furnished with (2) black vinyl coated full extension shelves (adjustable) and black vinyl coated floor rack in compartment 1, and six (6) black vinyl coated full extension wine shelves (adjustable) in compartment 2. Each wine shelf holds (8) 750ml wine bottles.



HC24WS4
(with optional glass door)

TWO DOOR DUAL ZONE (48" LONG X 24" DEEP X 34" HIGH)

Part No.	Description	Shelving Footnote	Capacity Cubic Ft.	Temp. Range	HP	Amps	Ship Wt. (lbs.)
HC48RW4	Refrigerator Wine	[6]	11.1	+32°F to +42°F +40°F to +68°F	1/6	1.6	355
HC48WW4	White wine Red wine	[7]	11.1	+45°F Set Point +60°F Set Point	1/6	1.6	385

[6] Cabinet furnished with (2) black vinyl coated full extension shelves (adjustable) and black vinyl coated floor rack in compartment 1, and (6) black vinyl coated full extension wine shelves (adjustable) in compartment 2. Each wine shelf holds (8) 750ml wine bottles.

[7] Cabinet furnished with (4) black vinyl coated full extension shelves (adjustable) and black vinyl coated floor rack in compartment 1, and (6) black vinyl coated full extension wine shelves (adjustable) in compartment 2. Each wine shelf holds (8) 750ml wine bottles.

SECOND YEAR EXTENDED PARTS AND LABOR WARRANTY

Part No.	Description
730	Second year extended parts and labor warranty

OPTIONAL HC24 SERIES TAPPING OPTIONS

Part No.	Description
[8]	- Drilled for tapping, tower sold separately
[9]	66585C-1 Single faucet draft arm tapping kit
[10]	66585C-2 Dual faucet draft arm tapping kit



HC48WW4

OPTIONAL HC48 SERIES TAPPING OPTIONS

Choose an option for one or two doors

Part No.	Description
[11]	- Drilled for tapping, tower sold separately
[12]	66585C-1 Single faucet draft arm tapping kit
[13]	66585C-2 Dual faucet draft arm tapping kit

HC24 SERIES SHELVING OPTIONS

Description
[1] Refrigerator shelving - (2) full extension flat shelves and floor rack
[2] Beverage center shelving - (2) full extension wine shelves and floor rack
[3] Wine reserve shelving - (5) full extension wine racks



EMPOWER FIELD AT MILE HIGH, DENVER, CO



American Barsystems EK · Phone 0049 (0)231 108 77 99 0 · Fax 0049 (0)231 108 77 99
americanbarsystem@t-online.de · www.americanbarsystem.de · www.perlick.com

DOOR FINISH*

Specify the door style by listing the part number and description for the door. Also indicate right or left hinging for the door.

Part No.	Description
B	B - Solid black/field laminate
CFG-RES_DOOR-S	S - Solid stainless steel
CFG-RES_DOOR-G	G - Glass with black vinyl/field laminate
CFG-RES_DOOR-T	T - Glass with stainless steel

Note: Glass doors are not recommended for use with chillers as excessive condensation can occur in high humidity environments.

** Doors can be finished with wood overlay panels (by others). Contact Perlick for templates.*

DOOR HANDLES AND OPTIONAL LOCKS

Description
Handles, full length, two tone with chrome end caps and stainless steel grip
Tab handles, top mount, stainless steel
Door lock, chrome
Lock bracket accessory for wood overlay

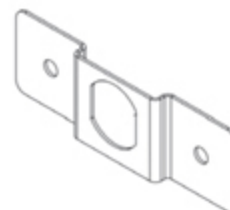

Lock bracket accessory for wood overlay

ACCESSORIES for Single Door (HC24), Field Installed

Part No.	Description
66734	Leg kit, adjustable 4" to 6", set of four with mounting platform
66735	Leg kit, adjustable 6" to 7-1/4", set of four with mounting platform
66736	Casters - 3-3/4", set of four with mounting platform
RS-SK-24R/L	Stacking Kit for HC24 & HB24 Units

ACCESSORIES for Two Door (HC48), Field Installed

Part No.	Description
70209	Leg kit, adjustable 4" to 6", set of four with mounting platform
70210	Leg kit, adjustable 6" to 7-1/4", set of four with mounting platform
70211	Casters - 3-3/4", set of four with mounting platform



UBS ARENA, ELMONT, NY



THE PERFECT PARTNER FOR SUITES & STADIUMS

Refrigeration **designed for quality.**
Beverage dispensing solutions **built to perform.**

- Full extension, smooth glide shelving for faster, more ergonomic product access
- All stainless steel interior ensures consistent cabinet temperature and a hygienic, easy-to-clean environment

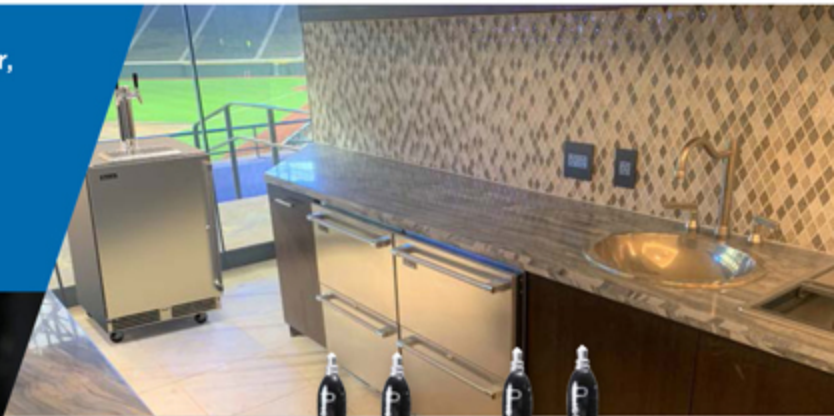

- Premium beverage dispensing products are durable and well insulated to pour the perfect beer



- Perlick's energy efficient smart compressor ramps up as additional cooling is needed, maximizing energy savings while decreasing pull down time



American Barsystems EK · Phone 0049 (0)231 108 77 99 0 · Fax 0049 (0)231 108 77 99
americanbarsystem@t-online.de · www.americanbarsystem.de · www.perlick.com

All models are ADA height compliant. Top, ends, and interior are stainless steel; back and base are galvanized steel. Includes full extension shelves and LED display lighting. Comes with 5 year compressor warranty and 1 year parts and labor warranty.

Part No.	Description	Capacity Cubic Ft.	Temp. Range	HP	Amps	Ship Wt. (lbs.)
HD24RS4	Refrigerator	3.8	+33°F to +42°F	1/6	1.6	175
HD24WS4	Wine reserve	3.8	+40°F to +68°F	1/6	1.6	185

HD24 SERIES SHELVING OPTIONS

Description

- (2) Full extension flat shelves and floor rack
- (4) Full extension wine shelves

SECOND YEAR EXTENDED PARTS AND LABOR WARRANTY

Part No.	Description
730	Second year extended parts and labor warranty

DOOR FINISH*

Specify the door style by listing the part number and description for the door. Also indicate right or left hinging for the door.

Part No.	Description
B	B - Solid black
CFG-RES_DOOR-S	S - Solid stainless steel
CFG-RES_DOOR-G	G - Glass with black vinyl/field laminate
CFG-RES_DOOR-T	T - Glass with stainless steel

* Cabinets can be finished with wood overlay doors (by others). Contact Perlick for templates.

DOOR HANDLES AND OPTIONAL LOCKS

Description

- Handles, full length, two tone
- Classic handles, 6", chrome with black grip
- Tab handles, top mount, stainless steel
- Door lock
- Lock bracket accessory for wood overlay



HD24RS



HD24WS
(with optional glass door)



GAINBRIDGE FIELDHOUSE, INDIANAPOLIS, IN

24" ADA HEIGHT-COMPLIANT UNDERCOUNTER REFRIGERATION

(24" LONG X 24" DEEP X 32" HIGH)

- Top and ends are stainless steel; galvanized back
- All stainless steel interior
- Includes front vented refrigeration system
- Refrigerators and freezers include two vinyl coated full extension adjustable shelves
- Beverage centers include two wine shelves and one full extension pull out shelf
- Wine reserves are offered with (4) full extension wine shelves which store 32 bottles of wine. Wine shelves can be replaced with refrigerator shelves for upright storage.
- Freezers equipped with automatic hot gas defrost and digital controller
- All models come with 1 year parts and labor and 5 year compressor warranty

Part No.	Description	Capacity Cubic Ft.	Temp. Range	HP	Amps	Ship Wt. (lbs.)
HB24RS	ADA Refrigerator	4.8	33°F to 42°F	1/6	1.6	180
HB24FS	ADA Freezer	4.8	-10°F to 10°F	1/6	2.4	190
HB24BS	ADA Beverage center	4.8	40°F to 68°F	1/6	1.6	185
HB24WS	ADA Wine reserve	4.8	40°F to 68°F	1/6	1.6	200

HB24 SERIES SHELVING OPTIONS

Description

Refrigerator shelving - (2) full extension flat shelves and floor rack

Wine reserve shelving - (4) full extension wine shelves

SECOND YEAR EXTENDED PARTS AND LABOR WARRANTY

Part No.	Description
730	Second year extended parts and labor warranty

DOOR FINISH

Specify the door style by listing the description for the door and indicate left or right hinging.

Part No.	Description
B	B - Solid black
CFG-RES_DOOR-S	S - Solid stainless steel
CFG-RES_DOOR-G	G - Glass with black vinyl/field laminate
CFG-RES_DOOR-T	T - Glass with stainless steel

Note: Glass doors are not recommended for use with freezers as excessive condensation can occur.

REFRIGERATOR OR FREEZER DRAWER FINISH

Specify the drawer style by listing the description.

Part No.	Description
CFG-RES_DOOR-Z	Solid black vinyl/field laminate
CFG-RES_DOOR-D	Solid stainless steel

Note: Drawers come standard with stainless steel full length handles.

DOOR HANDLES AND OPTIONAL LOCKS

Part No.	Description
CFG-RES_COMHINGE-LOCK	Door lock, chrome
67014-1	Lock bracket accessory for wood overlay

ACCESSORIES, FIELD INSTALLED

Part No.	Description
66734	Leg kit, adjustable 4" to 6", set of four with mounting platform
66735	Leg kit, adjustable 6" to 7-1/4", set of four with mounting platform
66736	Casters: 3-3/4", set of four with mounting platform
RS-SK-18R/L	Stacking kit for HH24 units



HB24RS



HB24FS



HB24WS



HB24BS



HB24FS (with optional drawers)



WARNING: California Prop 65 Notice
See page 6 for details.



American Barsystems EK · Phone 0049 (0)231 108 77 99 0 · Fax 0049 (0)231 108 77 99
americanbarsystem@t-online.de · www.americanbarsystem.de · www.perlick.com



FR48



FR24

Chill glassware, beer mugs, flatware, and more.

Designed to fit under the front bar, where needed during service. Perlick chillers all come with stainless steel interiors, tops, and doors. Then choose from shelving and mounting options to fit your chiller to your space.

eco friendly
R290 Hydrocarbon
Refrigerant

2 FOOT MODELS

Part No.	Description	Ship Weight
FR24RT-3	Base 24" - 1/3 H.P. compressor, 5.8 amps	190 lbs.

Exterior Finish

Description
Stainless front and sides
All stainless steel

3 FOOT MODELS

Part No.	Description	Ship Weight
FR36RT-3	Base 36" - 1/3 H.P. compressor, 6.8 amps	245 lbs.

Exterior Finish

Description
Stainless steel front and sides
All stainless steel

4 FOOT MODELS

Part No.	Description	Ship Weight
FR48RT-3	Base 48" - 1/3 H.P. compressor, 6.2 amps	265 lbs.

Exterior Finish

Description
Stainless front and sides
All stainless steel

5 FOOT MODELS

Part No.	Description	Ship Weight
FR60RT-3	Base 60" - 1/3 H.P. compressor, 7.1 amps	300 lbs.

Exterior Finish

Description
Stainless front and sides
All stainless steel

ACCESSORIES**Second Year Extended Parts and Labor Warranty**

Part No.	Description
730	Second year extended parts and labor warranty

Two Levels of Nesting Shelves with Supporting Brackets

Description	Glass Capacity
For 2' models	90
For 3' models	142
For 4' models	214
For 5' models	286

Additional Level of Nesting Shelves with Brackets

Description	Glass Capacity
For 3' models	30
For 4' models	59
For 5' models	77

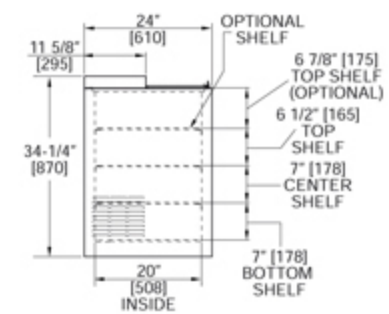
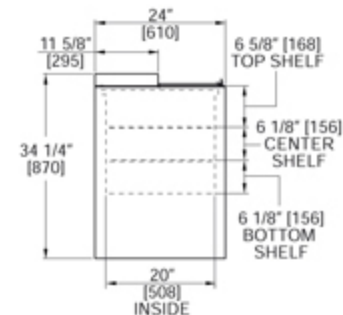
**Roller Basket Shelving (3 baskets)**

Description	No. of Baskets
For 4' and 5' models	3

Additional Roller Baskets

Description
For 4' and 5' models

Legs and Casters/Roller Kits

Description
Set of four adjustable legs (4"-5-3/4")
Set of four adjustable legs (6"-7-1/2")
Set of four adjustable legs (6"-9")
Set of four casters (2-7/8")
Set of four casters (3-3/4")
Set of four casters (6-1/8")
Set of four rollers (1-5/8")

Bottle coolers offer a perfect solution for storing high volume bottled or canned beverages.

Designed to fit under the front bar to allow staff to access high volume contents without having to leave the front bar area. Perlick bottle coolers are made with all stainless steel interiors, tops, and doors. Then choose from shelving and mounting options to fit your bottle cooler to your space.

eco friendly
R290 Hydrocarbon
Refrigerant

24" MODELS

Part No.	Description	Capacity (bottles)	HP	Amps	Ship Wt. (lbs.)
BC24RT-3	Base 24" refrigerator temperature, 34-40°F	6 cases	1/5	3.2	190
BC24WT-3	Base 24" wine temperature, 45-60°F	6 cases	1/5	3.2	190
BC24LT-3	Base 24" low temperature, 28-34°F	6 cases	1/5	3.2	190

Exterior Finish

Description

Black

Stainless steel front and sides

All stainless steel

36" MODELS

Part No.	Description	Capacity (bottles)	HP	Amps	Ship Wt. (lbs.)
BC36RT-3	Base 36" refrigerator temperature, 34-40°F	10 cases	1/5	3.0	245
BC36WT-3	Base 36" wine temperature, 45-60°F	10 cases	1/5	3.0	245
BC36LT-3	Base 36" low temperature, 28-34°F	10 cases	1/5	3.0	245

Exterior Finish

Description

Black

Stainless steel front and sides

All stainless steel

48" MODELS

Part No.	Description	Capacity (bottles)	HP	Amps	Ship Wt. (lbs.)
BC48RT-3	Base 48" refrigerator temperature, 34-40°F	17 cases	1/4	5.2	300
BC48WT-3	Base 48" wine temperature, 45-60°F	17 cases	1/4	5.2	300
BC48LT-3	Base 48" low temperature, 28-34°F	17 cases	1/4	5.2	300

Exterior Finish

Description

Black

Stainless steel front and sides

All stainless steel

60" MODELS

Part No.	Description	Capacity (bottles)	HP	Amps	Ship Wt. (lbs.)	List Price
BC60RT-3	Base 60" refrigerator temperature, 34-40°F	21 cases	1/3	7.0	353	
BC60WT-3	Base 60" wine temperature, 45-60°F	21 cases	1/3	7.0	353	
BC60LT-3	Base 60" low temperature, 28-34°F	21 cases	1/3	7.0	353	

Exterior Finish

Description

Black

Stainless steel front and sides

All stainless steel



BC24 Stainless
(with optional opener,
receiver, and casters)



Choose base cabinet and indicate exterior finish. All cabinets come with stainless steel interior, door(s), and condensing unit cover. Then choose from accessory options and add their price to price of base cabinet.



Shown with optional opener, cap receiver, and casters

BC72 Stainless

eco friendly
R290 Hydrocarbon
Refrigerant

72" MODELS

Part No.	Description	Capacity (bottles)	HP	Amps	Ship Wt. (lbs.)
BC72RT-3	Base 72" refrigerator temperature, 34-40°F	28 cases	1/3	6.9	405
BC72WT-3	Base 72" wine temperature, 45-60°F	28 cases	1/3	6.9	405
BC72LT-3	Base 72" low temperature, 28-34°F	28 cases	1/3	6.9	405

Exterior Finish

Description
Black
Stainless steel front and sides
All stainless steel

96" MODELS -

Part No.	Description	Capacity (bottles)	HP	Amps	Ship Wt (lbs.)
BC96RT-3	Base 96" refrigerator temperature, 34-40°F	41 cases	1/3	7.6	515
BC96WT-3	Base 96" wine temperature, 45-60°F	41 cases	1/3	7.6	515
BC96LT-3	Base 96" low temperature, 28-34°F	41 cases	1/3	7.6	515

Exterior Finish

Description
Black
Stainless steel front and sides
All stainless steel

SECOND YEAR EXTENDED PARTS AND LABOR WARRANTY

Part No.	Description
730	Second year extended parts and labor warranty



ACCESSORIES FOR ALL FLAT TOP BOTTLE COOLERS

Description	BC24 thru BC96
Cap receiver (left)	
Cap receiver (right)	
Optional floor racks	

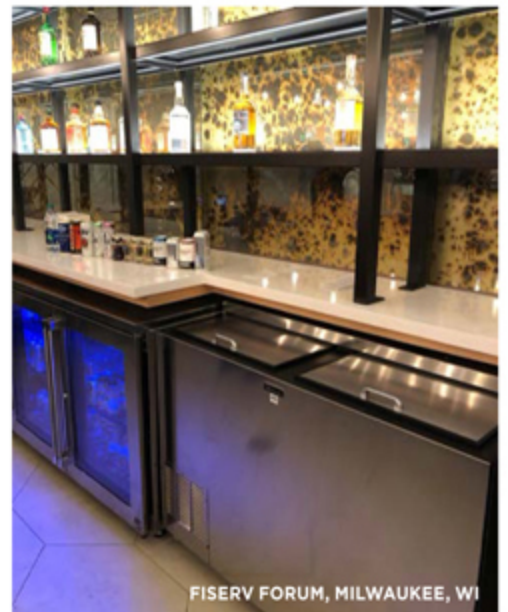

FISERV FORUM, MILWAUKEE, WI

ACCESSORIES FOR BOTTLE COOLERS

Bin Dividers with Support Brackets

Description	No. of Dividers
For 2' models	1
For 3' models	2
For 4' models	2
For 5' models	3
For 6' models	4
For 8' models	6

Additional Bin Dividers

Description
For 2' models
For 3' to 8' models

Two Levels of Nesting Shelves with Brackets

Description	Glass Capacity
For 2' models	90
For 3' models	142
For 4' models	214
For 5' models	286
For 6' models	343
For 8' models	456

Additional Levels of Nesting Shelves

Description
For 2' models
For 3' models
For 4' models
For 5' models
For 6' models
For 8' models

Optional Floor Racks

Description
For 2' models
For 3' models
For 4' models
For 5' models
For 6' models
For 8' models

Roller Baskets for One Level

Description	No. of Baskets
For 4' models	3
For 5' models	3
For 6' models	6
For 8' models	6

Additional Roller Basket

Description
For 4' - 8' models

Second Year Extended Parts and Labor Warranty

Part No.	Description
730	Second year extended parts and labor warranty

4" Adjustable Legs

Part No.	Description
57933	For 2', 3', 4' and 5' models
57934	For 6' and 8' models

6" Adjustable Legs

Part No.	Description
57782	For 2', 3', 4' and 5' models
57783	For 6' and 8' models

6-9" Adjustable Legs

Part No.	Description
67075	For 2', 3', 4' and 5' models
67076	For 6' and 8' models

2-7/8" Casters

Part No.	Description
67061	For 2', 3', 4' and 5' models
67062	For 6' and 8' models

3-3/4" Casters

Part No.	Description
57786	For 2', 3', 4' and 5' models
57787	For 6' and 8' models

6-1/8" Casters

Part No.	Description
57784	For 2', 3', 4' and 5' models
57785	For 6' and 8' models

1-7/8" Rollers

Part No.	Description
63771A	For 2', 3', 4' and 5' models
63771A-2	For 6' and 8' models

Full Length Speed Rail

Part No.	Description
SR-S24AR	For 24" models
SR-S30AR	For 30" models
SR-S36AR	For 36" models
SR-S42AR	For 42" models
SR-S48AR	For 48" models
SR-S60AR	For 60" models
SR-S72AR	For 72" models

Bottle Opener and Receiver

Part No.	Description
63981	Factory installed, left or right



GLASSWASHERS

There are five types of glasswashers to choose from. Each comes with 1 year parts and labor warranty.

BATCH ROTARY MODELS

Part No.	Width Location	Chemical Panel	Ship Wt. (lbs.)
PKBR24	24"	Right	225

Note: Includes plumber's hook-up kit (55021) consisting of 1/2" water hammer arrestor and 1/2" NPTT shut-off valve.

ACCESSORIES (BATCH ROTARY ONLY)

Part No.	Description
50470-2	Glass rack for 24" glasswasher
61945	Kit, low sanitizer shutdown

CAROUSEL MODEL

Part No.	Width	Volts	Ship Wt. (lbs.)
PKC24	25-1/4"	115V	156

DOOR STYLE

Part No.	Width	Volts	Ship Wt. (lbs.)
PKD24A	24"	230V	244

DOOR STYLE (W/O HEATER)

Part No.	Width	Volts	Ship Wt. (lbs.)
PKD24B	24"	115V	190

DOOR STYLE (HIGH TEMPERATURE)

Part No.	Width	Volts	Ship Wt. (lbs.)
PKHT24	24"	208V	234

SECOND YEAR EXTENDED PARTS AND LABOR WARRANTY

Part No.	Description
730G	Second year extended parts and labor warranty

Note: 730G Warranty applies to glass washers only.



PKBR24



PKC24



PKD24A



PKD24B



PKHT24



WARNING: California Prop 65 Notice
See page 6 for details.

CENTURY SYSTEM

When dispensed properly, draft beer will generate huge profits for the operator. Perlick knows more about profitable draft beer dispensing than anyone else in the industry because we pay attention to detail. That's why it pays to choose a Century Beer System. Century has been the choice of smart operators for more than 35 years.

The right pressure source, a properly-sized glycol chiller, and Century's unique trunk housing and dispensing heads combine to ensure that the Perlick Century Beer System will outperform any other long-draw beer system on the market today.

We're so sure you'll appreciate the difference that we guarantee your complete satisfaction. It's a guarantee you can count on, backed by Perlick's decades as the brewing industry leader.

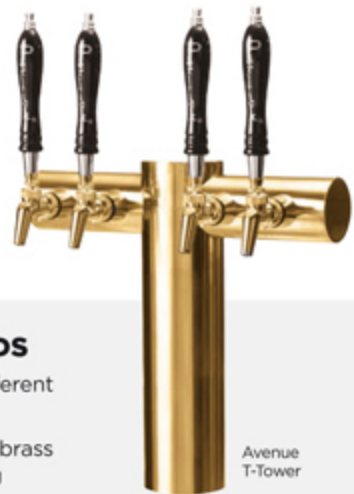

Avenue
T-Tower

DISPENSING HEADS

- Available in many different styles and finishes
- Tarnish-free polished brass never needs polishing
- From one to multiple faucets
- Factory-balanced restrictors control flow to guarantee solid beer
- Copper coolant lines and metal cold block maintain chilled beverage temperatures right to the faucet
- Insulated with polyurethane foam
- Optional shanks and faucets available

Please reference the Perlick Century System catalog for the full product offering.



GOOD CITY BREWING, MILWAUKEE, WI



American Barsystems EK · Phone 0049 (0)231 108 77 99 0 · Fax 0049 (0)231 108 77 99
americanbarsystem@t-online.de · www.americanbarsystem.de · www.perlick.com